

Turtle Rock ES Modernization Public Information Meeting

July 16, 2019



MEETING AGENDA

- Introductions
- Overview of Measure E Program
- Project Overview
- Resources
- Questions and Answers



INTRODUCTIONS

- Kelvin Okino – IUSD Executive Director, Facilities Planning and Construction
- Christa DeBoer – IUSD Supervisor, Facilities/Construction

Additional Team Members:

- Jeremy Stonebarger – IUSD, Principal of Turtle Rock ES
- Annie Brown – IUSD, Public Information Officer
- Joe Kelly – Sprotte Watson Architect



Overview of Measure E Program



HISTORY OF MEASURE E

- **Comprehensive plan created in 2012**
- **Refined in 2015 with current cost estimates**
 - Districtwide improvement needs over **\$800.0** million
 - Districtwide needs include:
 - facilities improvements
 - enrollment growth
 - site upgrades
 - upgrades to non-school site facilities
- **Determined the need for a General Obligation Bond**



SFID BOND MEASURE

- **Schools Facility Improvement District (SFID)**
 - Carved out newer schools under a Mitigation Agreement (Mello-Roos)
 - Focused on 28 schools of the 38 schools
- **June 7, 2016 Ballot**
 - \$319.0 million Bond Measure (Measure E)
 - \$29 / \$100,000 assessed value tax increase
 - Four bond series sales
 - Proposition 39 (School Facilities Local Vote Act of 2000)
 - Passed at 60.2% (55% required)



MEASURE E PROJECTS

 - High Schools

 - Middle Schools

 - Elementary Schools

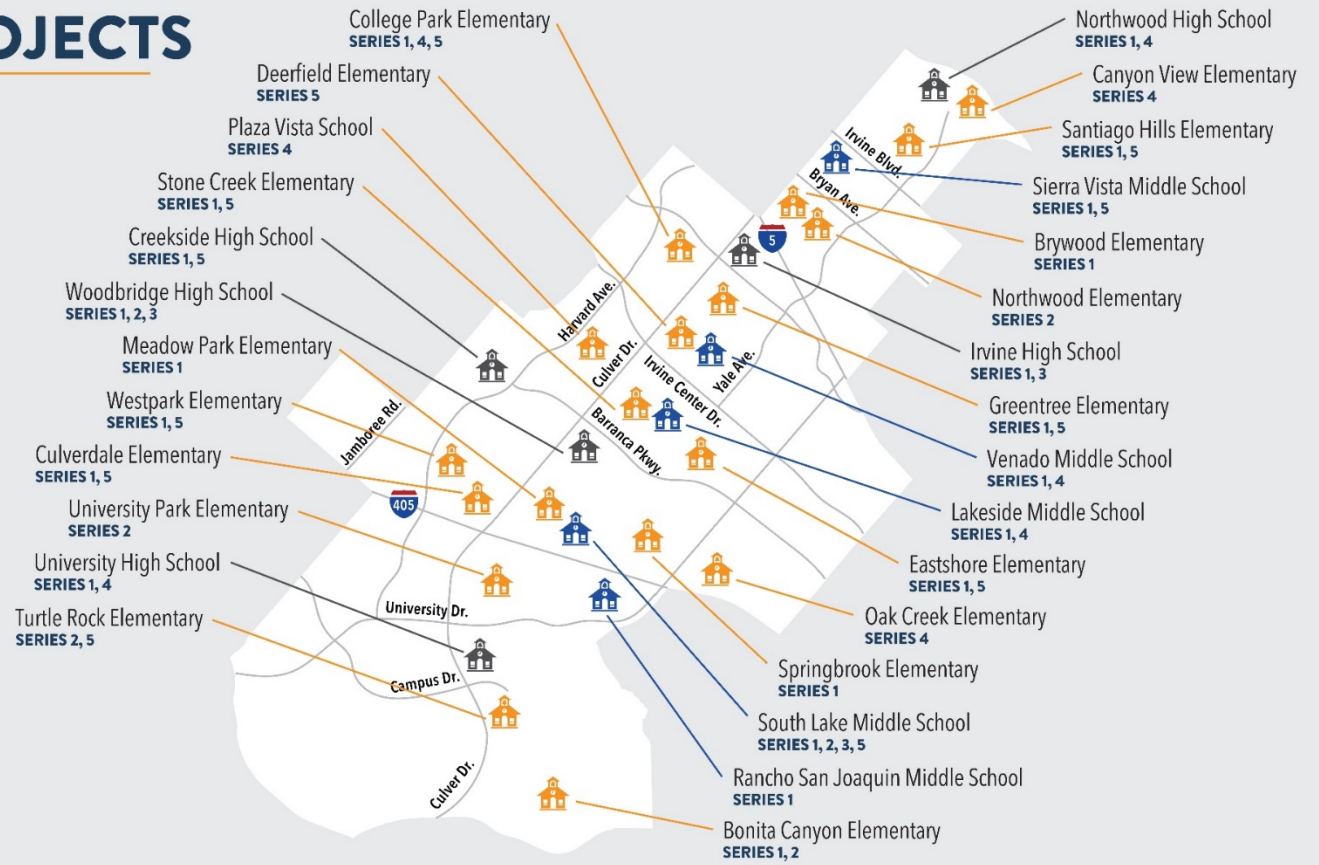
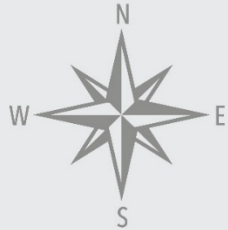

SERIES 1
2016
21 schools

SERIES 2
2018
6 schools
(3 repeats)

SERIES 3
2021
1 school
(1 repeat)

SERIES 4
2024
8 schools
(5 repeats)

SERIES 5
2028
12 schools
(11 repeats)

FOR MORE INFORMATION:



[IUSD.org/MeasureE](https://www.iusd.org/MeasureE)



(949) 936-5000

SERIES 1 - PROJECT COMPLETION DATE

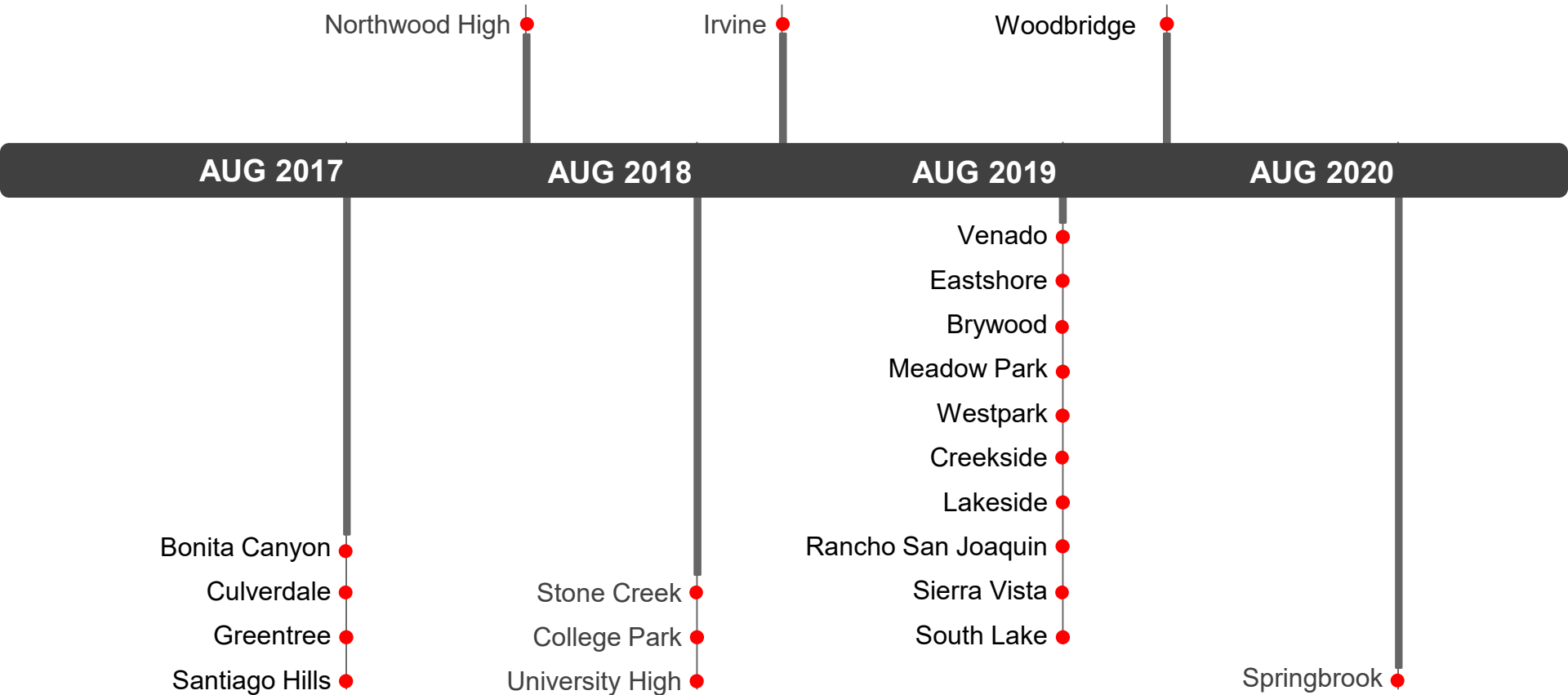

SERIES 2 PRIORITIES

- **Safety and security**
 - Install interior doors at elementary school classrooms
- **Age of the school site**
 - Modernize eligible schools over 25 years old
- **Projects that will impact the greatest amount of students**
 - Projects for high schools and middle schools, which benefit most Irvine USD students, who will attend these schools
- **Upgrade Science Labs at middle schools**



DESIGN & CONSTRUCTION PROCESS

ACRONYMS

RFP
Request for Proposal

A/E
Architect / Engineer

CDE
California Department of Education

DSA
Division of State Architect

OPSC
Office of Public School Construction



STAKEHOLDERS

INTERNAL REVIEWS

- Ed. Specs./Technical Specs.
- Maintenance and Operations
- IT: network, data, AV
- Security
- Ed. Services
- Milestone Meetings (Architect & Construction Manager)
- Schools Facilities Improvement Measure Committee
- Citizens Oversight Committee
- Board of Education Study Sessions

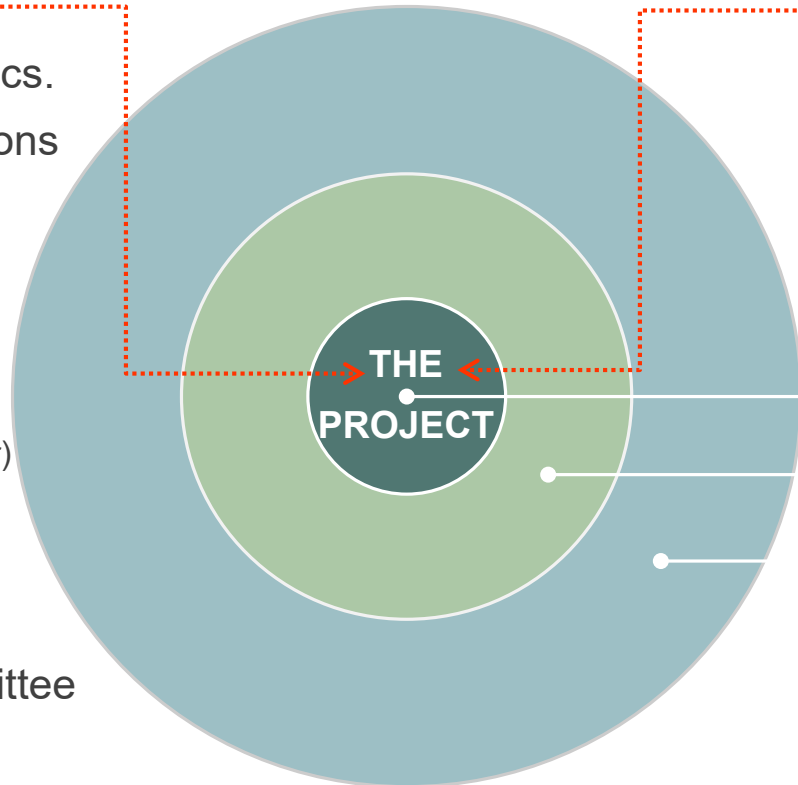

AGENCY APPROVALS

- California Dept. of Ed.
- Div. of State Architect
- Fire Authority
- State Funding

Planning Committee

Staff Logistics/Impacts

Community Outreach

- Parents /Students
- H.O.A
- Neighbors
- City of Irvine



Project Overview



PROJECT SCOPE

- Construct a new building to include three classrooms with instrument storage and two staff restrooms
- Removal of one portable
- Furniture allocation
- Site work associated with the new building



SITE PLAN FOR PROPOSED LOCATION



SITE PLAN FOR PROPOSED LOCATION – ANIMATION



MUSIC BUILDING – FRONT OF BUILDING EXTERIOR RENDERING



MUSIC BUILDING – BUILDING ELEVATIONS



MUSIC BUILDING – PERSPECTIVE FROM TRAIL (EXISTING)



MUSIC BUILDING – PERSPECTIVE FROM TRAIL (NEW)



FLOOR PLAN

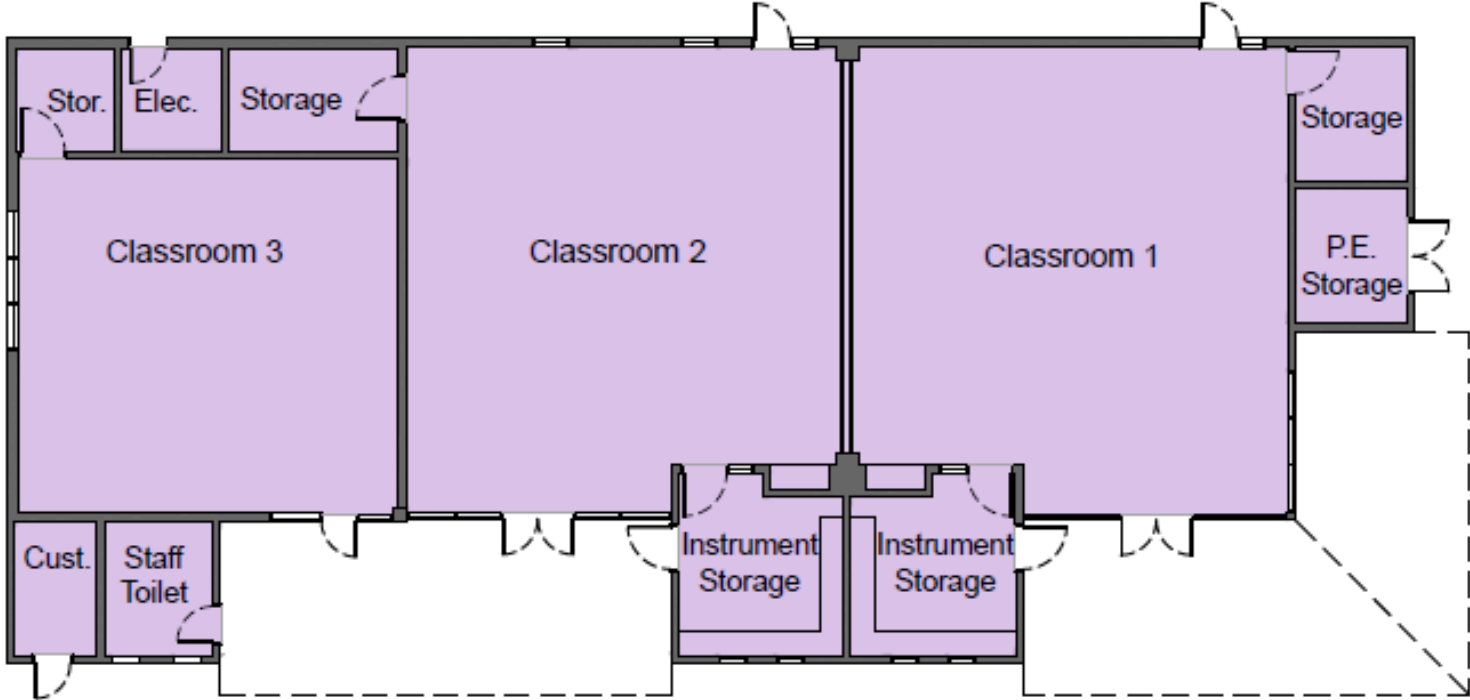

INTERIOR RENDERING



Flexible Classroom with Open Skyfold Wall

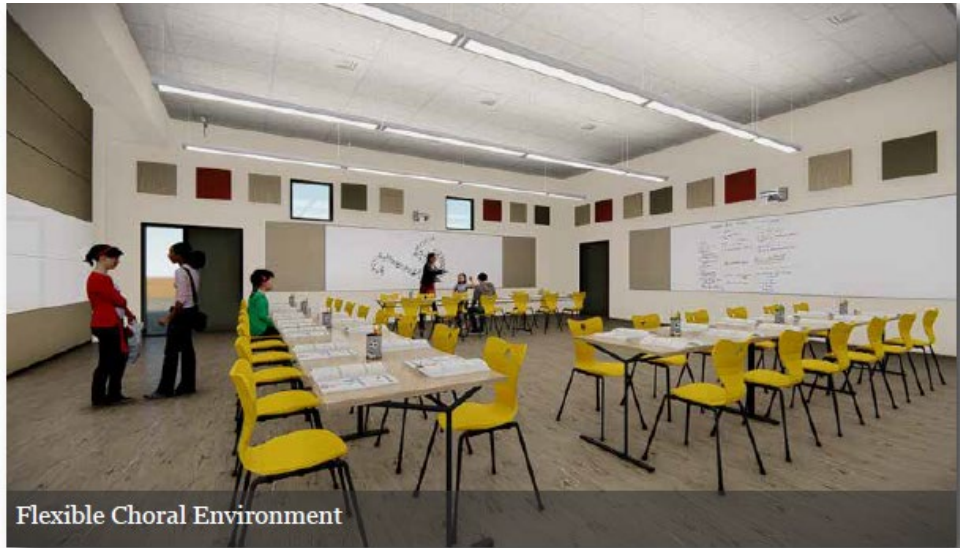

Flexible Choral Environment

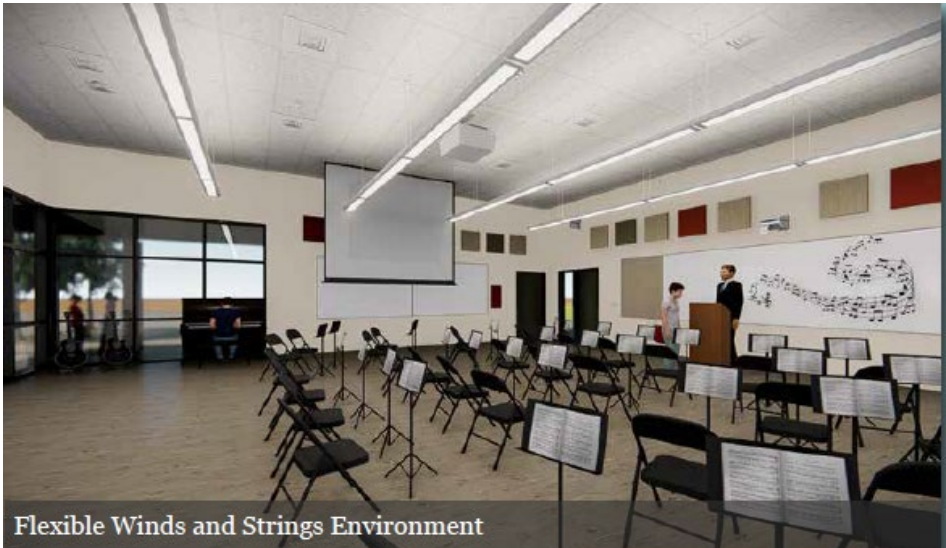

Flexible Winds and Strings Environment

Turtle Rock Project Schedule

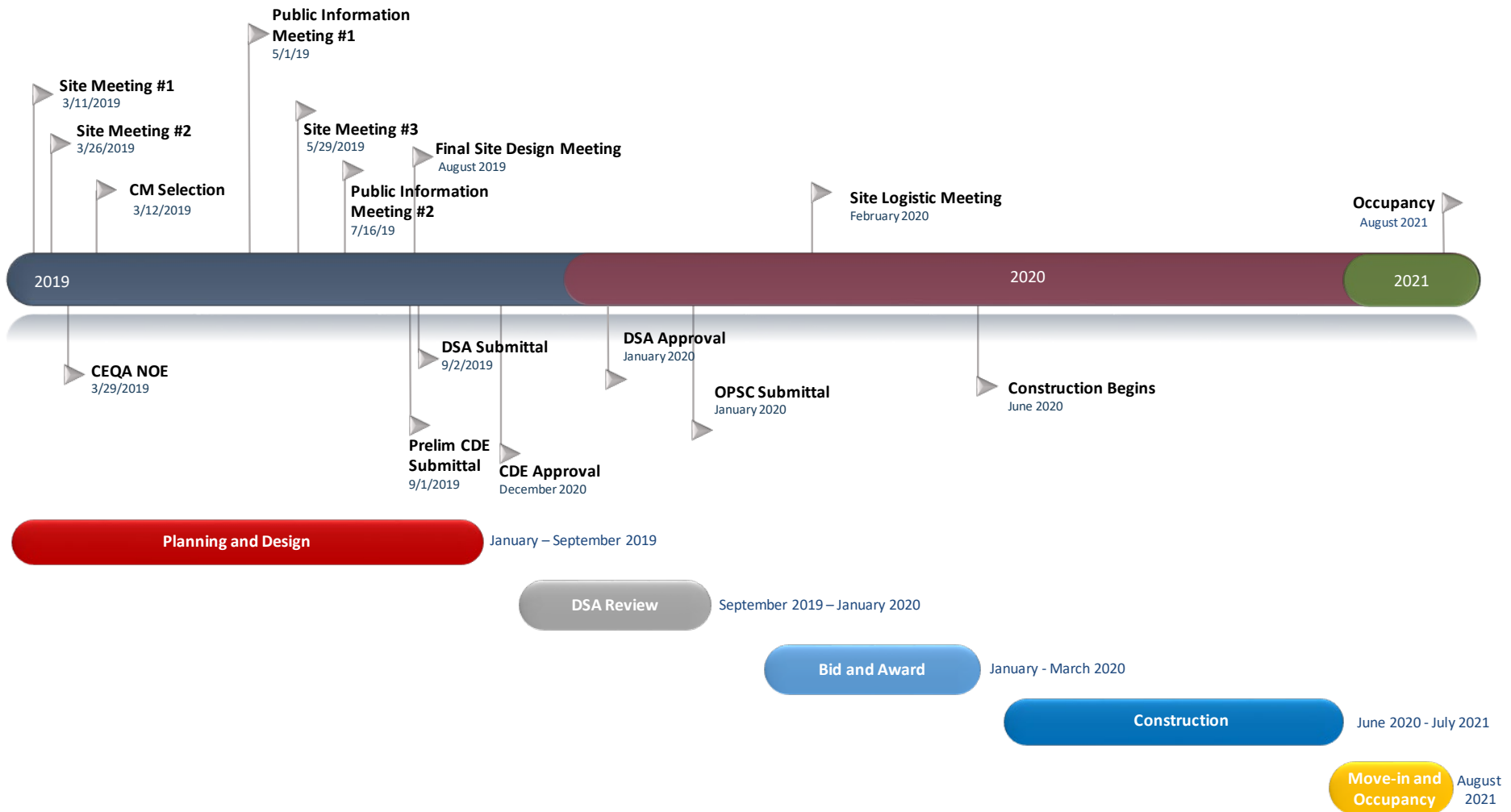

MEASURE E RESOURCES

- Measure E Webpage
iusd.org/MeasureE
- Turtle Rock ES Measure E Webpage – school site updates
<https://iusd.org/departments/turtle-rock-measure-e>
- Citizens Oversight Committee Webpage
iusd.org/COC
- Contact Email for Questions/Concerns
MeasureE@iusd.org





QUESTIONS and ANSWERS