



**Irvine Unified School District
Education Advisory Committee**

Measure E Overview

April 27, 2017

AGENDA

- **Facilities Master Plan**
- **Bond Measure**
- **Measure E Implementation**
- **Communication**
- **Series 1 Projects**
- **Non-Bond Measure Projects**
- **Questions**



FACILITIES MASTER PLAN

- **Comprehensive plan created in 2012**
- **Refined in 2015 with current cost estimates**
 - Districtwide improvement needs approximately **\$820.0** million
 - Districtwide needs include:
 - facilities improvements
 - enrollment growth
 - site upgrades
 - upgrades to non-school site facilities
- **Determine the need for a General Obligation Bond**



Bond Measure



SFID BOND MEASURE

- **Schools Facility Improvement District (SFID)**
 - Carved out newer schools under a Mitigation Agreement (Mello-Roos)
 - Focused on 28 schools of the 38 schools
- **June 7, 2016 Ballot**
 - \$319.0 million Bond Measure (Measure E)
 - \$29 / \$100,000 assessed value tax increase
 - Four bond series sales
 - Proposition 39 (School Facilities Local Vote Act of 2000)
 - Passed at 60.2% (55% required)



MEASURE E PROJECTS

 - High Schools

5

 - Middle Schools

5

 - Elementary Schools

18

28

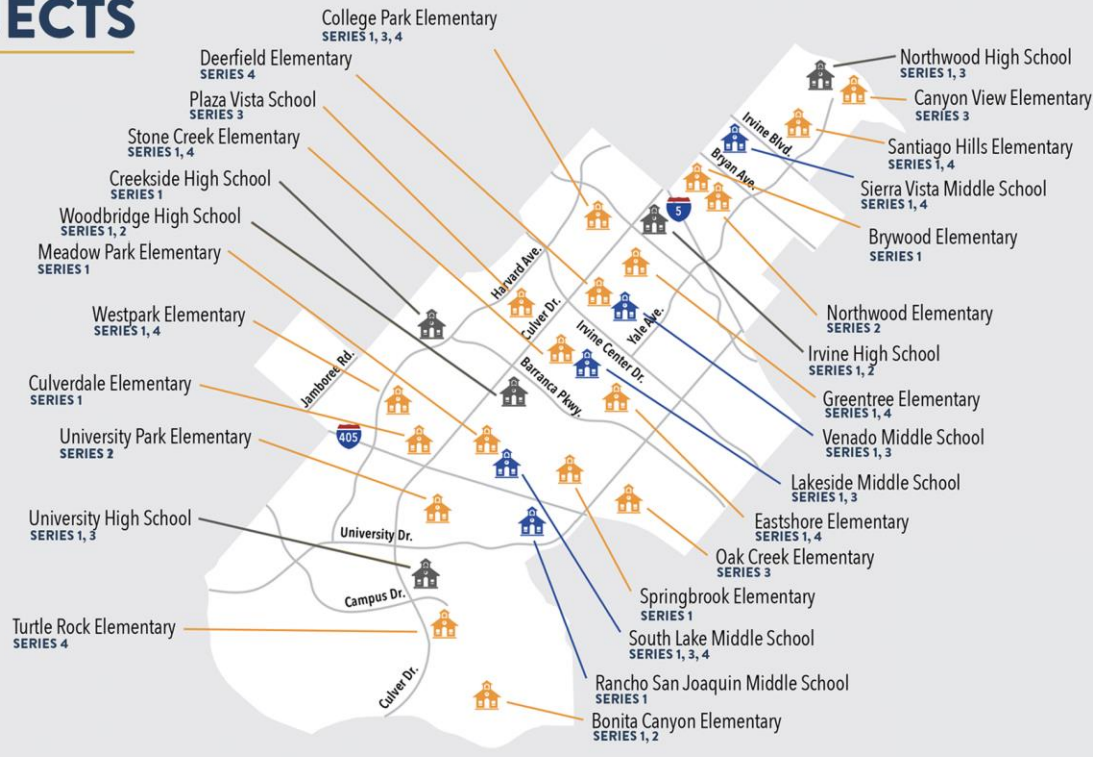

PRIORITIZATION OF PROJECTS

- **Safety and security**
 - Install interior doors at elementary school classrooms
- **Age of the school site**
 - Modernize eligible schools over 25 years old
- **Projects that will impact the greatest amount of students**
 - Projects for high schools and middle schools, which benefit most Irvine USD students, who will attend these schools
- **Upgrade Science Labs at middle schools**



TIMELINE

- **Mar. 2015:** Board approved Resolution for June 2016 Bond Election
- ***Jun. 2016:*** *Measure E passed*
- **Aug. 2016:** Measure E Implementation Plan presented to Board
- **Oct. 2016:** Received Series 1 funds (\$95.0 million)
- **Oct. 2016 – ongoing:** Planning and designing of Series 1 projects
- **Apr. 2017 – May 2017:** Bid and Award of six schools
- ***Jun. 2017:*** *Construction at six schools to commence*
- **Jan. 2018 – Dec. 2019:** Construction at the remaining schools



Measure E Implementation



SERIES 1: FUNDS

- 21 of the 28 schools within Series 1
- Series 1 funds

Series 1 Measure E funds	\$95.0 million
--------------------------	----------------

<u>Additional funds made available by District</u>	<u>\$36.4 million</u>
--	-----------------------

TOTAL Series 1 funds	\$131.4 million
----------------------	-----------------

- Potential Series 1 state matching funds of \$27.5 million from Prop 51



SERIES 1: SCHOOL IMPROVEMENTS

- **Improvements at various schools**
 - Enclose open classrooms, new / upgrade student commons
 - Modernize schools and facilities
 - New music classroom buildings
 - Expand / repurpose classrooms
 - New / upgrade science classrooms
 - New theater
 - New synthetic track and field





PROJECT TYPES

- a. Modernize facilities over 25 years of age
- b. Enclose open classrooms
- c. Construct Music Classrooms
- d. Construct Multipurpose Room
- e. Construct/Upgrade Food Service
- f. Construct Career Tech and Innovation/Design Labs
- g. Construct Visual and Performing Arts, Media Arts Elective Labs and New/Upgrade Theaters
- h. Construct/upgrade science labs and Elective Spaces
- i. Construct/Upgrade Kinder Classrooms
- j. Construct all weather track and field
- k. Construct Classrooms to replace portables
- l. Construct Practice Gym
- m. Construct/Upgrade Site Specific Support Facilities

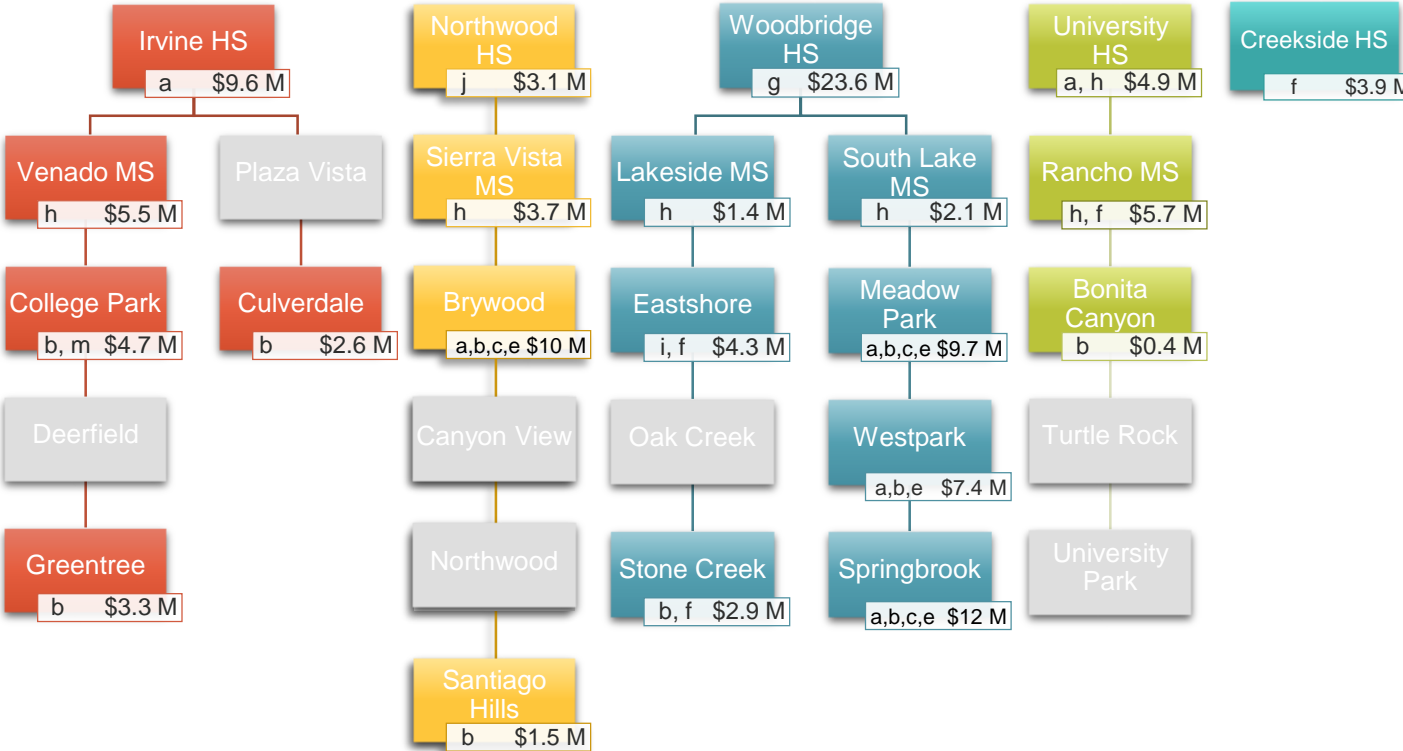

$$\boxed{\$25.7 \text{ M}} + \boxed{\$18.3 \text{ M}} + \boxed{\$64.4 \text{ M}} + \boxed{\$11.0 \text{ M}} + \boxed{\$3.9 \text{ M}} = \boxed{\$123.3 \text{ M}}$$

Program Escalation + \$8.1 M

$$\boxed{\text{Total Program Cost } \$131.4 \text{ M}}$$

Funding
\$95.0 M Bond
\$36.4 M IUSD

Communication



SERIES 1: MEETINGS

- **School Site Meetings**
 - Stakeholders
 - Design Committee
 - Site Meetings
 - Community Outreach
- **District Meetings**
 - Departments
 - Schools Facilities Improvement Measure Steering Committee
 - Citizens Oversight Committee
 - Study Session / Board of Education



DESIGN AND CONSTRUCTION PROCESS

Request For
Proposal (**RFP**)

Architect /
Engineer (**A/E**)

California
Department of
Education (**CDE**)

Division of State
Architect (**DSA**)

Office of Public
School
Construction
(**OPSC**)



CONSTRUCTION SCHEDULE (EXAMPLE)

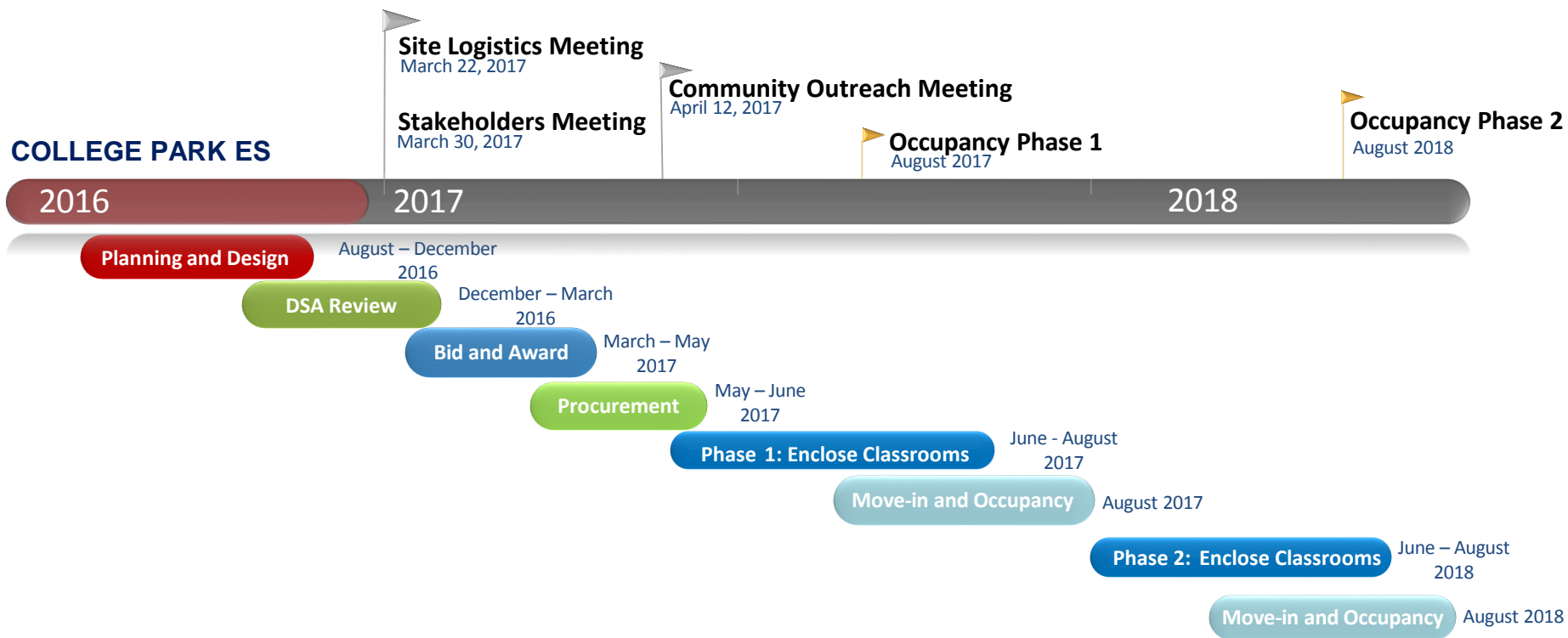

SERIES 1: WEBSITE

- **Measure E Webpage**
iusd.org/MeasureE
- **College Park Measure E Webpage – school site updates**
iusd.org/MeasureEcp
- **Citizens Oversight Committee Webpage**
iusd.org/COC
- **Contact Email for Questions/Concerns**
MeasureE@iusd.org



COMMUNICATION: FACILITIES & CONSTRUCTION



IRVINE UNIFIED
SCHOOL DISTRICT

[TRANSLATE](#)[TEXT SIZE A A](#)[STAFF INTRANET](#)[PARENT PORTAL](#)[ABOUT](#)[PARENTS](#)[STUDENTS](#)[SCHOOLS](#)

CONSTRUCTION SERVICES

The Irvine Unified School District Facilities Planning Department and Construction Services Department work collectively on a variety of projects for the District. In addition to planning and overseeing the construction of new schools and modernizing existing schools, the departments work closely with the Education Services Department establishing enrollment projections, making recommendations for new schools, establishing attendance boundaries, and accommodating growth at existing schools.

Our Facilities Planning and Construction Services staff works diligently to identify and deliver the best possible learning environments and support facilities for IUSD students, community, and faculty.

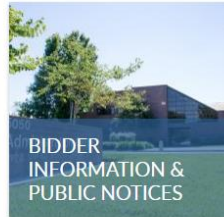
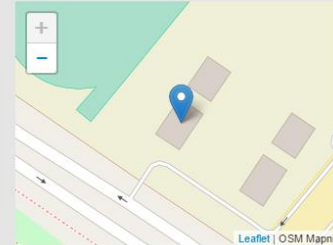
[LEARN MORE](#)[PROJECTS](#)[LEARN MORE](#)[FACILITIES MASTER PLAN](#)[LEARN MORE](#)[MEASURE E](#)[IUSD ENROLLMENT](#)[FACILITIES PLANNING & CONSTRUCTION CONTACTS](#)[Developer Fees](#)[Doing Business with IUSD](#)[Contact Us](#)**LOCATION:**

2015 Roosevelt
Irvine, CA 92620
United States



COMMUNICATION: SCHOOL WEBPAGE

[TRANSLATE](#)[TEXT SIZE A 15PX A](#)[STAFF INTRANET](#)[PARENT PO](#)[ABOUT](#)[PARENTS](#)[STUDENTS](#)[SCHOOLS](#)

enable IUSD to efficiently and effectively manage complex projects and resources. Funding for first series projects will be up to \$95 million.

What this means for Brywood is exciting – during this first series we are scheduled to receive modernizations and repairs, building system upgrades and classroom doors, among other upgrades. [Click here](#) to see the proposed project list.

Although we are in the early planning stages and the details have not been finalized, Brywood leadership and IUSD are committed to keeping our school community updated at every step of the project. Please check back regularly for Brywood Measure E updates, news and scheduled projects. For general Measure E information or information about the Citizens Oversight Committee, visit iusd.org/MeasureE.

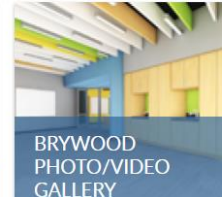
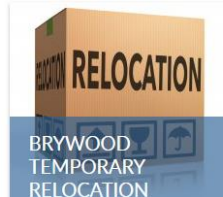
[Learn More](#)[Learn More](#)[Learn More](#)

Series 1 Projects

(partial listing)



Enclose Classrooms, New/Upgrade Student Commons



BONITA CANYON ES

Bid and Award Phase



Interior view of Student Commons



CULVERDALE ES

Bid and Award Phase



Interior view of Student Commons



STONE CREEK ES

Bid and Award Phase



Interior view of Design Lab



STONE CREEK ES

Bid and Award Phase



Exterior view of Design and Innovation Labs



COLLEGE PARK ES

Bid and Award Phase



Interior view of Innovation Lab



GREENTREE ES

Bid and Award Phase



Interior view of Student Commons



SANTIAGO HILLS ES

Bid and Award Phase



Interior view of Student Commons



Expansion



CREEKSIDE HS

Schematic Design Phase



Classroom Buildings Expansion



Design Development Phase

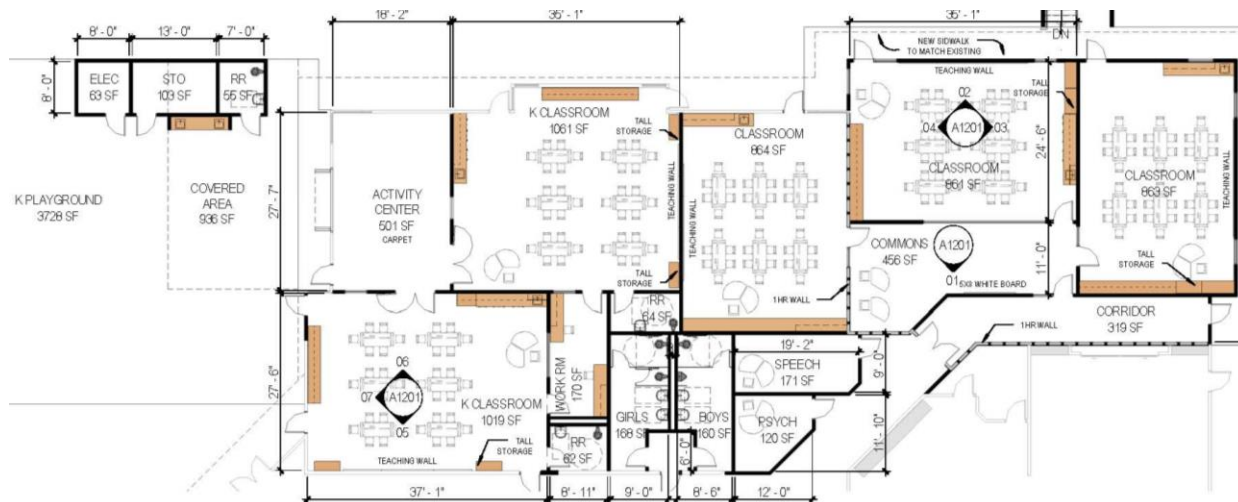

Enlarged Plan



Middle School Science Classrooms



SIERRA VISTA MS

Schematic Design Phase



Science Classroom Building Expansion – Site View

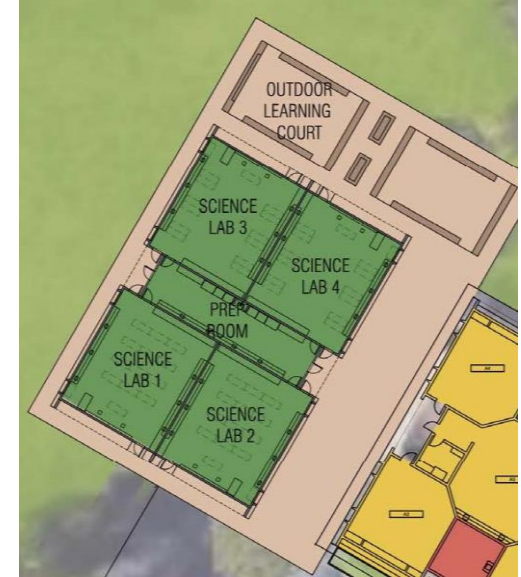

Enlarged Plan



LAKESIDE MS

Schematic Design Phase

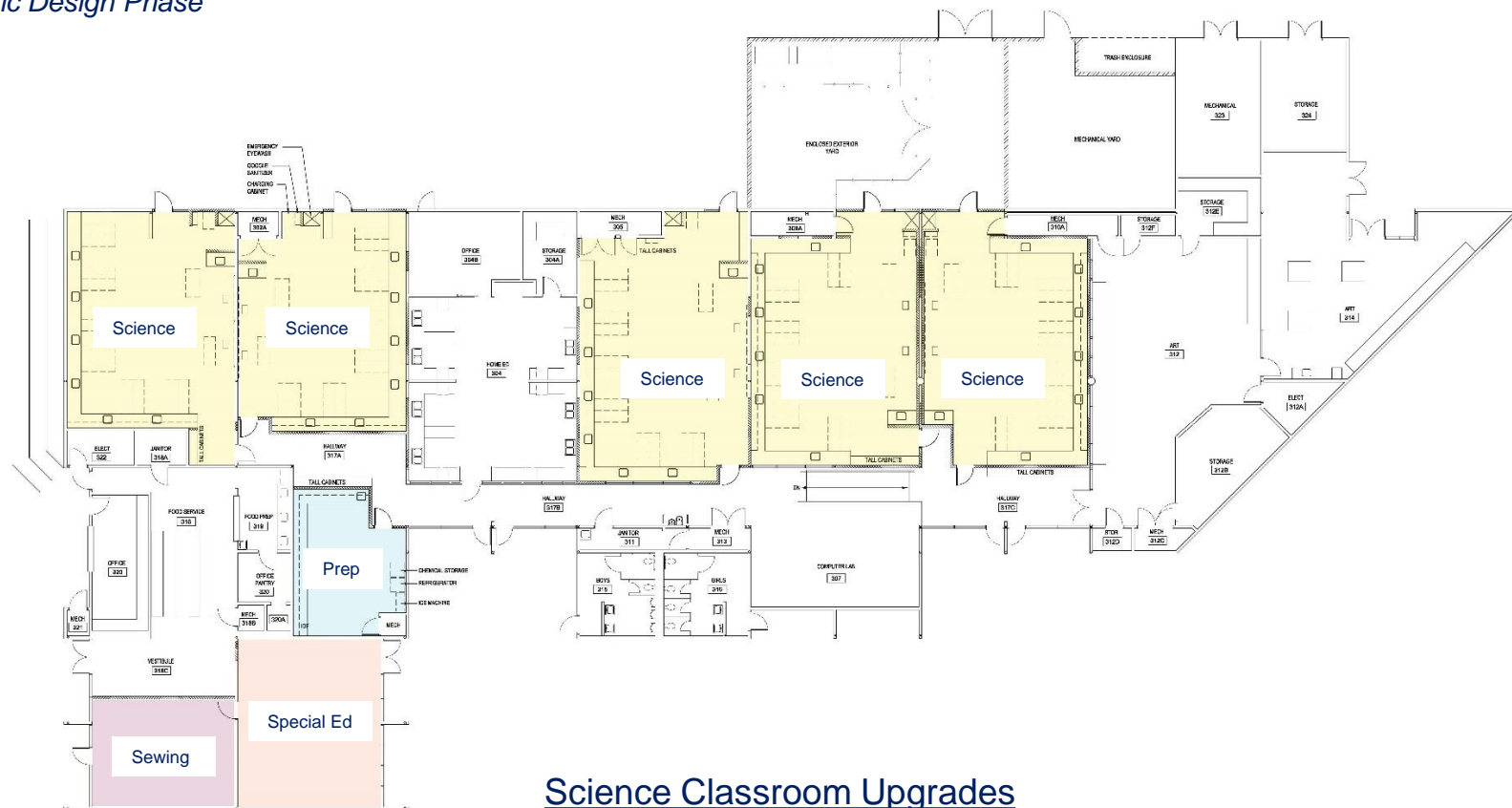

Science Classroom Upgrades



SOUTH LAKE MS

Schematic Design phase



Science Classroom Building Expansion - Site

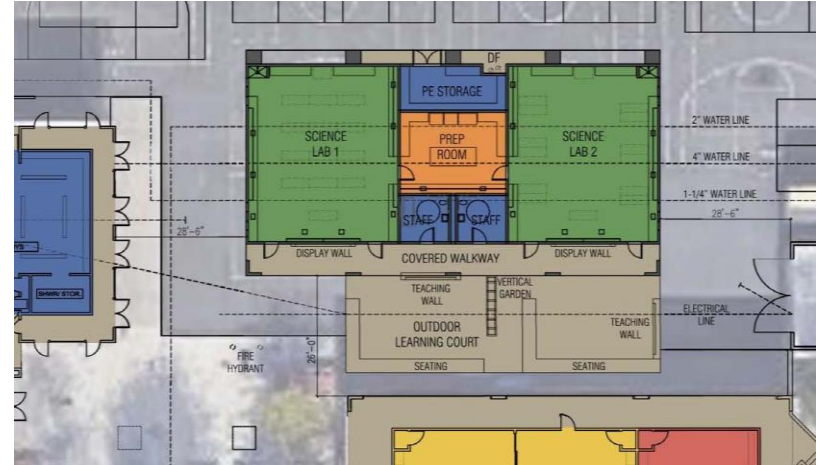

Science Classroom Building Expansion



VENADO MS

Design Development Phase

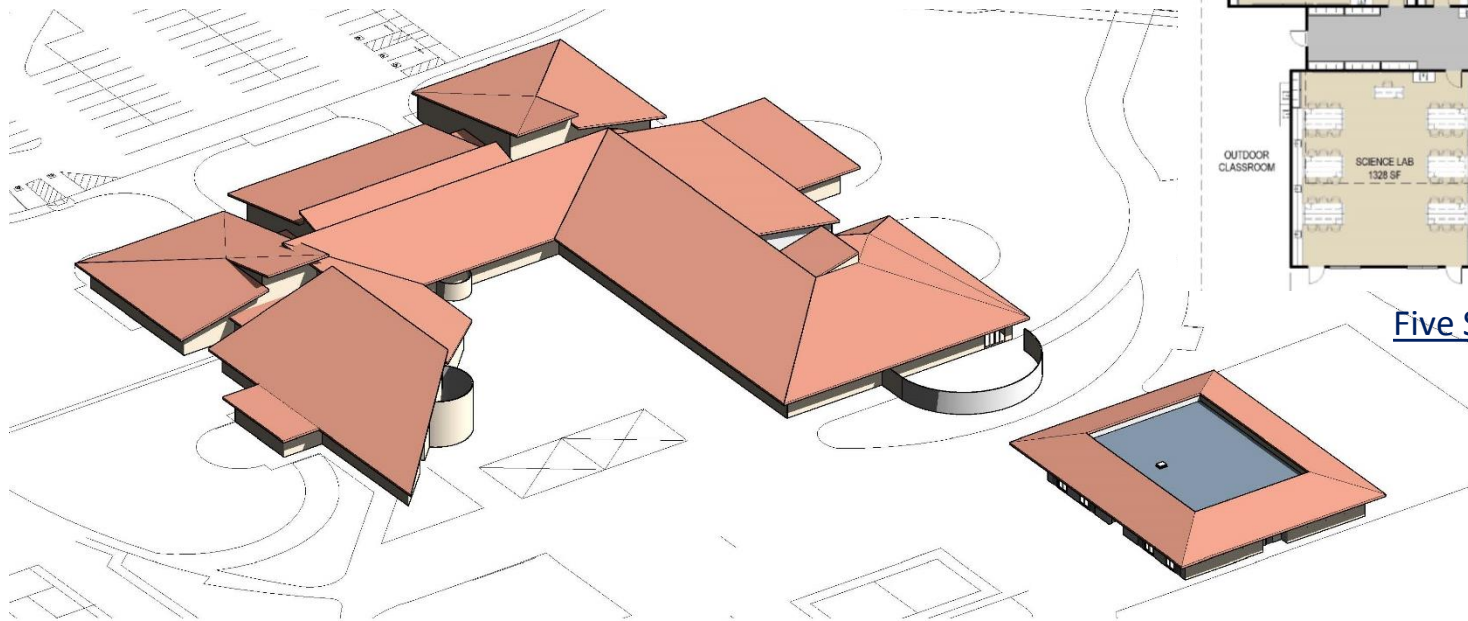

Five Science Classrooms

New Science Classroom Building



RANCHO SAN JOAQUIN MS

Design Development Phase



Science Classroom Building Expansion and Upgrades



New Theater



WOODBIDGE HS

Schematic Design Phase

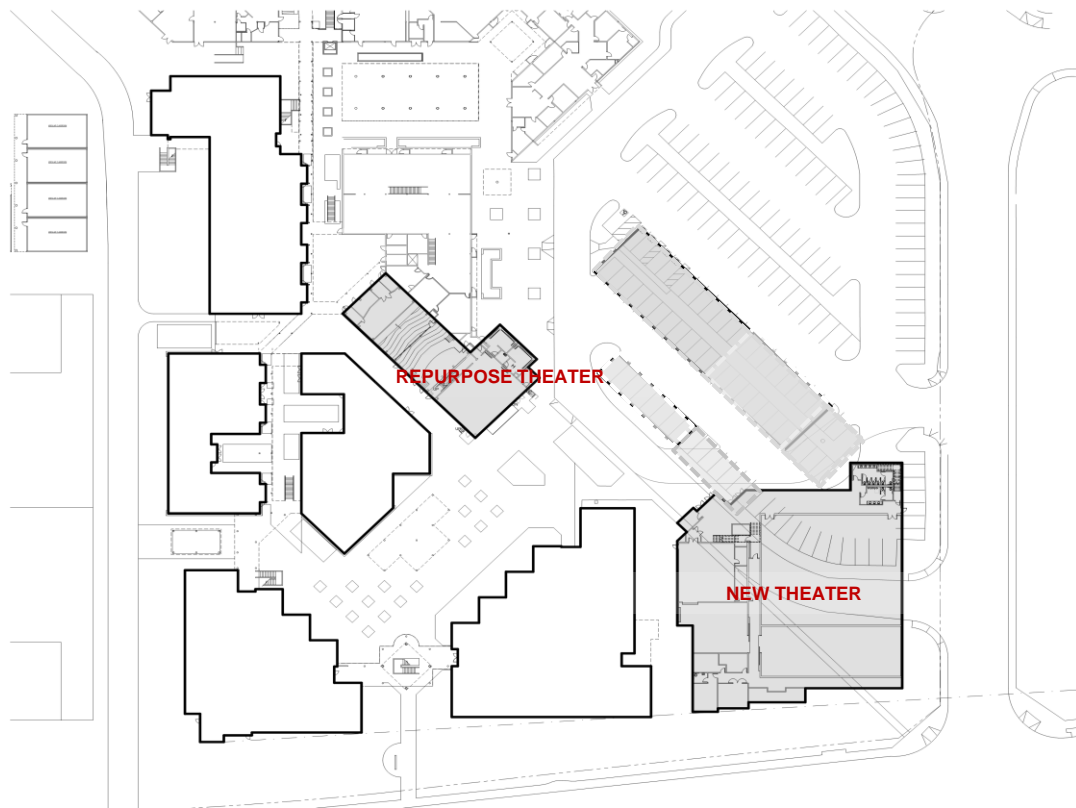

New Theater and Repurpose Existing Theater



Non- Bond Measure Projects



PORTOLA HIGH SCHOOL (Opened August 2017)



BEACON PARK SCHOOL (Opened August 2017)



HERITAGE FIELDS #2 (Opening August 2018)

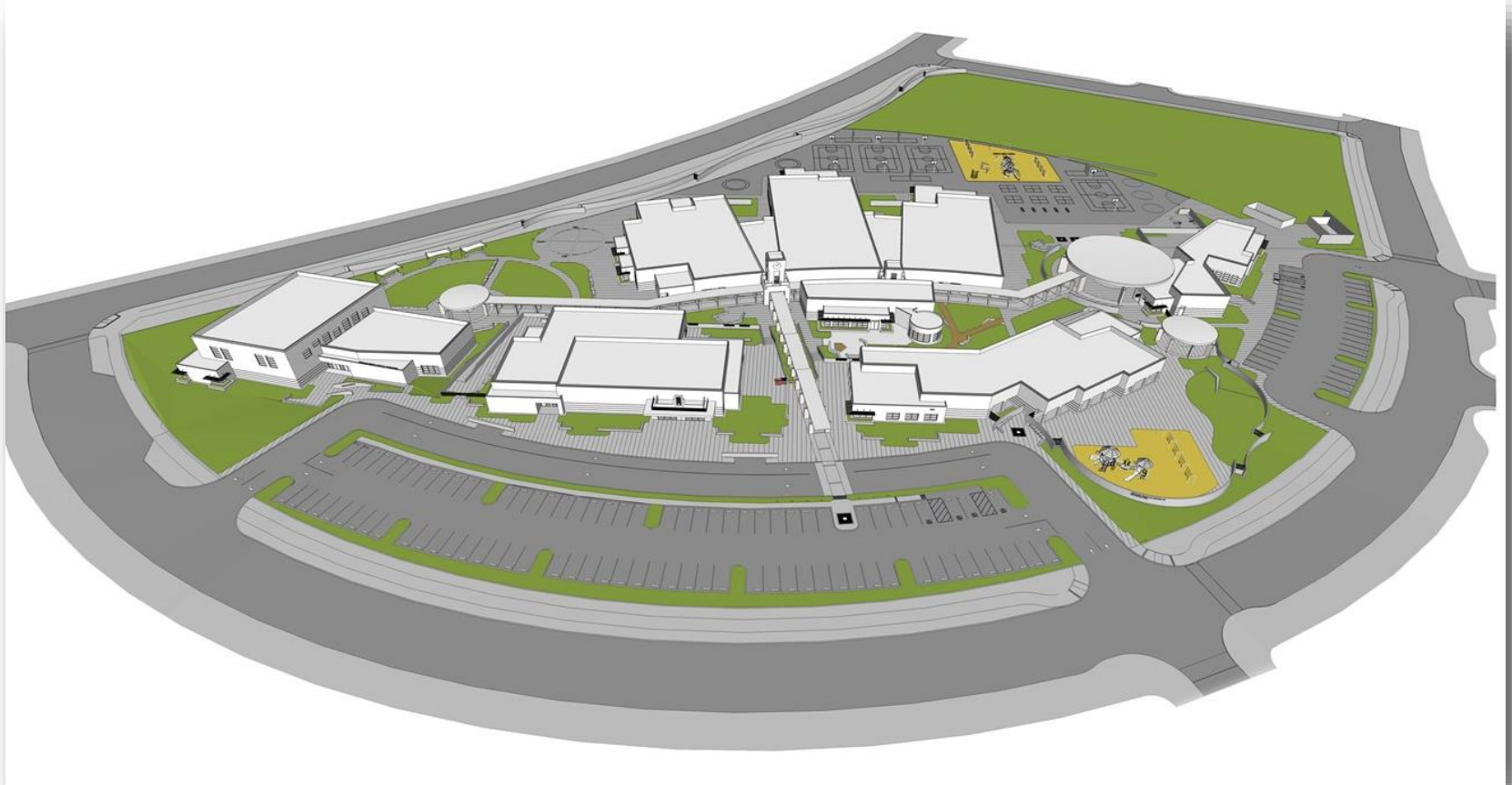

HERITAGE FIELDS #2 (Opening August 2018)



PORTOLA SPRINGS ES #2 (Opening August 2019)



PORTOLA SPRINGS ES #2 (Opening August 2019)





QUESTIONS?