

South Lake MS Science Lab Public Information Meeting

March 14, 2018



MEETING AGENDA

- Introductions
- Overview of Measure E Program
- Project Overview
- Resources
- Questions and Answers



INTRODUCTIONS

- Kim Coffeen – IUSD, Director Facilities Planning
- Christa DeBoer – IUSD Supervisor, Facilities/Construction

Additional Team Members:

- Kelvin Okino – IUSD, Executive Director, Facilities Planning and Construction
- Belinda Averill – IUSD, Principal of South Lake MS
- Annie Brown – IUSD, Public Information Officer
- Gary Moon – TBP Architecture
- Carolyn Loughrey – TBP Architecture
- Jim Yost – Neff Construction, Construction Manager



Overview of Measure E Program



MEASURE E PROJECTS

 - High Schools 5

 - Middle Schools 5

 - Elementary Schools 18

28

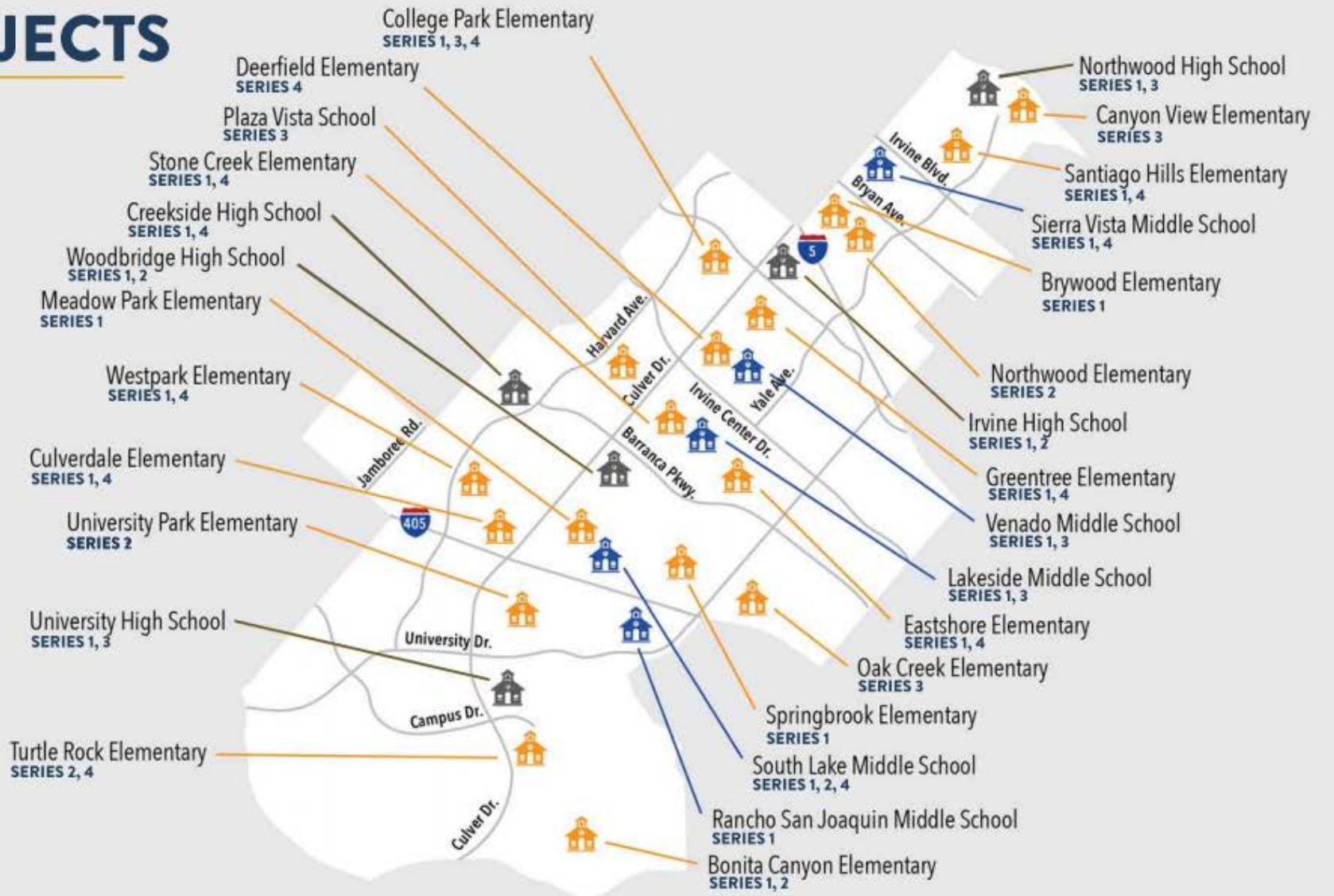

SERIES 1 PRIORITIES

- **Safety and security**
 - Install interior doors at elementary school classrooms
- **Age of the school site**
 - Modernize eligible schools over 25 years old
- **Projects that will impact the greatest amount of students**
 - Projects for high schools and middle schools, which benefit most Irvine USD students, who will attend these schools
- **Upgrade Science Labs at middle schools**





PROJECT TYPES

- a. Modernize facilities over 25 years of age
- b. Enclose open classrooms
- c. Construct Music Classrooms
- d. Construct Multipurpose Room
- e. Construct/Upgrade Food Service
- f. Construct Career Tech and Innovation/Design Labs
- g. Construct Visual and Performing Arts, Media Arts Elective Labs and New/Upgrade Theaters
- h. Construct/upgrade science labs and Elective Spaces
- i. Construct/Upgrade Kinder Classrooms
- j. Construct all weather track and field
- k. Construct Classrooms to replace portables
- l. Construct Practice Gym
- m. Construct/Upgrade Site Specific Support Facilities

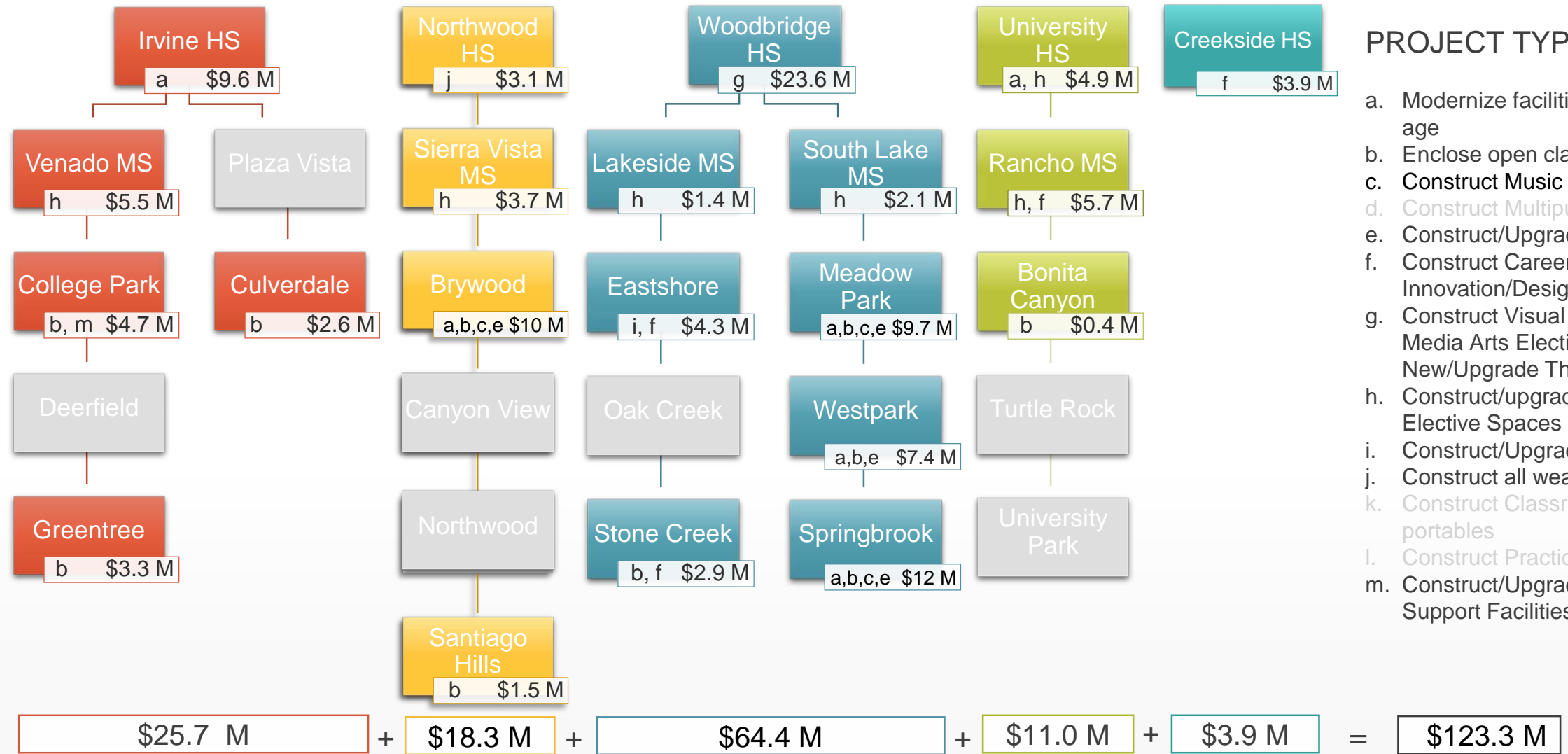

Funding
 \$95.0 M Bond
 \$36.4 M IUSD

Measure E Series Projects and Costs



PROJECT TYPES

- a. Modernize facilities over 25 years of age
 - b. Enclose open classrooms
 - c. Construct Music Classrooms
 - d. Construct Multipurpose Room
 - e. Construct/Upgrade Food Service
 - f. Construct Career Tech and Innovation/Design Labs
 - g. Construct Visual and Performing Arts, Media Arts Elective Labs and New/Upgrade Theaters
 - h. Construct/upgrade science labs and Elective Spaces
 - i. Construct/Upgrade Kinder Classrooms
 - j. Construct all weather track and field
 - k. Construct Classrooms to replace portables
 - l. Construct Practice Gym
 - m. Construct/Upgrade Site Specific Support Facilities
- ◇ Sites that are not part of the first and second bond series

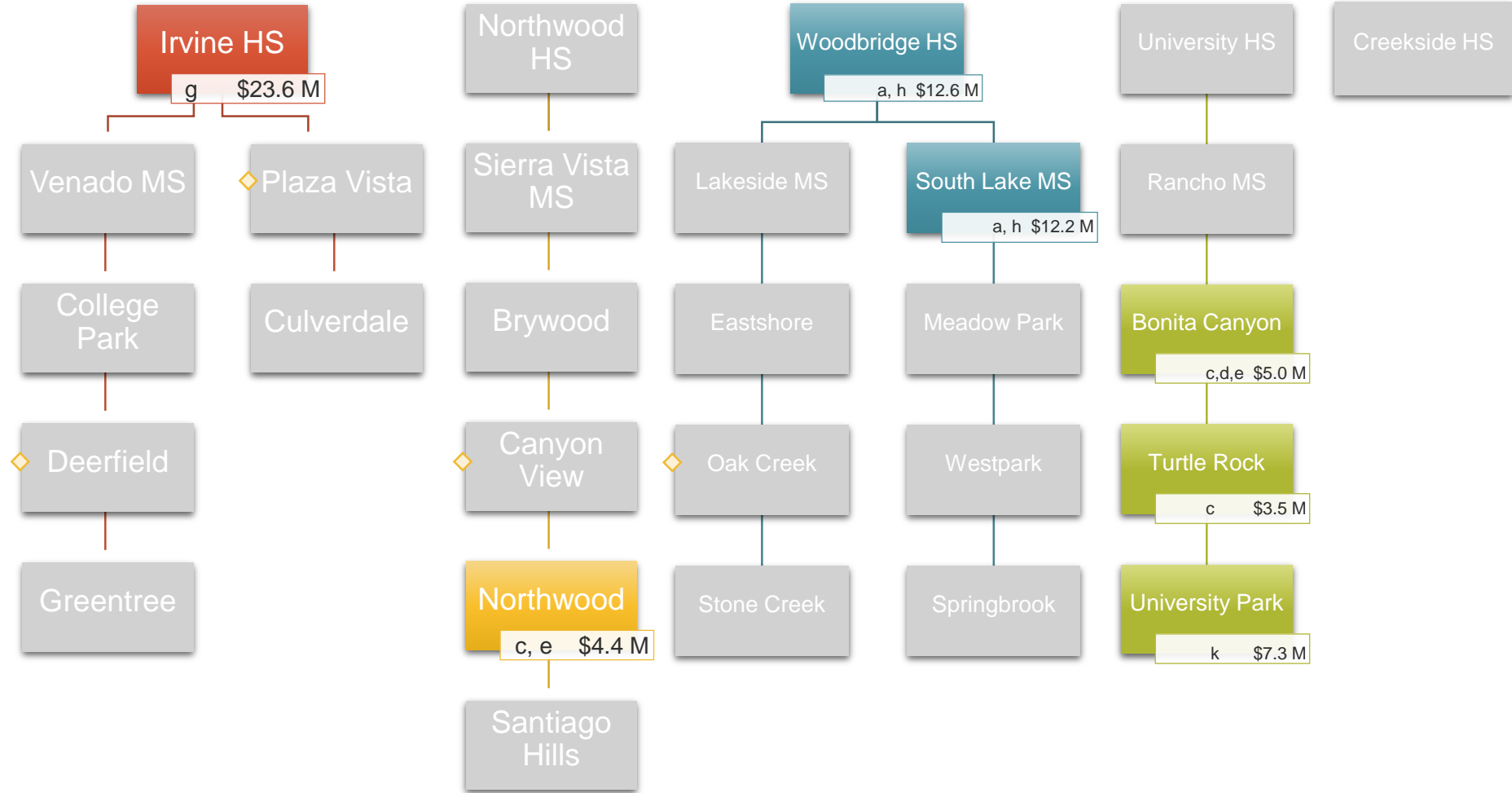

$$\boxed{\$23.6 \text{ M}} + \boxed{\$4.4 \text{ M}} + \boxed{\$24.8 \text{ M}} + \boxed{\$15.8 \text{ M}} + \boxed{-} = \boxed{\$68.6 \text{ M}}$$

Program Escalation +	<u>\$11.0 M</u>	
Total Program Cost	\$79.6 M	<i>Funding</i> <i>\$51.9 M</i> <i>\$27.7 M</i>

Bond IUSD

Measure E Series 2 Projects and Costs



PROJECT TYPES

- a. Modernize facilities over 25 years of age
 - b. Enclose open classrooms
 - c. Construct Music Classrooms
 - d. Upgrade/Construct Multipurpose Room
 - e. Construct/Upgrade Food Service
 - f. Construct Career Tech and Innovation/Design Labs
 - g. Construct Visual and Performing Arts, Media Arts Elective Labs and New/Upgrade Theaters
 - h. Construct/upgrade science labs and Elective Spaces
 - i. Construct/Upgrade Kinder Classrooms
 - j. Construct all weather track and field
 - k. Construct Classrooms to replace portables
 - l. Construct Practice Gym
 - m. Construct/Upgrade Site Specific Support Facilities
- ◆ Site that is not part of the previous bond series

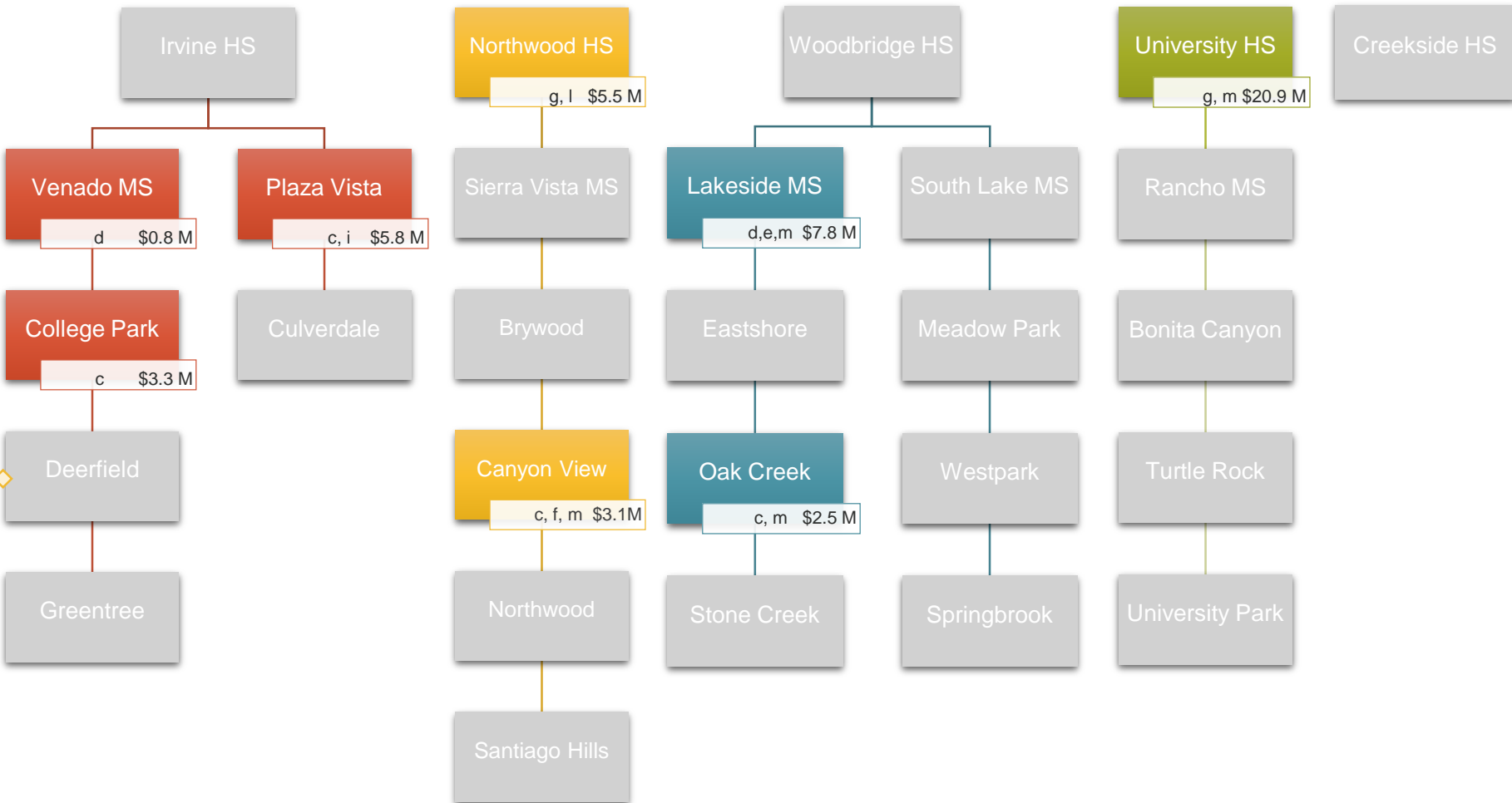

$$\boxed{\$9.9 \text{ M}} + \boxed{\$8.6 \text{ M}} + \boxed{\$10.3 \text{ M}} + \boxed{\$20.9 \text{ M}} + \boxed{-} = \boxed{\$49.7 \text{ M}}$$

Program Escalation +	\$11.0 M	<i>Funding</i> \$49.4 M \$ 7.7 M \$ 3.6 M	<i>Bond</i> IUSD TBD
Total Program Cost	\$60.7 M		

Measure E Series 3 Projects and Costs

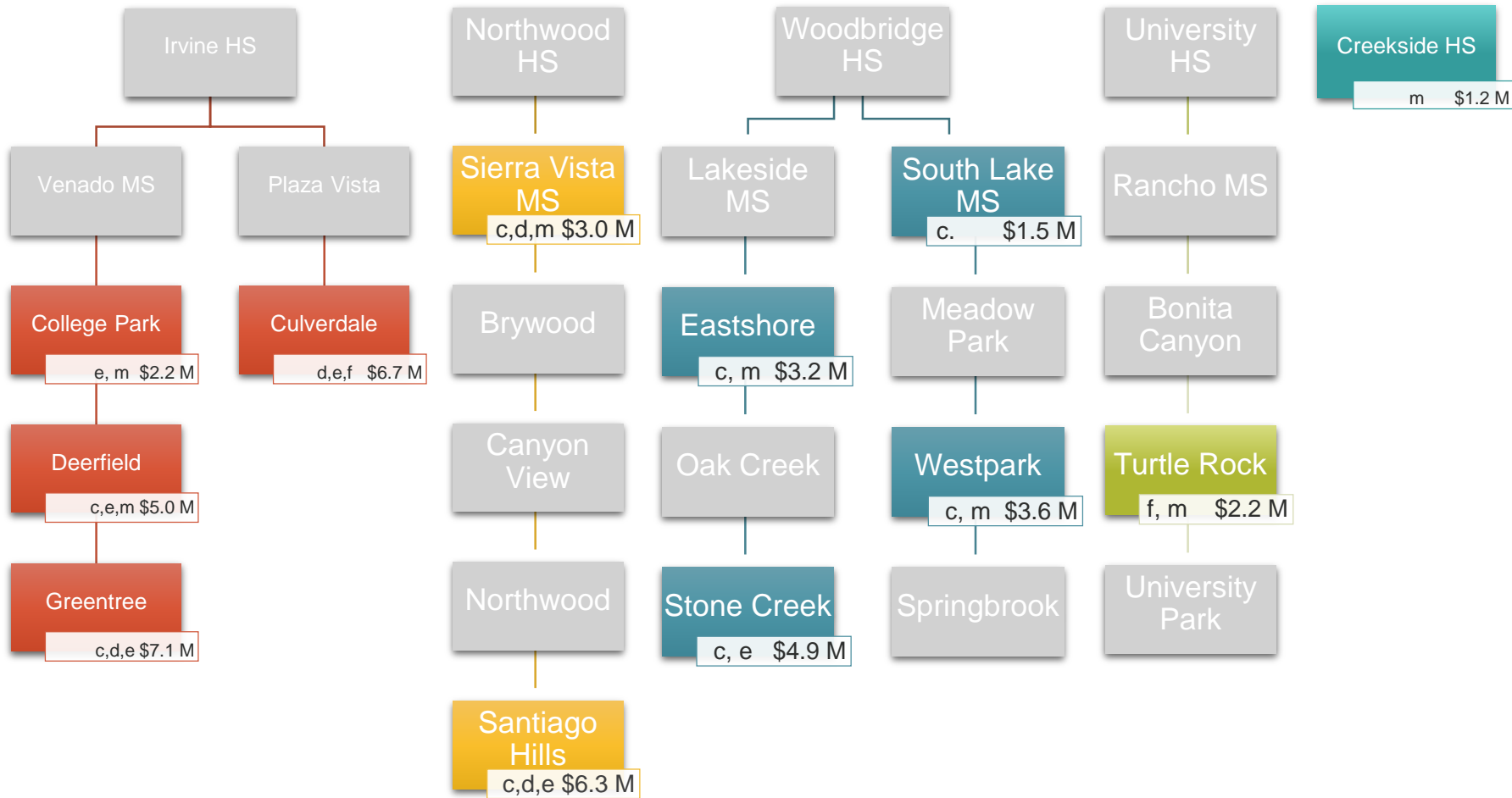

PROJECT TYPES

- a. Modernize facilities over 25 years of age
- b. Enclose open classrooms
- c. Construct Music Classrooms
- d. Construct/Upgrade Multipurpose Room
- e. Construct/Upgrade Food Service
- f. Construct Career Tech and Innovation/Design Labs
- g. Construct Visual and Performing Arts, Media Arts Elective Labs and New/Upgrade Theaters
- h. Construct/upgrade science labs and Elective Spaces
- i. Construct/Upgrade Kinder Classrooms
- j. Construct all weather track and field
- k. Construct Classrooms to replace portables
- l. Construct Practice Gym
- m. Construct/Upgrade Site Specific Support Facilities

$$\boxed{\$21.0 \text{ M}} + \boxed{\$9.3 \text{ M}} + \boxed{\$13.2 \text{ M}} + \boxed{\$2.2 \text{ M}} + \boxed{\$1.2 \text{ M}} = \boxed{\$46.9 \text{ M}}$$

Program Escalation + $\boxed{\$11.0 \text{ M}}$

Total Program Cost $\boxed{\$57.9 \text{ M}}$

Funding
 \$54.5 M
 - 0 -
 \$ 3.4 M

Bond
 IUSD
 TBD

Measure E Series 4 Projects and Costs

Project Overview



PROJECT SCOPE

- Construct a new building to include two (2) Science Labs and a Prep Room
- Two (2) new staff restrooms, one with capabilities for ADA use.
- Site work associated with the new building





Exterior Rendering of Science Building



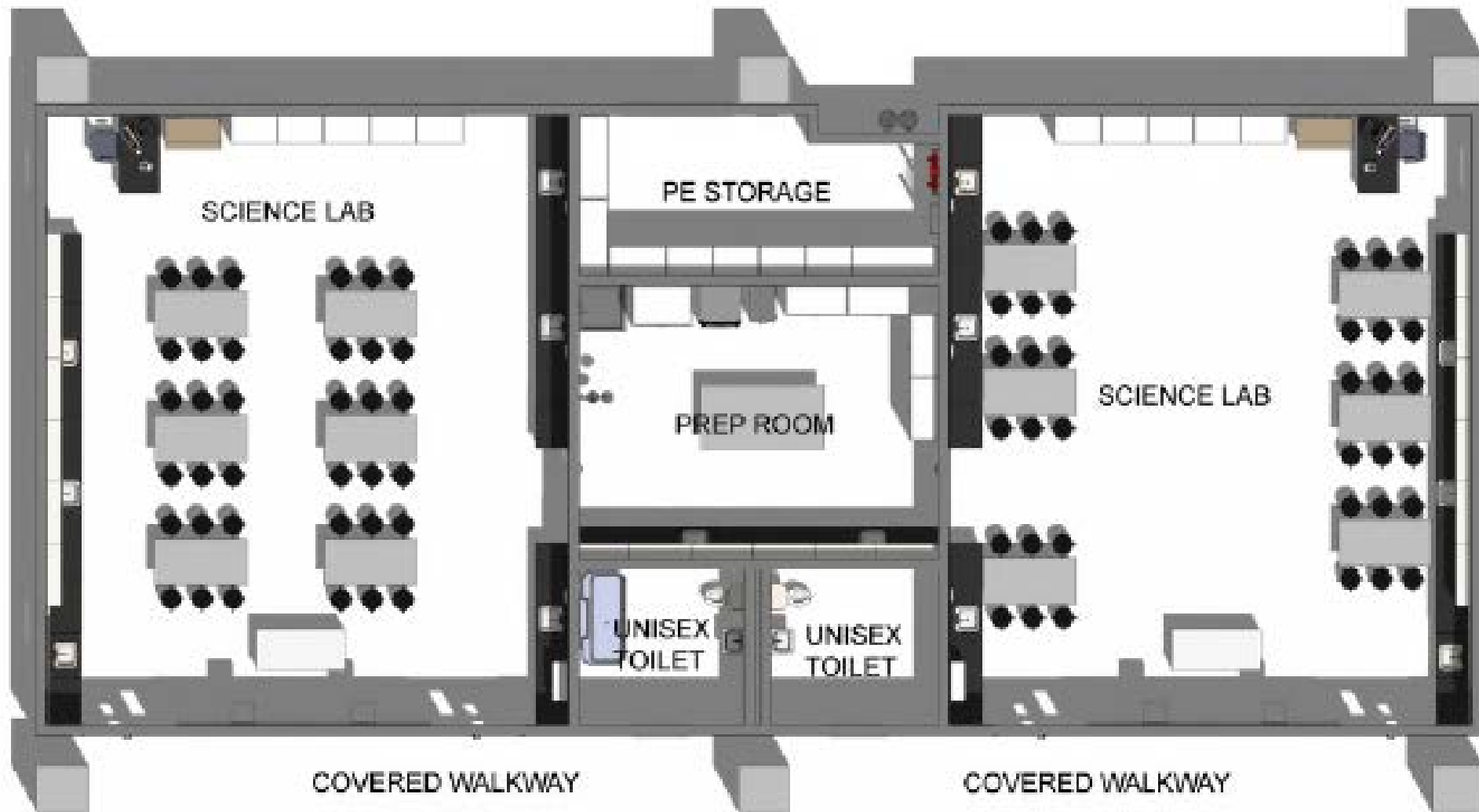

Floor Plan of Science Building





Interior Rendering of Science Lab





Interior Rendering of Science Lab





Interior Rendering of Prep Room



Site Logistics Plan

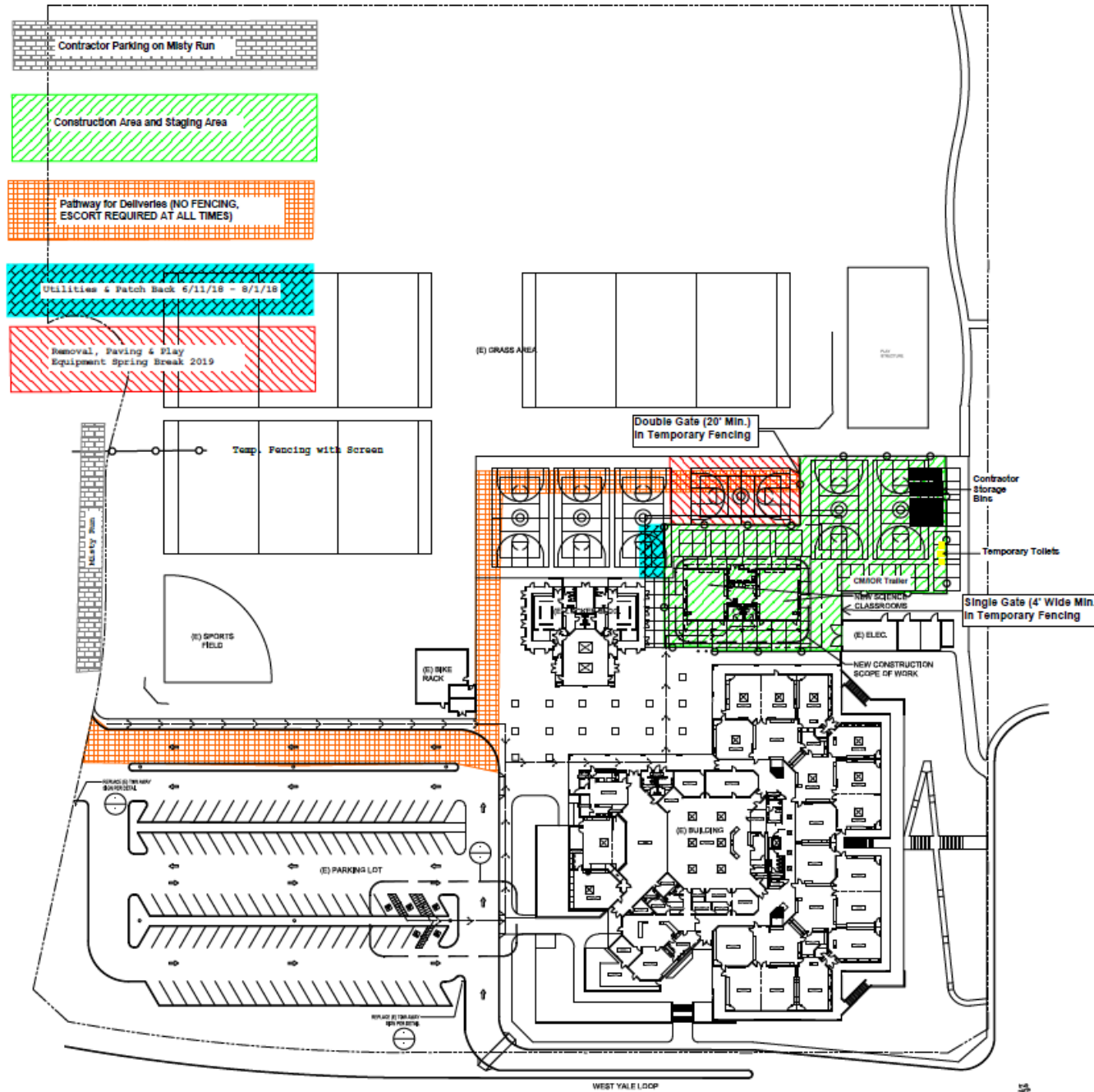

South Lake Project Schedule

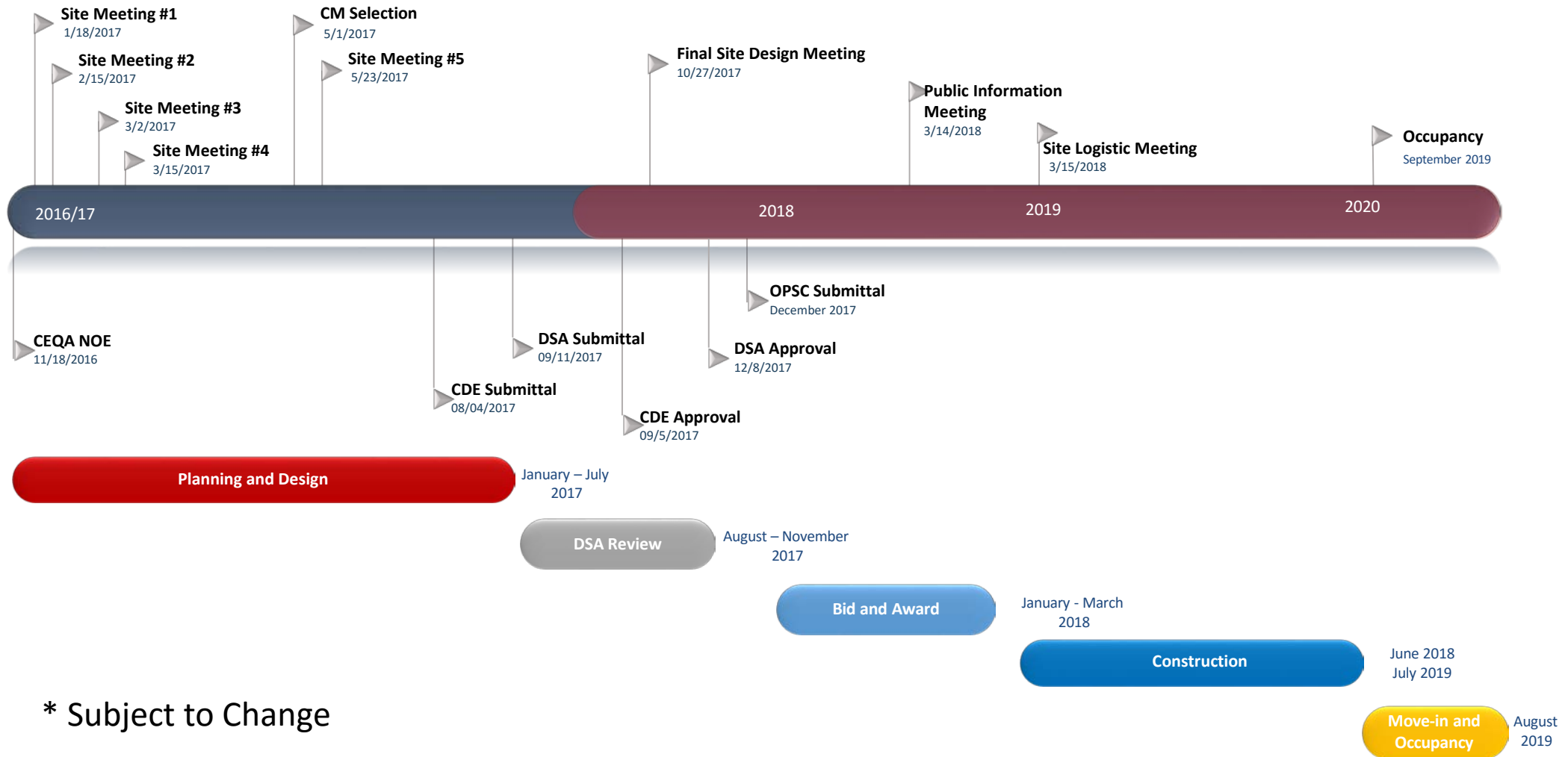

* Subject to Change

Resources



MEASURE E RESOURCES

- Measure E Webpage
iusd.org/MeasureE
- South Lake Measure E Webpage – school site updates
iusd.org/MeasureEsl
- Citizens Oversight Committee Webpage
iusd.org/COC
- Contact Email for Questions/Concerns
MeasureE@iusd.org





QUESTIONS and ANSWERS