

## SCHOOL STATISTICS

Grades:	9-12
2010/11 Enrollment:	2412
Year Built:	1971
Modernization:	1996
Site Acreage:	42.0
# Portables:	4
Existing Parking:	± 628
Targeted Enrollment	2400

## UHS CAPACITY

77 Teaching Stations  
+8 SDC  
=85 Teaching Stations

12 DHH Teaching Stations

## PROPOSED SCOPE

- New Construction
- Reconfiguration
- Modernization
- New Site Work
- Demolition

## Project 1

## UTILIZATION LEGEND

- Classroom Clusters
- Science
- Business/Design/Engineering
- Special Ed (SDC/SH)
- DHH
- Physical Education
- Performing Arts/Multi Media
- ASB/Library/Student Union
- Portable (Color based on Program)
- Other Spaces

**MODERNIZE (E)**  
CLASSROOM BLDGS  
SCIENCE 12,444 SF  
THEATER 9,457 SF  
PE 18,670 SF

PARKING (+/- 168)

PARKING (+/- 241)

PARKING (+/- 219)

1ST FLOOR

2ND FLOOR

### LEGEND

- Main Entry
- Secondary Entry
- Drop-Off
- Playfields/Landscape
- Hardcourts
- Play Apparatus
- Parking
- Trees
- Re-configure Space
- Modernize/Re-Purpose Space
- Demolish Space
- Addition/Expansion
- Modernization Eligible

SCALE 1:200

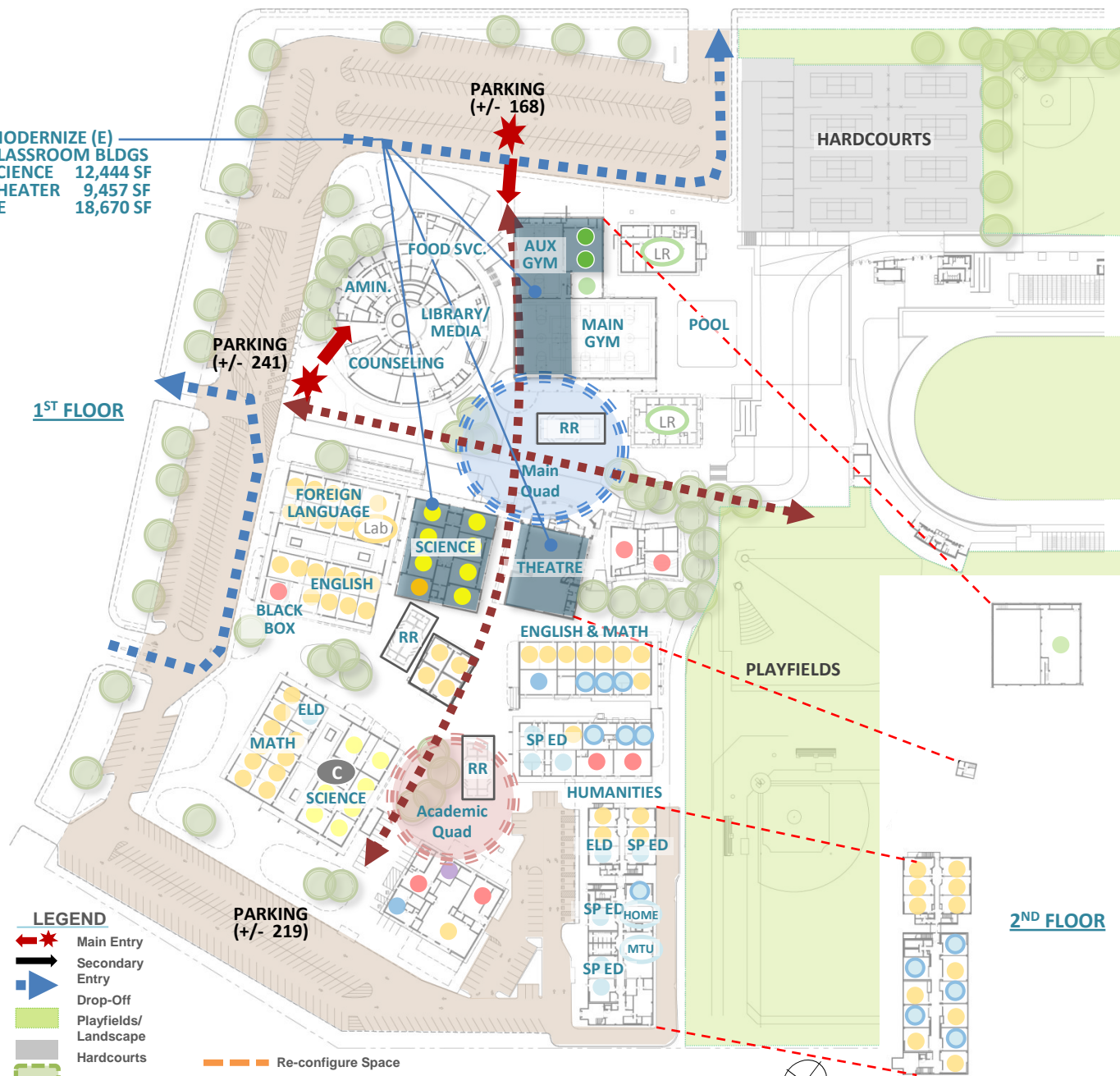

### SCHOOL STATISTICS

Grades:	9-12
2010/11 Enrollment:	2412
Year Built:	1971
Modernization:	1996
Site Acreage:	42.0
# Portables:	4
Existing Parking:	± 628
Targeted Enrollment	2400

### UHS CAPACITY

85 Teaching Stations
-4 Teaching Stations
+5 Teaching Stations
86 Teaching Stations

12 DHH Teaching Stations

### PROPOSED SCOPE

- New Construction
- Reconfiguration
- Modernization
- New Site Work
- Demolition

## Project 2

### UTILIZATION LEGEND

- Classroom Clusters
- Science
- Business/Design/Engineering
- Special Ed (SDC/SH)
- DHH
- Physical Education
- Performing Arts/Multi Media
- ASB/Library/Student Union
- Portable (Color based on Program)
- Other Spaces

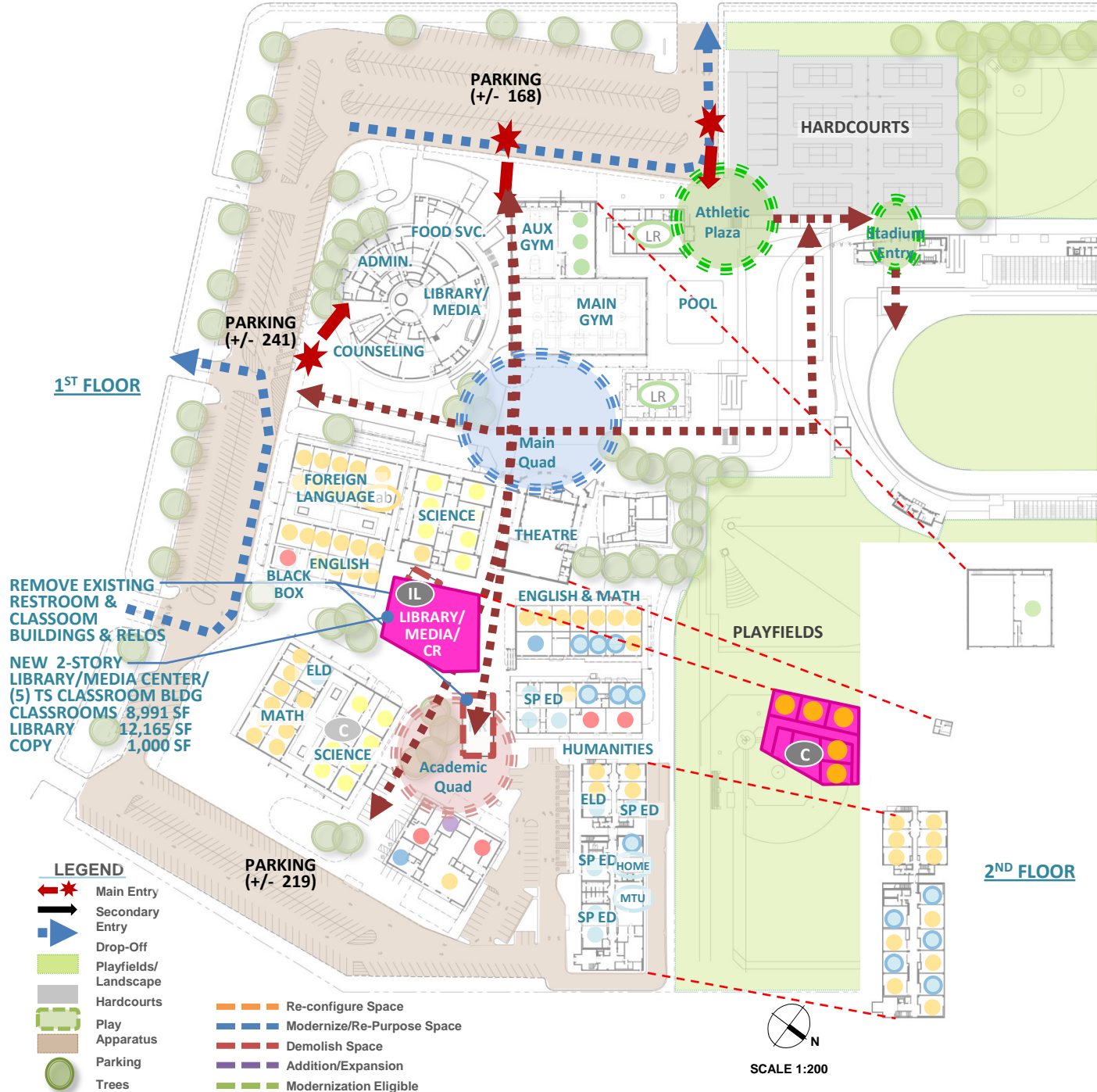

REMOVE EXISTING RESTROOM & CLASSROOM BUILDINGS & RELOS

NEW 2-STORY LIBRARY/MEDIA CENTER/ (5) TS CLASSROOM BLDG CLASSROOMS 8,991 SF LIBRARY 12,165 SF COPY 1,000 SF

### SCHOOL STATISTICS

Grades:	9-12
2010/11 Enrollment:	2412
Year Built:	1971
Modernization:	1996
Site Acreage:	42.0
# Portables:	4
Existing Parking:	± 628
Targeted Enrollment	2400

### UHS CAPACITY

86 Teaching Stations
+1 ASB
=87 Teaching Stations
12 DHH Teaching Stations

### PROPOSED SCOPE

- New Construction
- Reconfiguration
- Modernization
- New Site Work
- Demolition

## Project 3

### UTILIZATION LEGEND

- Classroom Clusters
- Science
- Business/Design/Engineering
- Special Ed (SDC/SH)
- DHH
- Physical Education
- Performing Arts/Multi Media
- ASB/Library/Student Union
- Portable (Color based on Program)
- Other Spaces

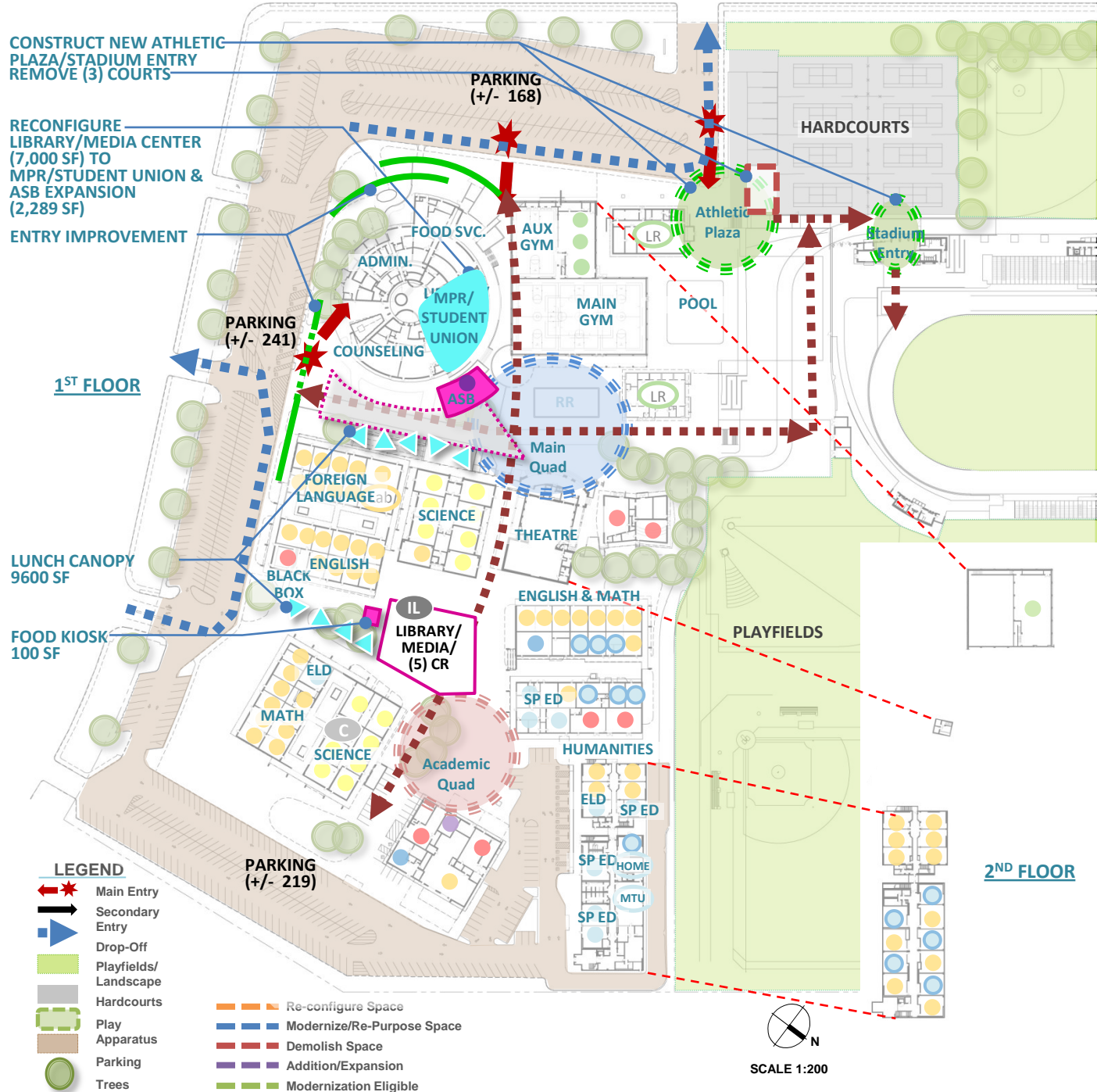

CONSTRUCT NEW ATHLETIC PLAZA/STADIUM ENTRY  
REMOVE (3) COURTS

RECONFIGURE LIBRARY/MEDIA CENTER (7,000 SF) TO MPR/STUDENT UNION & ASB EXPANSION (2,289 SF)

ENTRY IMPROVEMENT

1ST FLOOR

LUNCH CANOPY 9600 SF

FOOD KIOSK 100 SF

LEGEND

- Main Entry
- Secondary Entry
- Drop-Off
- Playfields/Landscape
- Hardcourts
- Play Apparatus
- Parking
- Trees

- Re-configure Space
- Modernize/Re-Purpose Space
- Demolish Space
- Addition/Expansion
- Modernization Eligible

SCALE 1:200

## SCHOOL STATISTICS

Grades:	9-12
2010/11 Enrollment:	2412
Year Built:	1971
Modernization:	1996
Site Acreage:	42.0
# Portables:	4
Existing Parking:	± 628
Targeted Enrollment	2400

## UHS CAPACITY

- 87 Teaching Stations
- 2 Teaching Stations (Music)
- +4 Teaching Stations (PA)
- +4 Teaching Stations (Tech Arts)
- =93 Teaching Stations

12 DHH Teaching Stations

## PROPOSED SCOPE

- New Construction
- Reconfiguration
- Modernization
- New Site Work
- Demolition

## Project 4

## UTILIZATION LEGEND

- Classroom Clusters
- Science
- Business/Design/Engineering
- Special Ed (SDC/SH)
- DHH
- Physical Education
- Performing Arts/Multi Media
- ASB/Library/Student Union
- Portable (Color based on Program)
- Other Spaces

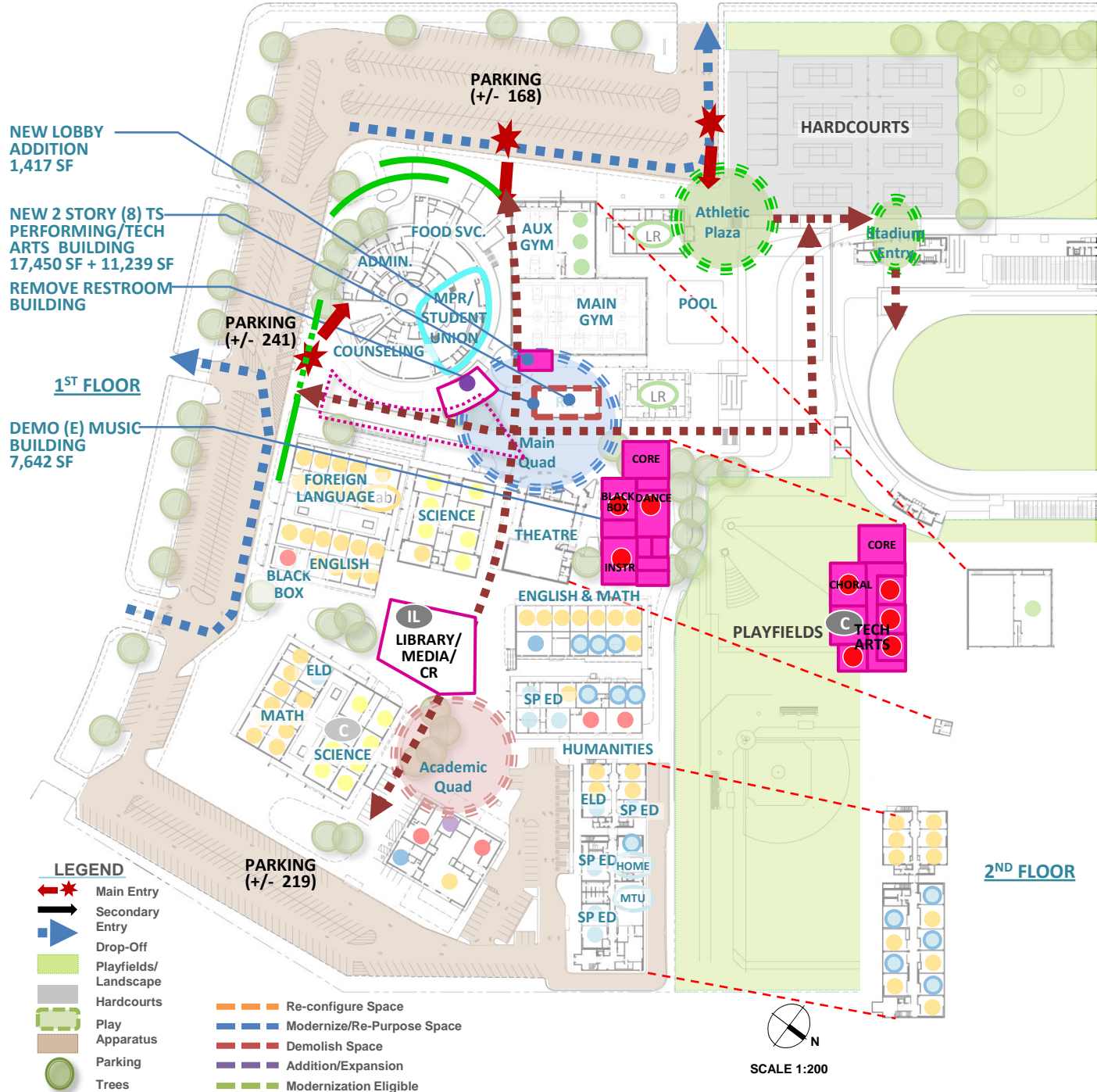

- NEW LOBBY ADDITION  
1,417 SF
- NEW 2 STORY (8) TS  
PERFORMING/TECH  
ARTS BUILDING  
17,450 SF + 11,239 SF
- REMOVE RESTROOM  
BUILDING
- 1ST FLOOR
- DEMO (E) MUSIC  
BUILDING  
7,642 SF

- ### LEGEND
- Main Entry
  - Secondary Entry
  - Drop-Off
  - Playfields/Landscape
  - Hardcourts
  - Play Apparatus
  - Parking
  - Trees

- Re-configure Space
- Modernize/Re-Purpose Space
- Demolish Space
- Addition/Expansion
- Modernization Eligible

SCALE 1:200

### SCHOOL STATISTICS

Grades:	9-12
2010/11 Enrollment:	2412
Year Built:	1971
Modernization:	1996
Site Acreage:	42.0
# Portables:	4
Existing Parking:	± 628
Targeted Enrollment	2400

### UHS CAPACITY

93 Teaching Stations  
 -8 Teaching Stations (Commons)  
 =85 Permanent Teaching Stations

12 DHH Teaching Stations

### PROPOSED SCOPE

- New Construction
- Reconfiguration
- Modernization
- New Site Work
- Demolition

## Project 5

### UTILIZATION LEGEND

- Classroom Clusters
- Science
- Business/Design/Engineering
- Special Ed (SDC/SH)
- DHH
- Physical Education
- Performing Arts/Multi Media
- ASB/Library/Student Union
- Portable (Color based on Program)
- Other Spaces

\*SAFETY ISSUE:  
CAMPUS WIDE OUTDOOR LIGHTING UPGRADE

\*LANDSCAPE UPGRADES  
THROUGHOUT

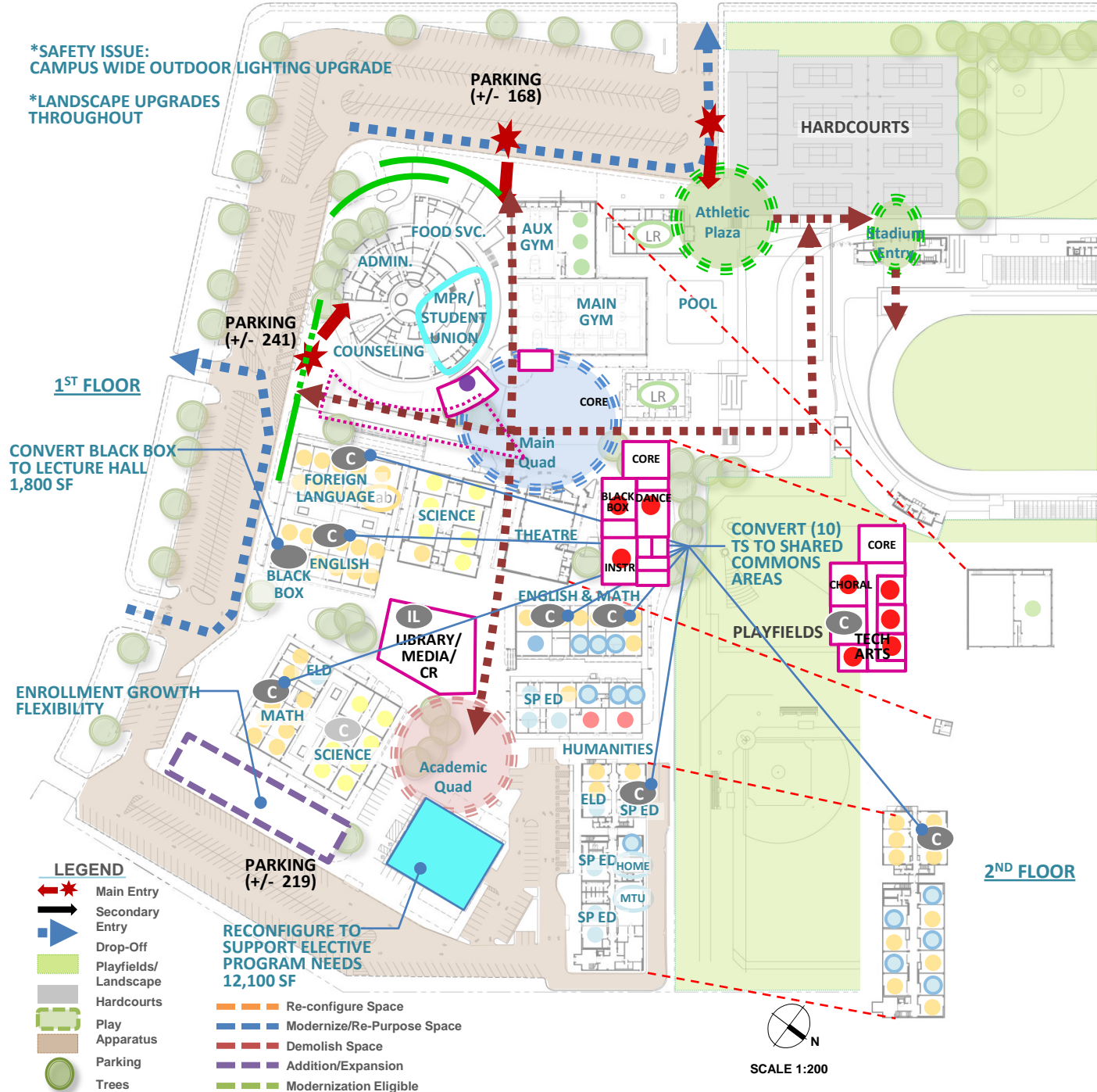

**1ST FLOOR**

**2ND FLOOR**

### LEGEND

- Main Entry
- Secondary Entry
- Drop-Off
- Playfields/Landscape
- Hardcourts
- Play Apparatus
- Parking
- Trees
- Re-configure Space
- Modernize/Re-Purpose Space
- Demolish Space
- Addition/Expansion
- Modernization Eligible

SCALE 1:200