

This School Site Facility Master Implementation Plan presents an overlay of the facility ed. specs. - approved by the USD Board, Nov. 2011 - onto the existing facility plan. The proposed facilities modifications and enhancements were reviewed by a school site committee; this plan reflects their input. It represents a 20-year vision for the school site, with phased implementation as funding is available. Once funding is determined for specific projects, further discussions with school site and district stakeholders will refine the design and details of the projects. The current approved ed. specs. will provide the framework for the design. The modifications shown here reflect a rough potential layout, to establish budgets; they are not intended to represent a final design. During the later detailed design phase, building, site, and funding constraints may require changes to this original plan.

YEAR BUILT:	2002
YEAR MODERNIZED:	(2027)
CURRENT ENROLLMENT:	853
EXISTING CLASSROOMS:	28 + 8 Portables
PROPOSED CLASSROOMS:	33 + 4 Portables

PROPOSED SCOPE

- Construct (2) new Kindergarten Classrooms; includes (1) dedicated for moderate/severe S.E. Kindergarten student population
- Re-purpose (1) Music Classroom to Design Lab
- Construct (1) New Music Room and Support Spaces
- Construct (3) dedicated classrooms for moderate/severe S.E. for 1-6 grade student population
- Re-purpose (1) Classroom to Occupational Therapy/ Focus Room
- Re-purpose (2) existing rooms for RSP
- Reconfigure (1) RSP, Offices into Learning Center space to support existing Student Support Services
- Upgrade Computer Lab area to Innovation Lab
- Remove (4) portables & relocate Child Care
- Expand Hardcourts
- General site upgrades to include Outdoor Learning courtyards

PROPOSED SCOPE

- NEW CONSTRUCTION
- RECONFIGURATION
- MODERNIZATION
- NEW SITE WORK
- DEMOLITION/REMOVAL/RELOCATE
- FUTURE ENROLLMENT GROWTH FLEXIBILITY

LEGEND

- ★** Main Entry
- Secondary Entry
- Drop-Off
- Playfields/Landscape
- Hardcourts
- Play Apparatus
- Parking
- Courtyard
- Trees

UTILIZATION LEGEND

- | | | |
|--|-----|------------------------|
| Kindergarten Classroom | K | Kindergarten |
| Classroom | # | Grade Level |
| Science/Design Lab | C | Collaboration Area |
| Specialty Classroom | AC | Kinder Activity Center |
| Special Ed Classroom | DL | Design Lab |
| Portable (Color based on Program) | M | Music |
| Restrooms | IL | Innovation Lab |
| Other Spaces | PC | Parent/Conf. Center |
| | LC | Learning Center |
| | SS | Student Support Svcs. |
| | RSP | Special Ed/Resource |
| | CC | Child Care (Portable) |

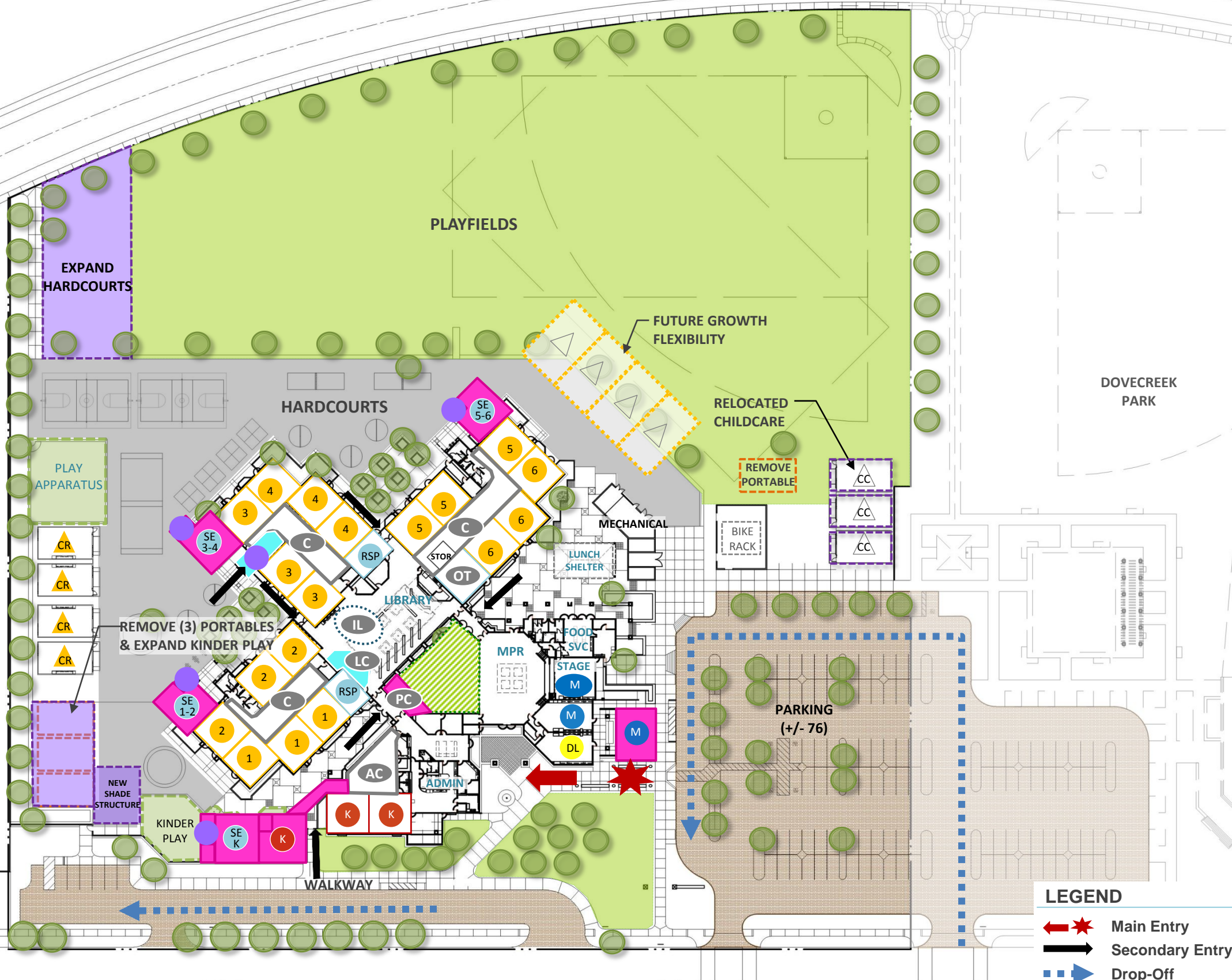

*Oak Creek Elementary School is a Regional Mod/Severe Special Ed Site

SCALE 1:80