

SCHOOL STATISTICS

Grades:	9-12
2010/11 Enrollment:	1948
Year Built:	1999
Modernization:	(2024)
Site Acreage:	40.0
# Portables:	4
Existing Parking:	636
Proposed Parking:	626
Parking Reduction:	10

CAPACITY

71 Standard Classrooms
+7 SDC
=78 Teaching Stations
+2 SDC/Living Skills
+8 Teaching Stations
=88 Teaching Stations

PROPOSED SCOPE

 New Construction
 Reconfiguration
 Modernization
 New Site Work
 Demolition

Project 1

UTILIZATION LEGEND

 Classroom Clusters
 Science
 Business/Design/Engineering
 Special Ed (SDC/SH)
 Physical Education
 Performing Arts/Multi Media
 ASB/Library/Student Union
 Portable (Color based on Program)
 Other Spaces

LEGEND

 	Main Entry
	Secondary Entry
	Drop-Off
	Playfields/Landscape
	Hardcourts
	Play Apparatus
	Parking
	Trees
	Re-configure Space
	Modernize/Re-Purpose Space
	Demolish Space
	Addition/Expansion
	Modernization Eligible

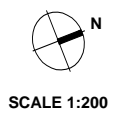

SCHOOL STATISTICS

Grades:	9-12
2010/11 Enrollment:	1948
Year Built:	1999
Modernization:	(2024)
Site Acreage:	40.0
# Portables:	4
Existing Parking:	636
Proposed Parking:	626
Parking Reduction:	10

CAPACITY

88 Teaching Stations
-4 Teaching Stations (Commons)
-1 Library Computer Lab
+1 Innovation Lab
=84 Teaching Stations

PROPOSED SCOPE

- New Construction
- Reconfiguration
- Modernization
- New Site Work
- Demolition

Project 2

UTILIZATION LEGEND

- Classroom Clusters
- Science
- Business/Design/Engineering
- Special Ed (SDC/SH)
- Physical Education
- Performing Arts/Multi Media
- ASB/Library/Student Union
- Portable (Color based on Program)
- Other Spaces

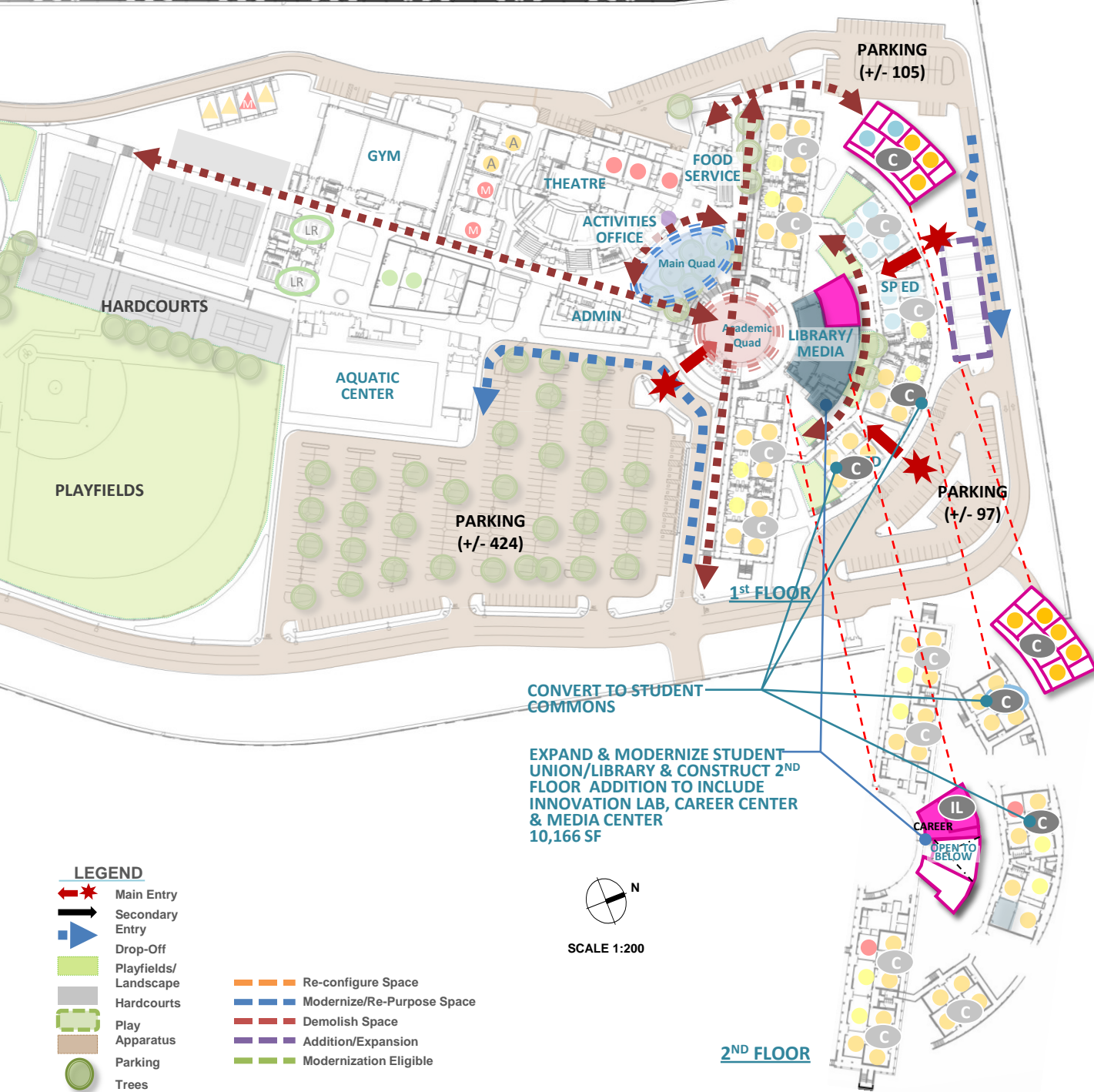

LEGEND

- Main Entry
- Secondary Entry
- Drop-Off
- Playfields/Landscape
- Hardcourts
- Play Apparatus
- Parking
- Trees
- Re-configure Space
- Modernize/Re-Purpose Space
- Demolish Space
- Addition/Expansion
- Modernization Eligible

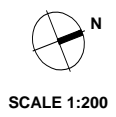

2ND FLOOR

SCHOOL STATISTICS

Grades:	9-12
2010/11 Enrollment:	1948
Year Built:	1999
Modernization:	(2024)
Site Acreage:	40.0
# Portables:	4
Existing Parking:	636
Proposed Parking:	626
Parking Reduction:	10

CAPACITY

84 Teaching Stations

PROPOSED SCOPE

- New Construction
- Reconfiguration
- Modernization
- New Site Work
- Demolition

Project 3

UTILIZATION LEGEND

- Classroom Clusters
- Science
- Business/Design/Engineering
- Special Ed (SDC/SH)
- Physical Education
- Performing Arts/Multi Media
- ASB/Library/Student Union
- Portable (Color based on Program)
- Other Spaces

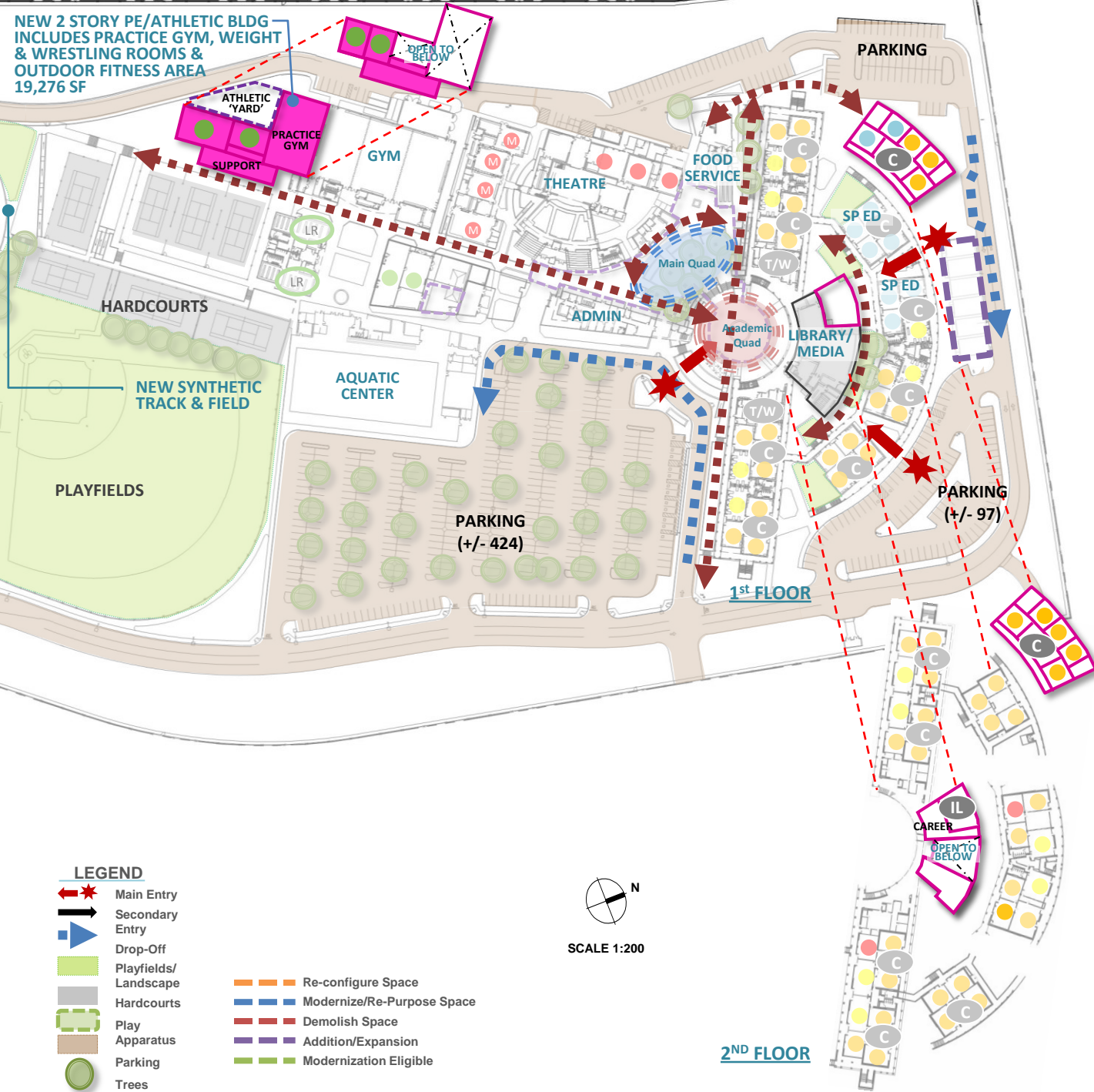

NEW 2 STORY PE/ATHLETIC BLDG
INCLUDES PRACTICE GYM, WEIGHT & WRESTLING ROOMS & OUTDOOR FITNESS AREA
19,276 SF

ATHLETIC 'YARD'
PRACTICE GYM
SUPPORT

GYM

THEATRE

FOOD SERVICE

PARKING

HARDCOURTS

NEW SYNTHETIC TRACK & FIELD

AQUATIC CENTER

ADMIN

Academic Quad

LIBRARY/MEDIA

SP ED

SP ED

PARKING (+/- 97)

PARKING (+/- 424)

1ST FLOOR

2ND FLOOR

CAREER

OPEN TO BELOW

LEGEND

- Main Entry
- Secondary Entry
- Drop-Off
- Playfields/Landscape
- Hardcourts
- Play Apparatus
- Parking
- Trees

- Re-configure Space
- Modernize/Re-Purpose Space
- Demolish Space
- Addition/Expansion
- Modernization Eligible

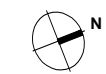

SCALE 1:200

**NEW LUNCH SHELTER (2,400 SF)
FOOD KIOSK AND LANDSCAPE
IMPROVEMENTS TO QUAD**

**EXPAND & RECONFIGURE BLDG TO
INCLUDE STUDENT SERVICES(3,219 SF),
(2) ART TS(2,394 SF) W/ ART COURT,
AND DANCE**

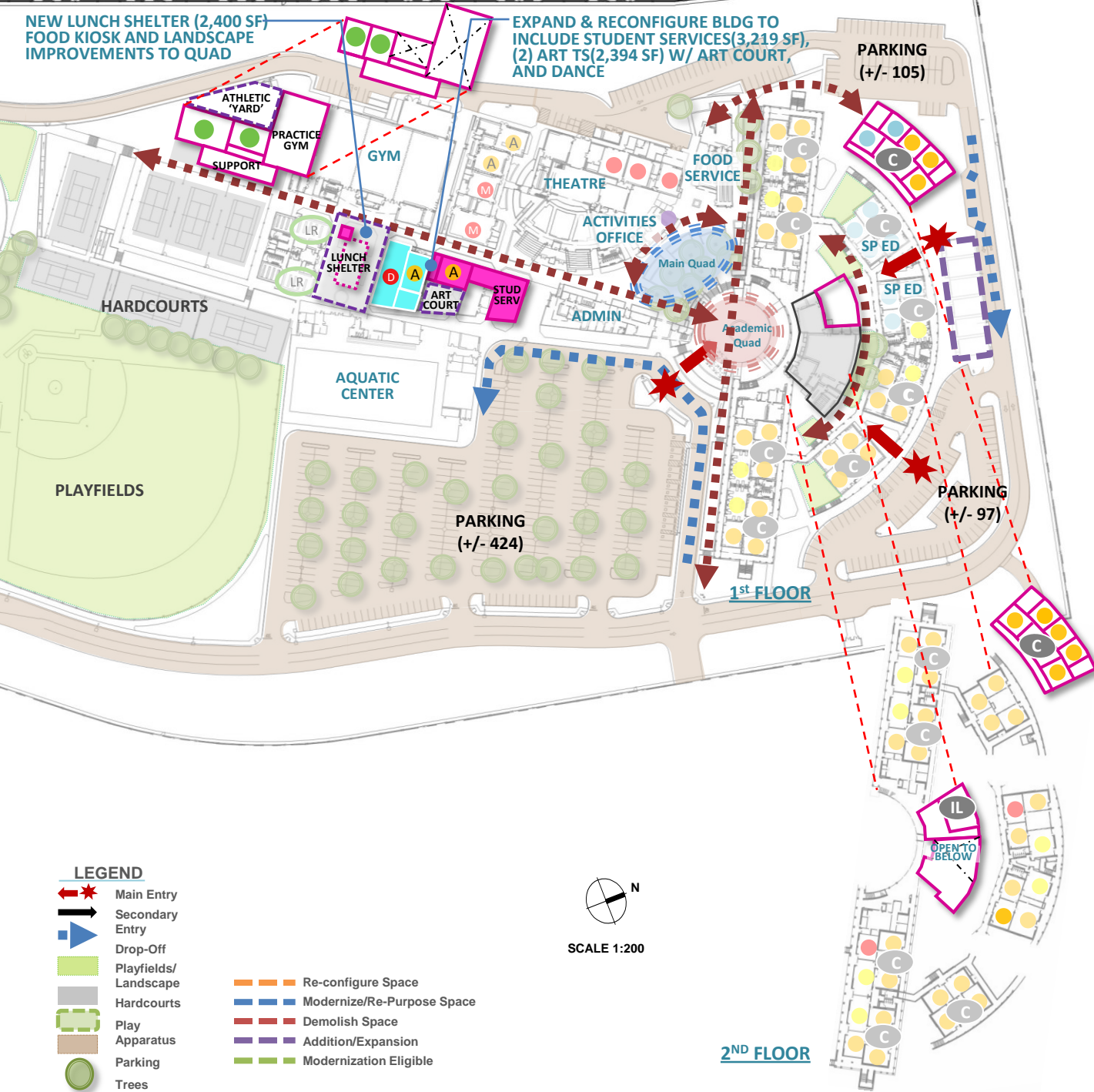

SCHOOL STATISTICS

Grades:	9-12
2010/11 Enrollment:	1948
Year Built:	1999
Modernization:	(2024)
Site Acreage:	40.0
# Portables:	4
Existing Parking:	636
Proposed Parking:	626
Parking Reduction:	10

CAPACITY

84 Teaching Stations
-2 NS Teaching Stations
+3 Teaching Stations
=85 Teaching Stations

PROPOSED SCOPE

- New Construction
- Reconfiguration
- Modernization
- New Site Work
- Demolition

Project 4

UTILIZATION LEGEND

- Classroom Clusters
- Science
- Business/Design/Engineering
- Special Ed (SDC/SH)
- Physical Education
- Performing Arts/Multi Media
- ASB/Library/Student Union
- Portable (Color based on Program)
- Other Spaces

LEGEND

- Main Entry
- Secondary Entry
- Drop-Off
- Playfields/ Landscape
- Hardcourts
- Play Apparatus
- Parking
- Trees
- Re-configure Space
- Modernize/Re-Purpose Space
- Demolish Space
- Addition/Expansion
- Modernization Eligible

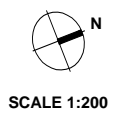

2ND FLOOR

SCHOOL STATISTICS

Grades:	9-12
2010/11 Enrollment:	1948
Year Built:	1999
Modernization:	(2024)
Site Acreage:	40.0
# Portables:	4
Existing Parking:	636
Proposed Parking:	616
Parking Reduction:	20

CAPACITY

85 Teaching Stations

PROPOSED SCOPE

- New Construction
- Reconfiguration
- Modernization
- New Site Work
- Demolition

Project 5

UTILIZATION LEGEND

- Classroom Clusters
- Science
- Business/Design/Engineering
- Special Ed (SDC/SH)
- Physical Education
- Performing Arts/Multi Media
- ASB/Library/Student Union
- Portable (Color based on Program)
- Other Spaces

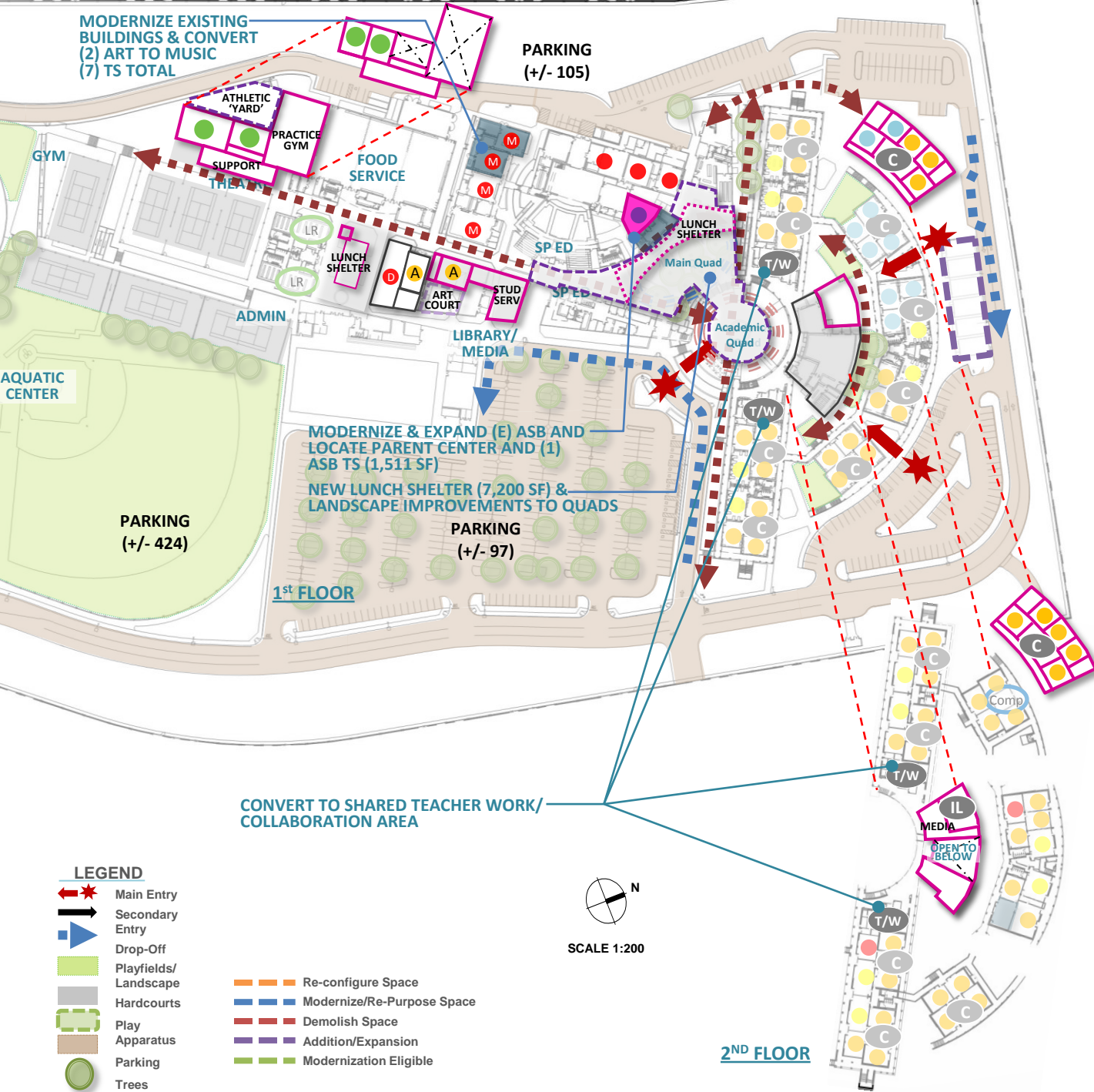

MODERNIZE EXISTING BUILDINGS & CONVERT (2) ART TO MUSIC (7) TS TOTAL

PARKING (+/- 105)

MODERNIZE & EXPAND (E) ASB AND LOCATE PARENT CENTER AND (1) ASB TS (1,511 SF)

NEW LUNCH SHELTER (7,200 SF) & LANDSCAPE IMPROVEMENTS TO QUADS

PARKING (+/- 424)

PARKING (+/- 97)

1ST FLOOR

2ND FLOOR

LEGEND

- Main Entry
- Secondary Entry
- Drop-Off
- Playfields/Landscape
- Hardcourts
- Play Apparatus
- Parking
- Trees

- Re-configure Space
- Modernize/Re-Purpose Space
- Demolish Space
- Addition/Expansion
- Modernization Eligible

