

CAMPUS OBSERVATIONS

Classrooms

- Classrooms have adequate space, and each room opens to common area
- Minimal daylighting in classrooms
- Sufficient number of permanent classrooms, particularly after restructuring classes into departments
- Classrooms have doors to access outside
- Music classroom too small to support number of students enrolled in class
- Special Education classrooms appear to be integrated throughout the campus

Library/ Media

- Adjacent to MPR and one classroom wing; not as convenient for other classroom wings and buildings
- Somewhat small, with no access to daylighting

- Have adequate number of computers to support one class; lack books due to funds

Food Service

- Is adequately-sized and functions well for its purpose
- Students queue outside with no shade or rain protection
- Food service has two (2) double-wide entries/ exits; exit feeds into central courtyard
- Removing planter bed near exit would improve flow of students into courtyard

Multi-Purpose Room

- Has resilient flooring rather than carpet
- Described as functioning well for current needs; could use microphones for stage during performances
- Cannot expand MPR space to another indoor/outdoor area when needed

- Stage cannot be used as separate classroom (no moveable partition, just curtains)

Admin & Support Spaces

- Main office is located toward front of school, but not at the end of the main pedestrian pathway (MPR resides there); does not stand out visually for visitors/newcomers
- Staff lounge lacks space and flexibility
- Each wing has a teacher workroom to support prep work

CAMPUS OVERVIEW

Rancho San Joaquin Middle School is a 7-8 seasonal school, situated in a residential setting. The school is directly adjacent to and south of the I-405, between Culver Drive and University Drive.

The main Administrative office is located at the front of the campus adjacent to the parking lot, along the main pathway that leads directly to the Multipurpose Room (MPR). Adjacent to the MPR is the Library, which is a somewhat small but inviting space. Also located on the Rancho campus is the District's Nutrition Services Department and Central Kitchen.

The three academic wings in the main building are each organized in pod configurations surrounding a central breakout/resource area with computers for student use. There are two additional classroom buildings, one at the front of the school and one near the hardcourts toward the back of the campus. There are also two portables used as classrooms.

Rancho San Joaquin is a California Distinguished School as well as a National Blue Ribbon School. In conjunction with its strong academic program, the school implements its *Rancho R.U.L.E.S.* positive behavior program, which encourages and rewards students who act with the following ideals in mind: **Respect, Unwavering Integrity, Leadership, Effort, and Social Responsibility**

Mission Statement: to enable all students to become contributing members of society empowered with the skills, knowledge, and values necessary to meet the challenges of a changing world, by providing the highest quality educational experience the school and its stakeholders can envision.



Rancho San Joaquin Middle School



4861 Michelson Drive | Irvine, CA 926
Site Analysis

General Condition

- General need for update of school, exterior façade and interior elements; some casework in need of replacement/repair
- Need for more daylighting/ natural lighting opportunities throughout the building

Building Systems

- HVAC is provided by multizone roof top units that were installed during 1999 modernization
- Ductwork is fiberboard and is leaky
- Site also has a kitchen and walk-in freezers that serve much of the district
- HVAC is controlled by a Carrier EMS
- Site has photovoltaic panels

Technology

- Library has computers to accommodate full class; computer areas exist outside classrooms in central pod; some classrooms have computers
- Computers require updating and/or replacement

Specialty Labs

- Read 180 Lab; Common Area computer labs, project based lab (formally wood shop)

Outdoor Areas

- Trees near playfields are very large and provide nice shade opportunities; aside from these trees, not many shade opportunities near hardcourts and playfields
- Central courtyard has lunch shade

structures and some trees near seatwalls for shade

Vehicular Access/ Parking/ Drop-Off

- Parking and drop-off described as adequate

LPA





SCHOOL STATISTICS

Grades:	7-8
Building SF:	67,884
Portable SF:	4,800
2010/11 Enrollment:	840
Year Built:	1972
Modernization:	2001
Site Acreage:	20.0
# Portables:	5

CLASSROOM COUNT

General Classroom (2 Portables)	17
Science	7
Art / Tech	2
Music*	1
Special Education	4
Physical Education	2
Computer Lab/Classroom	1
Open/Unused	2
TOTAL	36

**Also may use MPR for music*

MEASURES OF QUALITY -

MEASURES OF QUALITY -	+
Wayfinding/ Entry/ Welcome	○ ● ○ ○
Natural Daylighting	● ○ ○ ○
Controllability (Daylight, Lighting, HVAC)	○ ● ○ ○
Flexibility in Classrooms	○ ● ○ ○
Access to Technology	○ ● ○ ○
Collaboration	○ ● ○ ○
Student Display	○ ● ○ ○
MPR	○ ● ○ ○
Library/ Media	○ ● ○ ○
Functional Landscaping	○ ● ○ ○
Energy Consumption	○ ● ○ ○
General Condition	○ ● ○ ○



LEGEND

- Main Entry
- Secondary Entry
- Circulation
- Drop-Off
- Playfields/ Landscape
- Hardcourts
- Parking
- Trees

UTILIZATION LEGEND

- Classroom
- Science/ Art/ Tech Lab
- Specialty Classroom
- Special Ed Classroom
- Physical Education
- Portable (Color based on Program)
- Other Space
- CR Regular Classroom
- S Science
- A Art
- T Tech
- M Music
- C Commons
- PE Physical Education
- LR Locker Room
- RSP Special Ed/ Resource Program
- SE Special Education
- IPSPF Irvine Public Schools Foundation (Instrmt Rental)
- Comp. Computer Lab/Area
- Open Unused Classroom



1 Front of School



2 Front Entrance to Quad



3 Entry to Administration and MPR



4 Parking and Drop-Off



5 Entry to Portables and Hardcourts



6 Main Office Entrance



7 View of Outer Components of Central Kitchen



8 Nutrition Portable and Storage



KEY MAP



9 Basketball Courts



10 Hardcourts



11 Playfields



Food Service Queue



Service Windows



Sheltered Lunch Area



Outdoor Stage in Courtyard



Courtyard



Bike Racks



Main Office



Waiting Area



KEY MAP



Staff Lounge



Staff Workroom



Principal's Office





Assistant Principal's Office



Counselor's Office



Psychologist Office

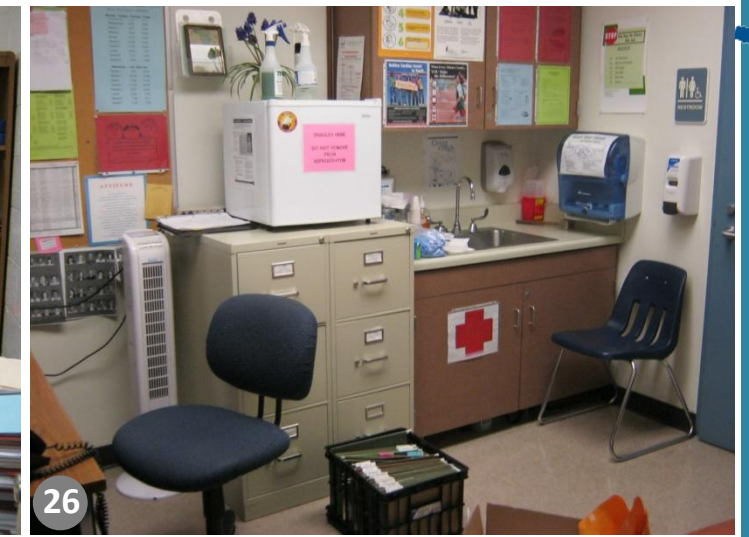

Health Office



MPR Stage



MPR Backstage



Library



Book Storage



KEY MAP



Food Service



Additional Food Serving Area



Central Kitchen



Central Kitchen Interior Freezers



Central Kitchen Exterior Freezers



Central Kitchen Office



Central Collaboration Space



Pod Workroom



Pod Conference Room



Computer Lab



Science Classroom



KEY MAP



Art Classroom



Music Classroom



Video Production



Woodshop

Typical Portable

Nutrition Services Portable

Instrument Rental Portable



Boy's Locker Room

Weight Room

Cardio Workout Room

Typical Bathroom

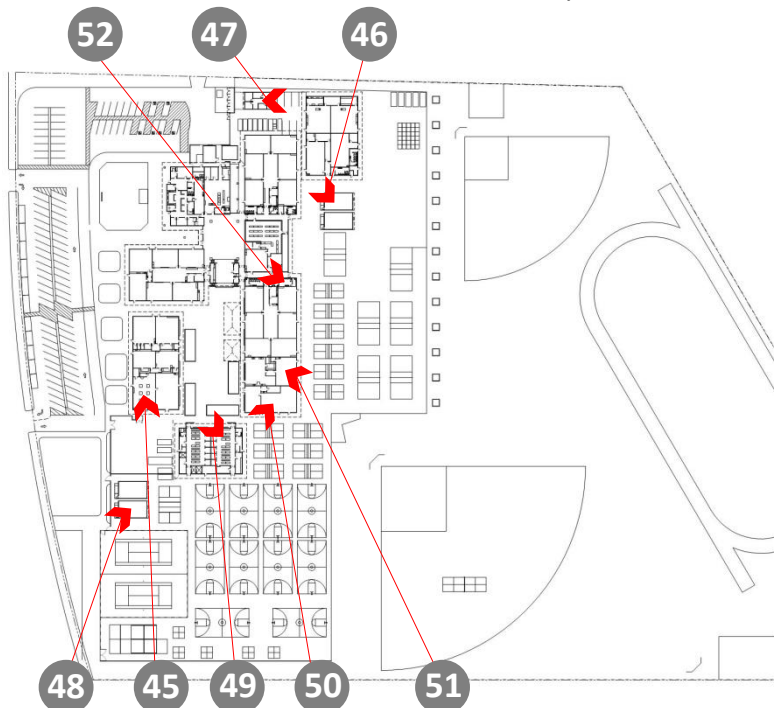

KEY MAP