



# Irvine Unified School District

## Measure E

### Citizens Oversight Committee Meeting

#### April 27, 2020

#### **Board of Education**

Paul Bokota  
Lauren Brooks  
Betty Carroll, President  
Ira Glasky  
Sharon Wallin



# AGENDA

- Budget
- State Funding
- Schedule
- Series 1 Project Updates
- Series 2 Project Updates
- AFAP Project Updates



# Budget



# CURRENT BOND FUNDS

<u>BOND FUNDS COMMITTED (Series 1 and 2)</u>	<u>\$136,000,000</u>
--	----------------------

- |   |               |
|---|---------------|
| • Series 1 Bond 2016A (received 10/26/2016) | \$ 95,000,000 |
| • Series 2 Bond 2018B (received 09/13/2018) | \$ 41,000,000 |



# CURRENT BOND AND DISTRICT FUNDS

<b>FUNDS COMMITTED (Series 1 and 2)</b>	<b>\$212,814,764</b>
• <b>Series 1 Funds</b>	<b>\$ 154,930,259</b>
Bond Series 2016A (Series 1)	\$ 95,000,000
Bond Series 2018B (Series 2)	\$ 13,115,495
District Funds (Funds 35, 40, 86-1, and LAN project)	\$ 42,143,875
State Grant (CTEFP)*	\$ 439,400
Rebate (IRWD)*	\$ 174,591
Fund 40 (Woodbridge HS Field Improvements)*	\$ 1,000,000
State Grant (CTEFP)*	\$ 3,000,000
Grant (TDP Grant for WHS Field Improvements)*	\$ 56,898
• <b>Series 2 Funds</b>	<b>\$ 27,884,505</b>
Bond Series 2018B (Series 2)*	\$ 27,884,505
• <b>AFAP Funds*</b>	<b>\$ 30,000,000</b>

\*Funds adjusted or added since June 5, 2018



# FUND SUMMARY / FORECASTED BUDGET (Series 1)

Adjustment (10/26/2016)	
Bond Series 1	\$ 95,000,000
IUSD Funds	\$ 29,600,000
IUSD Funds 1st Adj.	\$ 6,800,000
<b>FUNDS</b>	<b>\$ 131,400,000</b>

Adjustment (06/05/2018)	
Bond Series 1	\$ 95,000,000
IUSD Funds	\$ 29,600,000
IUSD Funds 1st Adj.	\$ 6,800,000
IUSD Funds 2nd Adj.	\$ 5,100,000
IUSD IT Infrastructure	\$ 643,875
CTE Grant (CHS)	\$ 348,920
Bond Series 2	\$ 13,115,495
<b>FUNDS Approved</b>	<b>\$ 150,608,290</b>

Current (04/27/2020)	
Bond Series 1	\$ 95,000,000
IUSD Funds	\$ 29,600,000
IUSD Funds 1st Adj.	\$ 6,800,000
IUSD Funds 2nd Adj.	\$ 5,100,000
IUSD IT Infrastructure	\$ 643,875
CTE Grant (CHS)	\$ 439,400
Bond Series 2	\$ 13,115,495
IRWD Rebate (NHS)	\$ 174,591
Fund 40 to WHS Field	\$ 1,000,000
CTE Grant (WHS)	\$ 3,000,000
TDP Grant (WHS)	\$ 56,898
<b>FUNDS Available</b>	<b>\$ 154,930,259</b>
<b>CURRENT BUDGET</b>	<b>\$ 150,836,437</b>
<b><i>SURPLUS FUNDS</i></b>	<b><i>\$ 4,093,822</i></b>



# CURRENT PROJECT BUDGETS (Series 1)

- **Enclose Classrooms (6 schools)** \$ 13,354,406  
Bonita Canyon ES, College Park ES, Culverdale ES,  
Greentree ES, Santiago Hills ES, Stone Creek ES
- **High School Modernizations (2 schools)** \$ 11,550,323  
Irvine HS, University HS
- **Expansions (2 schools)** \$ 11,164,999  
Eastshore ES, Creekside HS
- **Elementary School Modernizations (4 schools)** \$ 46,360,048  
Brywood ES, Meadow Park ES, Springbrook ES, Westpark ES
- **High School Field Improvements (2 schools)** \$ 6,667,008  
Northwood HS, Woodbridge HS



# CURRENT PROJECT BUDGETS (Series 1)

*-continued-*

• <b>Middle School Science Classrooms (5 schools)</b> Lakeside MS, Rancho San Joaquin MS, Sierra Vista MS, South Lake MS, Venado MS	\$ 21,929,077
• <b>New Theater (1 school)</b> Woodbridge HS	\$ 27,910,257
• <b>Music Classroom Buildings (3 schools)</b> Brywood ES, Meadow Park ES, Springbrook ES	\$ 9,757,653
• <b>Interim Campuses (2 schools)</b> El Camino, Westwood Basics	\$ 1,642,666
• <b>Program Costs</b>	\$ 500,000
<hr/>	
<b>TOTAL PROGRAM BUDGET</b>	<b>\$ 150,836,437</b>





# CONSTRUCTION CHANGE ORDERS (Series 1)



## Final Change Order Percentages

School		Original Contract	Final Contract	Change Orders	Change Order %	School		Original Contract	Final Contract	Change Orders	Change Order %
1	Bonita Canyon ES	\$ 687,833	\$ 661,920	\$ (25,913)	-3.77%	12	Lakeside MS	\$ 2,279,702	\$ 2,214,866	\$ (64,836)	-2.84%
2	College Park ES	\$ 1,947,472	\$ 1,997,707	\$ 50,235	2.58%	13	Rancho San Joaquin MS	\$ 4,201,968	\$ 4,102,266	\$ (99,702)	-2.37%
3	Culverdale ES	\$ 1,004,045	\$ 1,020,602	\$ 16,557	1.65%	14	Westpark ES	\$ 7,535,025	\$ 7,612,852	\$ 77,827	1.03%
4	Greentree ES	\$ 1,263,711	\$ 1,240,335	\$ (23,376)	-1.85%	15	Brywood ES - Mod	\$ 8,022,047	\$ 8,634,679	\$ 612,632	7.64%
5	Santiago Hills ES	\$ 1,053,407	\$ 1,050,915	\$ (2,492)	-0.24%	16	Brywood ES - Music	\$ 2,842,214	\$ 2,773,341	\$ (68,873)	-2.42%
6	Stone Creek ES	\$ 3,155,560	\$ 3,113,229	\$ (42,331)	-1.34%	17	Meadow Park ES - Mod	\$ 9,640,387	\$ 9,856,858	\$ 216,471	2.25%
7	Northwood HS	\$ 2,946,419	\$ 3,055,203	\$ 108,784	3.69%	18	Meadow Park ES - Music	\$ 2,889,679	\$ 2,838,289	\$ (51,390)	-1.78%
8	Irvine HS	\$ 4,704,255	\$ 4,843,227	\$ 138,972	2.95%	19	Eastshore ES	\$ 4,522,529	\$ 4,597,990	\$ 75,461	1.67%
9	University HS	\$ 3,533,004	\$ 3,519,126	\$ (13,878)	-0.39%	20	Venado MS	\$ 3,798,615	\$ 3,813,274	\$ 14,659	0.39%
10	Sierra Vista MS	\$ 3,643,560	\$ 3,526,896	\$ (116,664)	-3.20%	21	Creekside HS	\$ 3,681,144	\$ 3,598,072	\$ (83,072)	-2.26%
11	South Lake MS	\$ 2,753,376	\$ 2,688,937	\$ (64,439)	-2.34%	TOTALS		\$76,105,952	\$76,760,584	\$ 654,632	0.86%

# BUDGET COMPARISONS (Series 1)



Completed Projects		[A]	[B]	[C]	[D]
		Initial Budget	Post-Bid Budget	Final Budget	Post-Bid & Final Budget Variance [B-C]
1	Bonita Canyon ES - Enclosed Classrooms	\$ 400,384 <sup>1</sup>	\$ 912,184 <sup>3</sup>	\$ 868,451 <sup>7</sup>	\$ 43,733
2	Culverdale ES - Enclosed Classrooms	\$ 2,595,000 <sup>1</sup>	\$ 1,633,771 <sup>3</sup>	\$ 1,601,117 <sup>7</sup>	\$ 32,654
3	Greentree ES - Enclosed Classrooms	\$ 3,306,432 <sup>1</sup>	\$ 2,042,302 <sup>3</sup>	\$ 1,913,892 <sup>7</sup>	\$ 128,410
4	Northwood HS - Field Improvements	\$ 3,121,000 <sup>1</sup>	\$ 3,815,212 <sup>5</sup>	\$ 3,692,908 <sup>8</sup>	\$ 122,304
5	Santiago Hills ES - Enclosed Classrooms	\$ 1,523,080 <sup>1</sup>	\$ 1,498,668 <sup>3</sup>	\$ 1,427,186 <sup>7</sup>	\$ 71,482
6	Stone Creek ES - Enclosed Classrooms/Expansion	\$ 3,260,191 <sup>3</sup>	\$ 4,423,481 <sup>4</sup>	\$ 4,295,488 <sup>8</sup>	\$ 127,993
7	College Park ES - Enclosed Classrooms	\$ 4,724,600 <sup>1</sup>	\$ 3,424,256 <sup>3</sup>	\$ 3,248,272 <sup>9</sup>	\$ 175,984
8	Irvine HS - Modernization	\$ 3,306,432 <sup>3</sup>	\$ 7,143,636 <sup>5</sup>	\$ 6,922,265 <sup>9</sup>	\$ 221,371
9	University HS - Modernization	\$ 5,067,809 <sup>3</sup>	\$ 5,002,422 <sup>5</sup>	\$ 4,628,058 <sup>9</sup>	\$ 374,364
10	Westwood Basics Interim	\$ 955,950 <sup>2</sup>	\$ 509,966 <sup>5</sup>	\$ 411,938 <sup>9</sup>	\$ 98,028
11	Lakeside MS - Science Labs	\$ 1,428,000 <sup>1</sup>	\$ 1,665,889 <sup>3</sup>	\$ 2,892,181 <sup>9</sup>	\$ (1,226,292)
12	Rancho San Joaquin MS - Science Labs	\$ 5,736,800 <sup>1</sup>	\$ 6,484,732 <sup>3</sup>	\$ 5,289,332 <sup>9</sup>	\$ 1,195,400
13	South Lake MS - Science Labs	\$ 2,052,403 <sup>1</sup>	\$ 2,525,599 <sup>3</sup>	\$ 3,557,805 <sup>9</sup>	\$ (1,032,206)
TOTALS		\$ 37,478,081	\$ 41,082,118	\$ 40,748,893	\$ 333,225

## COC Report Dates

1: 1/9/2017 | 2: 4/10/2017 | 3: 7/24/2017 | 4: 4/23/2018 | 5: 7/23/2018 | 6: 1/28/2019 | 7: 7/22/2019 | 8: 10/28/2019 | 9: 4/27/2020

# FUND SUMMARY / FORECASTED BUDGET (Series 2)

- **Series 2 Projects**
  - Group 1 (Bonita Canyon ES and Turtle Rock ES) Bids due 5/14/2020
  - Group 1 Post-Bid Budgets will be complete in June 2020
  - Group 2 (Northwood ES and University Park ES) Bids due late 2020 / early 2021

Initial Budget (01/09/2019)			Current Initial Budget (07/22/2019)		
Bond Series 2	\$	41,000,000	Bond Series 2	\$	41,000,000
Funds Transferred to Series 1	\$	(13,115,495)	Funds Transferred to Series 1	\$	(13,115,495)
IUSD Funds	\$	-	IUSD Funds	\$	-
<b>FUNDS</b>	<b>\$</b>	<b>27,884,505</b>	<b>FUNDS</b>	<b>\$</b>	<b>27,884,505</b>
<b>CURRENT BUDGET</b>	<b>\$</b>	<b>25,600,730</b>	<b>CURRENT BUDGET</b>	<b>\$</b>	<b>29,203,295</b>
<b><i>SURPLUS FUNDS</i></b>	<b>\$</b>	<b>2,283,775</b>	<b><i>OVER FUNDS Available</i></b>	<b>\$</b>	<b>(1,318,790)</b>



# FUNDING TIMELINE

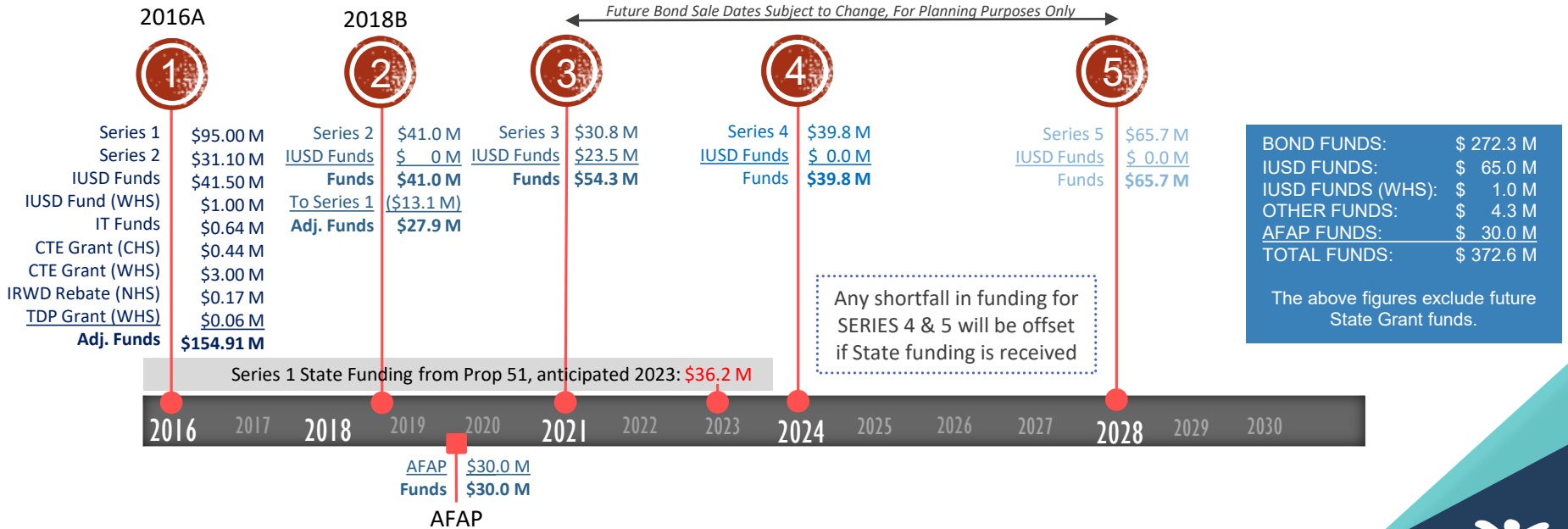

# State Funding



# STATE FUNDING - MEASURE E PROJECTS

- **Availability of State Funds for Measure E**
  - **Proposition 51** – funds still available
    - Approximately \$36M in the queue to receive funds
  - **Proposition 13** (The Public School, K-12, and College Health and Safety Bond Act of 2020)
    - Did not pass on March 3, 2020
  - **Future Statewide Bonds** - needed
    - Approximately \$800K submitted but will not be funded by Proposition 51
    - Approximately \$14M future applications to be submitted



# STATE FUNDING – MEASURE E PROJECTS



## GROUP 1: STATE FUNDED PROJECTS (Prop. 51)

Site Name	Amount Received
Creekside High School (CTEFP: Construction Technology)	\$439,400
Woodbridge High School (CTEFP: Performing Arts Center)	\$3,000,000
<b>Total State Funded Applications</b>	<b>\$3,439,400</b>

## GROUP 3: OPSC BEYOND AUTHORITY LIST (Future State Bond)

Site Name	Estimated Funding
Bonita Canyon ES (Series I: MOD)	\$152,715
Greentree ES (Series I: MOD)	\$249,055
Lakeside MS (Series I: MOD)	\$435,346
<b>Total State Funding Applications</b>	<b>\$837,116</b>

## GROUP 4: FUTURE SUBMITTALS (Future State Bond)

Site Name	Estimated Funding
Northwood ES (Series II: NC)	\$914,775
Northwood ES (Series II: MOD)	\$1,062,530
South Lake MS (Series II: MOD)	\$3,772,153
South Lake MS (Series II: NC)	\$348,327
Turtle Rock (Series II: NC)	\$914,775
University Park ES (Series II: MOD)	\$503,767
Woodbridge HS (Series II: MOD)	\$6,736,026
<b>Total State Funding Applications</b>	<b>\$14,252,353</b>

## GROUP 2: OPSC WORKLOAD LIST (Prop. 51)

Site Name	Estimated Funding
Santiago Hills ES (MOD)	\$335,448
College Park ES (MOD)	\$470,630
Culverdale ES (MOD)	\$597,498
Stone Creek ES (MOD)	\$1,411,210
Stone Creek ES (NC)	\$681,602
Irvine HS (MOD)	\$3,874,257
University HS (MOD)	\$654,092
Creekside HS (NC)	\$1,579,717
Sierra Vista MS (NC)	\$1,572,100
South Lake MS (NC)	\$870,227
Eastshore ES (MOD)	\$694,305
Springbrook ES (MOD)	\$3,097,577
Westpark ES (MOD)	\$3,415,758
Eastshore ES (NC)	\$835,854
Venado MS (NC)	\$2,231,969
Rancho San Joaquin MS (MOD)	\$543,617
Rancho San Joaquin MS (NC)	\$1,108,967
Brywood ES (MOD)	\$2,870,668
Woodbridge HS (NC)	\$3,041,419
Springbrook ES (NC)	\$1,626,156
Meadow Park ES (NC)	\$1,149,109
Brywood ES (NC)	\$1,094,082
Meadow Park ES (MOD)	\$2,526,142
<b>Total State Funding Applications</b>	<b>\$36,282,404</b>

# Schedule





# COVID-19 PANDEMIC IMPACTS

- **Executive Order N-33-20 Issued on March 19, 2020**
  - **Projects Under Construction**
    - Affected businesses – some temporarily ceased operations, limited work force, or instituted work from home approach
    - No significant impact to construction completion dates
  - **Projects In Design**
    - Affected businesses – some temporarily ceased operations, limited work force, or instituted work from home approach
    - Affected the Division of State Architect - instituted work from home approach
    - Slight impact to projects
      - Northwood ES combined with University Park ES – construction starts in 2021
      - Bonita Canyon ES and Turtle Rock ES bid date moved out to May 14, 2020



# CURRENT SCHEDULE (Series 1, Series 2, AFAP)



2020

2021

2022

## Woodbridge HS – Performing Arts Center

Construction

Summer 2020

**SERIES 1**

## Springbrook ES – Modernization / Music Classroom

Construction

Summer 2020

## Woodbridge HS – Field Improvements

Spring 2020

## Bonita Canyon ES and Turtle Rock ES

Bid

Construction

Summer 2021

**SERIES 2**

## Northwood ES and University Park ES

Design / DSA

Bid

Construction

Summer 2022

## South Lake MS and Woodbridge HS

DSA approved, waiting on Series 3 Bond Sale

## Canyon View ES, Deerfield ES, Oak Creek ES and Plaza Vista School

Design / DSA

Bid

Construction

Summer 2022

**AFAP**

## Irvine HS

Design / DSA

Once approved by DSA, wait on Series 3 Bond Sale

# OVERVIEW (Series 1)

2017 (4)	2018 (6)	2019 (9)	2020 (2)
<ul style="list-style-type: none"><li>• Bonita Canyon ES</li><li>• Culverdale ES</li><li>• Greentree ES</li><li>• Santiago Hills ES</li></ul>	<ul style="list-style-type: none"><li>• College Park ES</li><li>• Stone Creek ES</li><li>• Lakeside MS</li><li>• Irvine HS</li><li>• Northwood HS</li><li>• University HS</li></ul>	<ul style="list-style-type: none"><li>• Brywood ES</li><li>• Eastshore ES</li><li>• Meadow Park ES</li><li>• Westpark ES</li><li>• Rancho San Joaquin MS</li><li>• Sierra Vista MS</li><li>• South Lake MS</li><li>• Venado MS</li><li>• Creekside HS</li></ul>	<ul style="list-style-type: none"><li>• Woodbridge HS (Field Improvements)</li><li>• <i>Springbrook ES*</i></li><li>• <i>Woodbridge HS (PAC)*</i></li></ul>

\* Under construction, complete summer 2020



# Series 1 Project Updates: Under Construction

- Woodbridge HS
- Springbrook ES





Main entrance, ticketing booth in foreground

First floor lobby, stairs to second floor







Second floor walkway

Second floor seating looking towards stage





Mid-field looking northeast

Visitor team side looking south





# WOODBIDGE HS (Field Improvements)



Visitor team side looking east

Home team side looking south







Classroom (typical)

Collaboration space





Administration Office

Innovation Lab



# SPRINGBROOK ES (New Classroom Building)



Music classroom building

Music classroom building





Music classrooms

Music classroom





# Series 2 Project Updates: In Design

- Bonita Canyon ES
- Turtle Rock ES
- Northwood ES
- University HS



# BONITA CANYON ES (New Multipurpose Building)



Multipurpose building exterior



Multipurpose room



Design lab

Design lab



# TURTLE ROCK ES (New Classroom Building)\*



\* Similar design as Springbrook ES new classroom building



# NORTHWOOD ES (New Classroom Building)\*



\* Similar design as Springbrook ES new classroom building

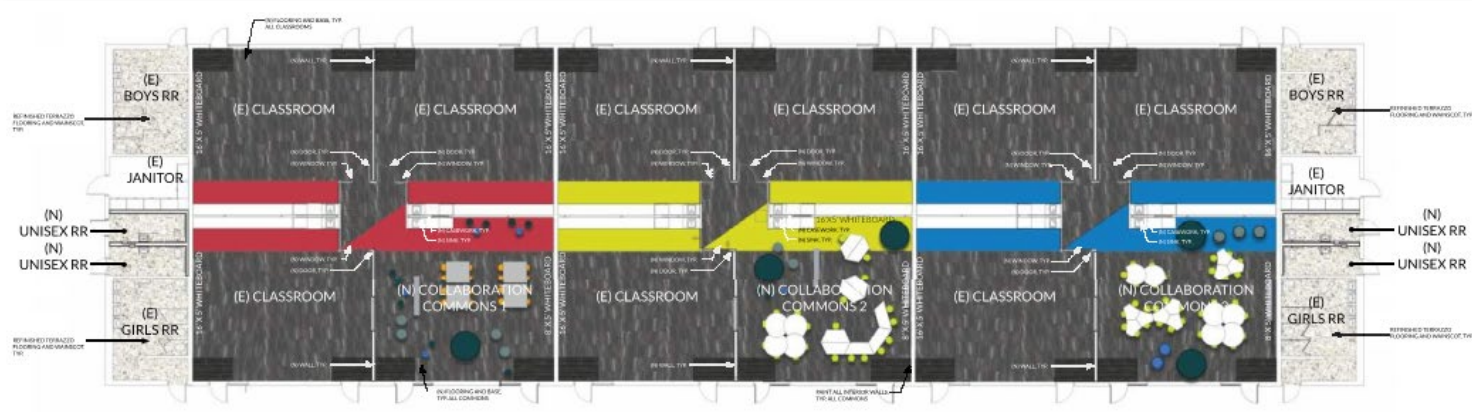

Building E Design Lab

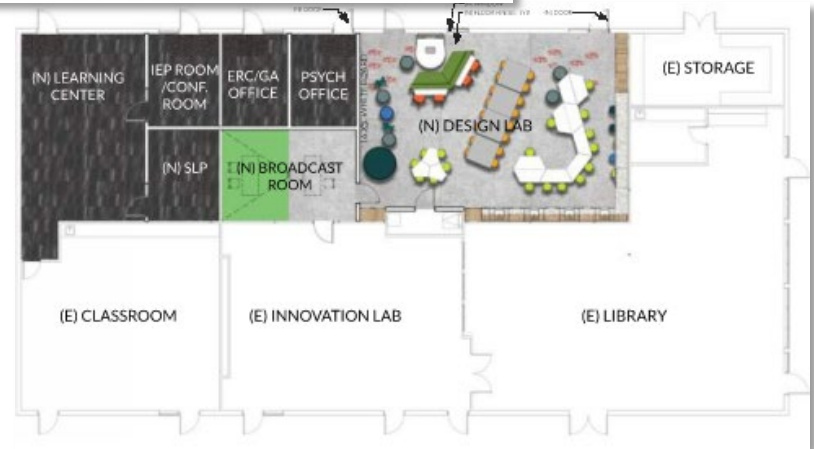

# Augmented Funds to Accelerate Projects (AFAP) in Design

- Canyon View ES
- Deerfield ES
- Oak Creek ES
- Plaza Vista School
- Irvine HS



# AFAP DESIGN PHASE UPDATES

- **Canyon View ES – Music Classroom Expansion / Design Lab Relocation**
  - Hired architect
  - Discussed options with Principal and staff
- **Oak Creek ES – New Music Classroom / New Lunch Shelter**
  - Hired architect
  - Discussed options with Principal and staff
- **Deerfield ES– New Classroom Building / Food Service Expansion**
  - Hired architect
- **Plaza Vista School – New Classroom Building / Kindergarten Renovation**
  - Hired architect
- **Irvine HS – Performing Arts Complex**
  - Hired architect
  - Reviewing options with Principal and staff



-



- **Options**

- One of several options being discussed

- **Schedule**

- Design complete late 2020
- Division of State Architect approval early 2021
- Construction start summer 2021
- Construction complete summer 2022

Option A  
Music/Choir Lab/Stage

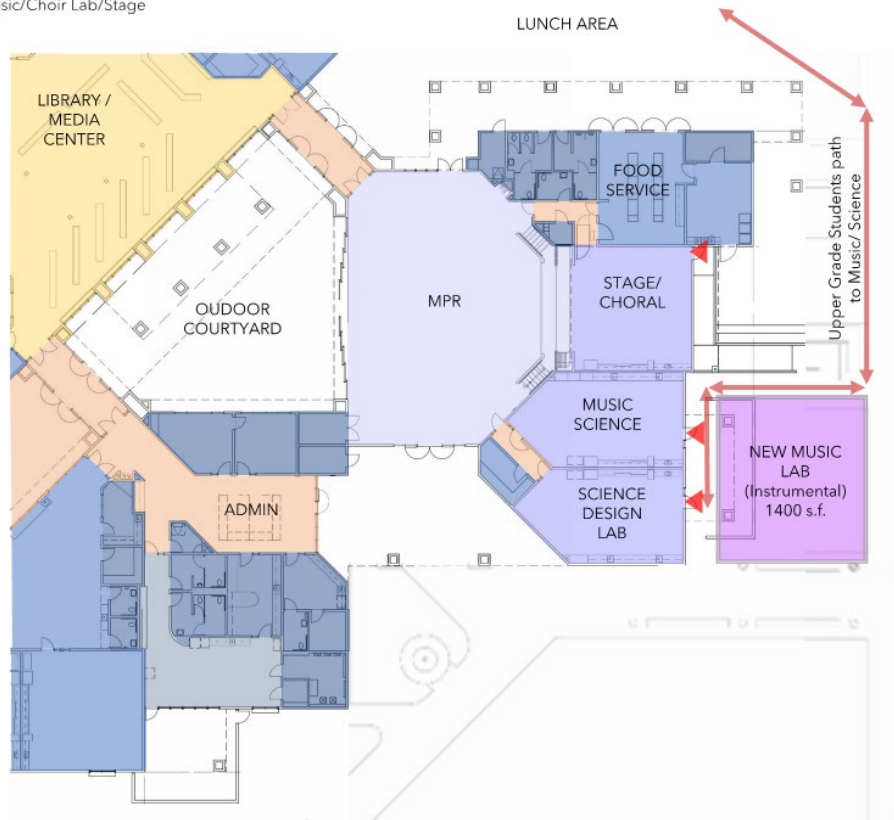



# UPCOMING EVENTS

- **Measure E Study Session**

- Tuesday, June 2, 2020
- 3:30 pm to 5:00 pm
- Board Room (tentative)

- **COC Meeting**

- ~~Tuesday~~ **Monday**, July 27, 2020
- 6:30 pm to 8:30 pm
- Woodbridge HS Performing Arts Complex (tentative)





*QUESTIONS?*