



Irvine Unified School District

Special Board Meeting Portola High School Confirmational Sampling

March 22, 2016

Board of Education

Paul Bokota, President

Ira Glasky

Lauren Brooks

Michael Parham

Sharon Wallin



- Portola High School Progress Video

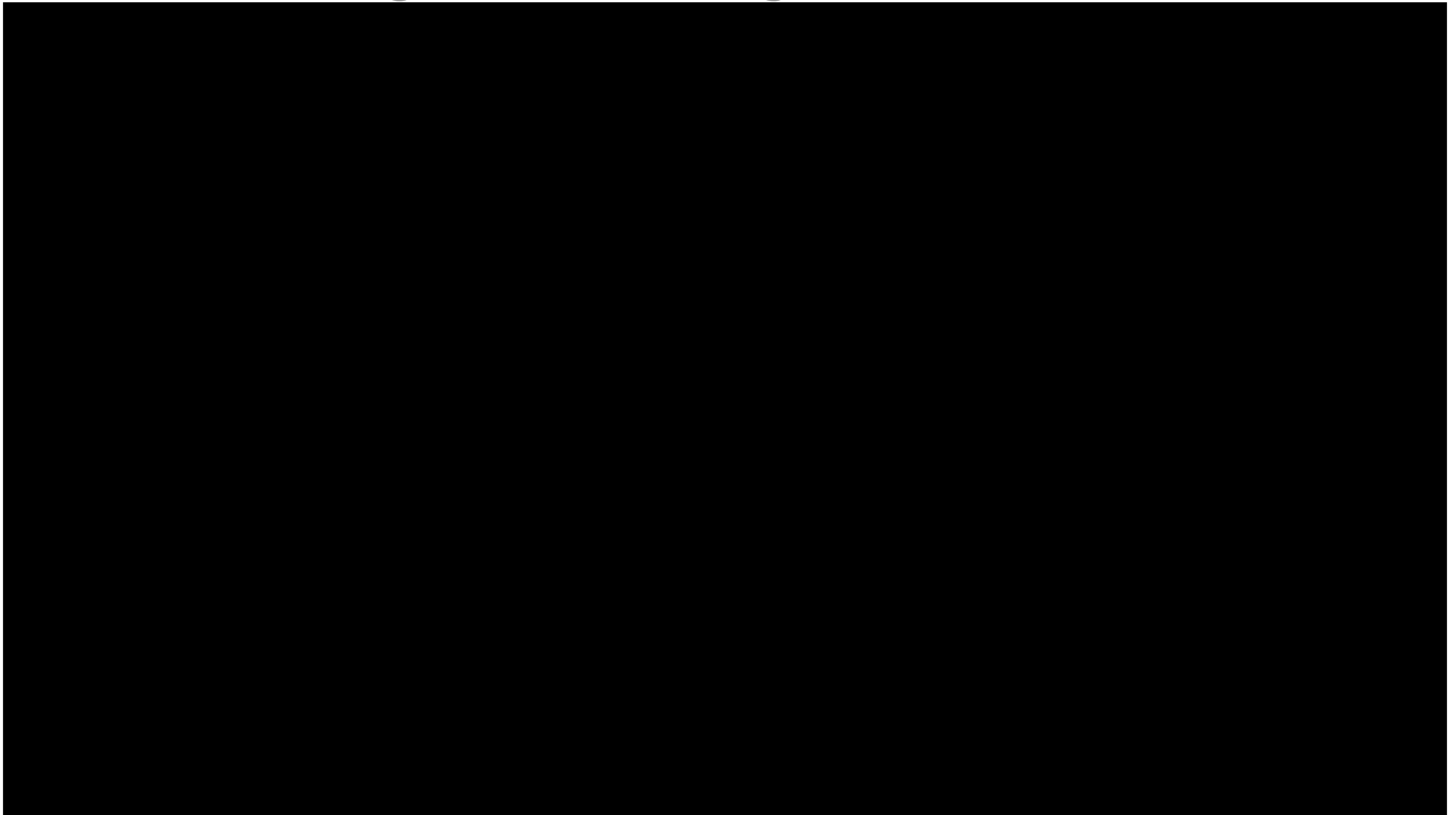



Agenda

- Introductions
- Overview
- Acronyms
- Environmental Approval
- Stained Soil
- DTSC Notification
- Draft Workplan
- Remaining Schedule



Introductions

Irvine Unified School District

- Kelvin Okino, Executive Director Facilities, Planning and Const.
- Lorrie Ruiz, Director Facilities and Planning

Department of Toxic Substances Control

- Dot Lofstrom, PG, Division Chief & Acting Deputy Director
- Dan Gallagher, PG, CHG, Senior Engineering Geologist
- Yolanda Garza, Unit Chief
- Russ Edmondson, Information Officer

PlaceWorks

- Dwayne Mears, Principal
- Denise Clendening, PhD, Associate Principal

Atkinson, Andelson, Loya, Rudd & Romo

- Terry Tao, Partner



Overview

Public Meeting

- Department of Toxic Substances Control
 - Dot Lofstrom PG, Division Chief & Acting Deputy Director
 - Background
 - Purpose



Overview

Portola High School – Site Orientation



Portola High School Confirmational Sampling



Acronyms

Definition

- CDE: California Department of Education
- DTSC: Department of Toxic Substances Control
- PEA: Preliminary Environmental Assessment
- SG: Soil Gas Sampling
- SSI: Supplemental Site Investigation
- VOC: Volatile Organic Compound



Environmental Approval

Environmental Assessment Timeline

- Dec. 19, 2012: Phase1 Report
 - Review of Site History and Base Closure Activities
- Sep. 3, 2013: Scoping Meeting
 - Attended by:
 - DTSC Office of Military Facilities
 - DTSC Schools Program
 - Consultants involved in Base closure and remediation
 - Irvine USD Personnel
 - Developed sampling plan based on site history
- **Dec. 4, 2013: Draft PEA Workplan Approval**
 - PEA Workplan approved to proceed with site investigation
- **Apr. 4, 2014: DTSC Approval of PEA**
 - No further assessment needed



Phase 1 Report

Portola High School Site

- Former Fuel Lines
- Active Storm Drain Line
- Agricultural Use
- Flight Path
- Soil Stockpiles



Phase 1 Report

Adjacent to Portola High School Site

- Capped Landfill
- Former Fuel Lines
- Former Underground Storage Tanks
- Active Storm Drain Lines
- Groundwater Plume

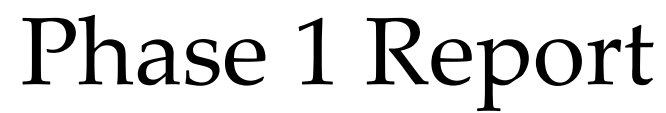

Source: Earth Tech 2003; U.S. Department of the Navy 2004.



PEA Workplan - Soil Gas Sampling

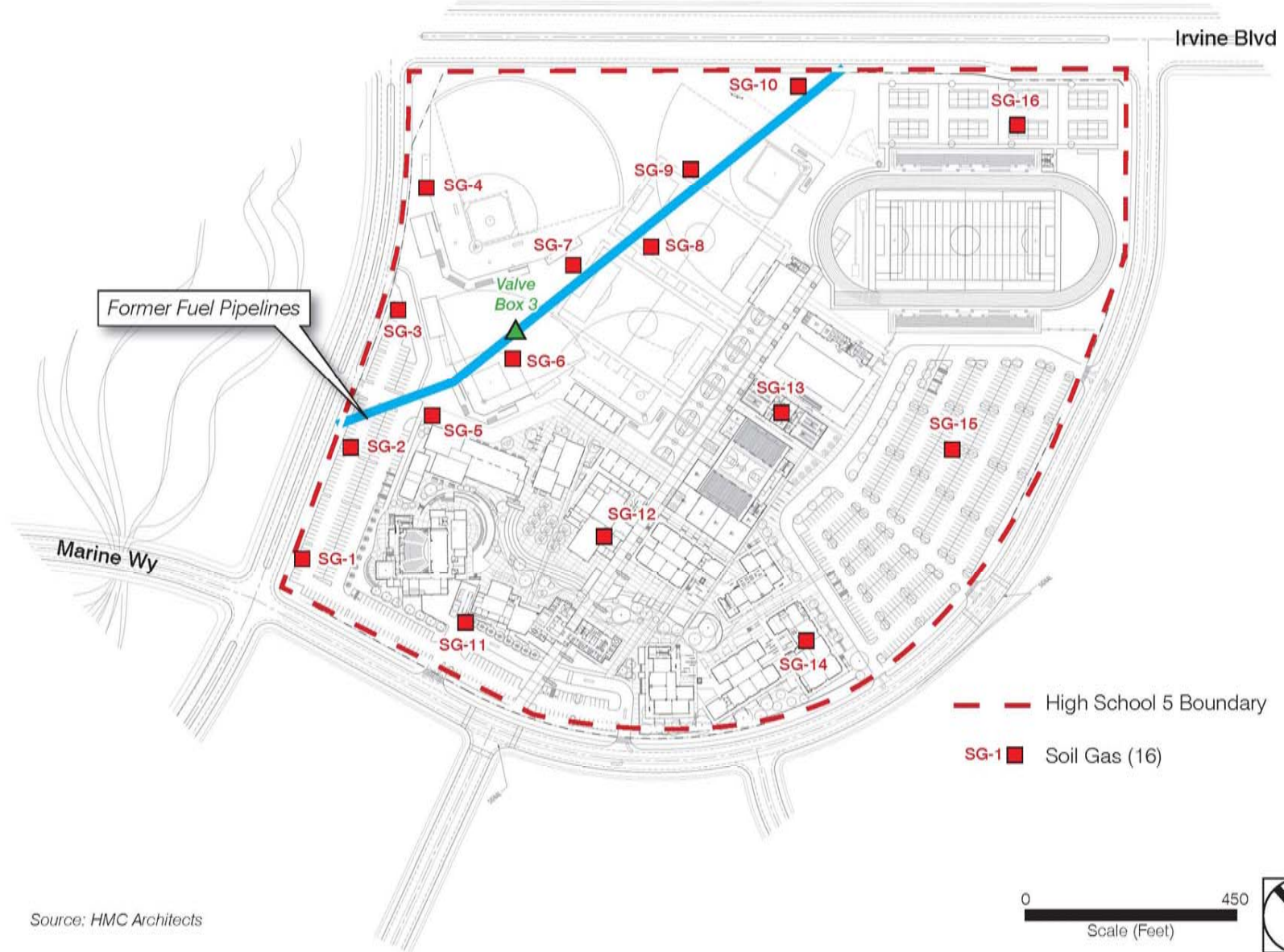



PEA Workplan - Soil Gas & Soil Sampling

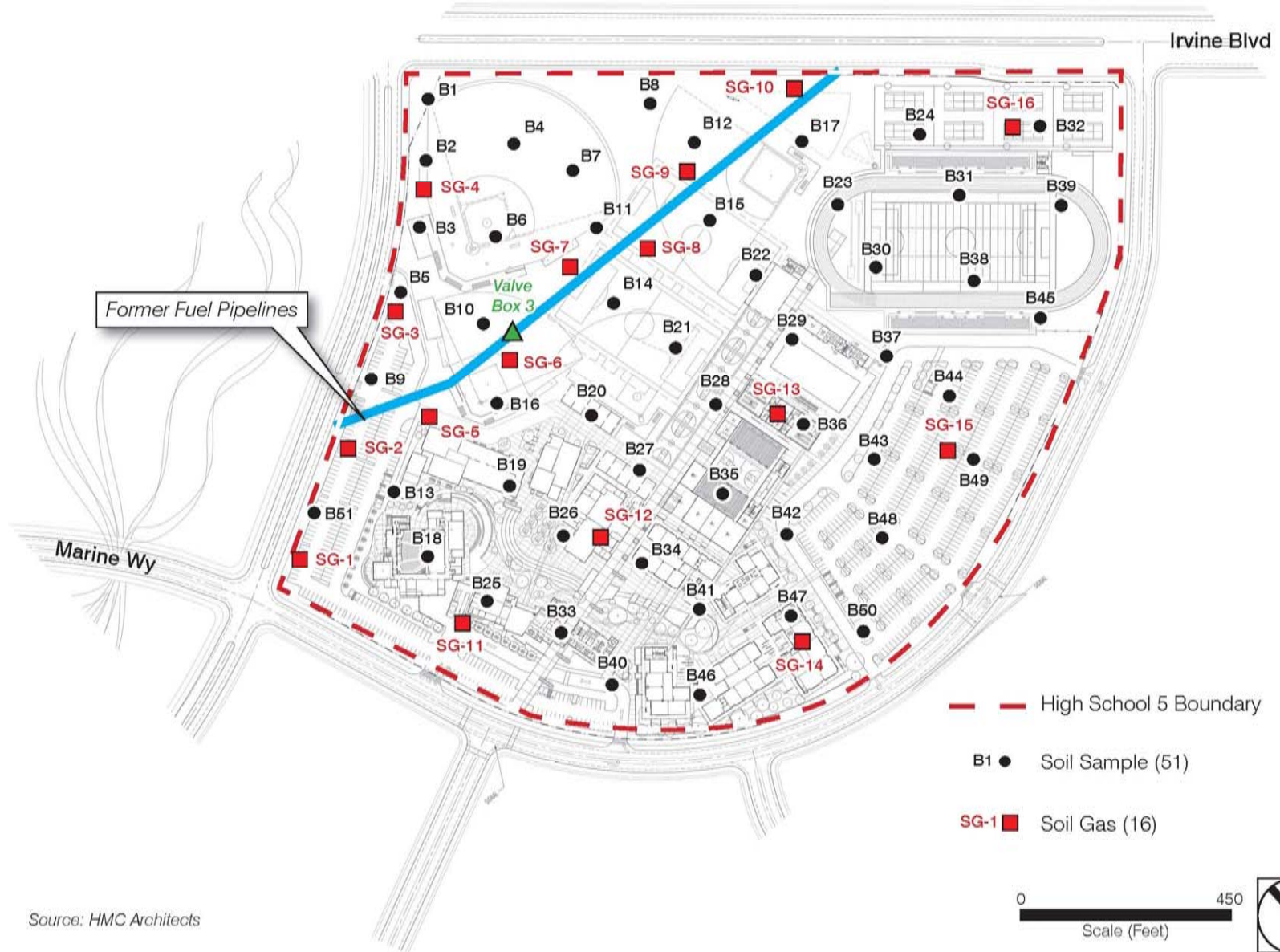

Source: HMC Architects



Environmental Approval

PEA Conclusions and Findings

- Insignificant levels of Eight (8) VOCs were detected in Soil Gas sampling
- Human health risk assessment indicated that there was not a significant risk to human health under an unrestricted residential land use scenario
- PEA concluded that no further assessment was needed and DTSC concurred in April 2014



Post Environmental Approval

Approval of Initial 40 Acres

- **April 15, 2014: CDE Site Approval**
- May 20, 2014: Irvine USD officially acquired site from Heritage Fields El Toro, LLC
- July 14, 2014: Portola High School Construction Commenced



Post Environmental Approval

Approval of Additional 3.53 Acres

- July 22, 2014: Supplemental Site Investigation (SSI) conducted and submitted to DTSC
- **July 29, 2014: DTSC Approval of SSI**
- **Oct. 24, 2014: CDE Site Approval**
- Dec. 23, 2014: Irvine USD officially acquired additional acres from Heritage Fields El Toro, LLC



SSI Soil Gas & Soil Sampling

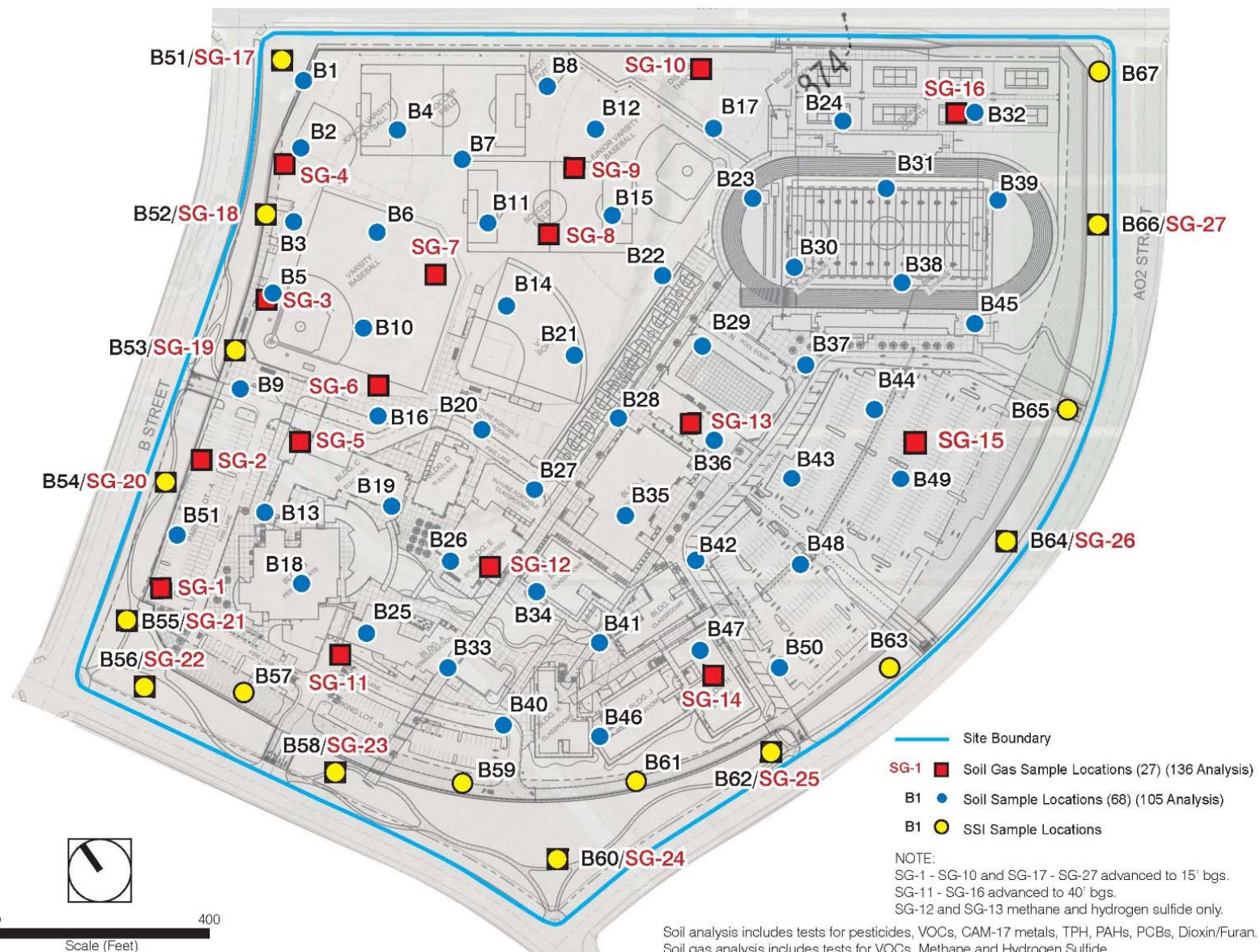



Post Environmental Approval

SSI Conclusion and Findings

- Insignificant levels of Ten (10) VOCs were detected in Soil Gas sampling
- Human health risk assessment indicated that there was not a significant risk to human health under an unrestricted residential land use scenario
- SSI concluded that no further assessment was needed and DTSC concurred in July 2014



Comprehensive Sampling of Site

Sampling Activities

- PEA & SSI Environmental Assessment
 - 190 Soil Gas and Soil Samples
 - 228 Analyses Performed
- Confirmation Sampling (*March – May 2016*)
 - 16 Soil Gas and 16 Soil Samples



Stained Soil

November 2014: Storm Drain Relocation

- Nov. 14, 2014: Nonhazardous stained soil found during storm drain excavation adjacent to school site
- Nov. 14, 2014: DTSC notified
- Nov. 17, 2014: Nonhazardous stained soil extended approximately 8 feet onto school site and approximately 16 to 20 feet below ground surface
- Nov. 2014 to Jan. 2015: Although nonhazardous stained soil did not pose a health risk and was not required to be removed, as a precaution, the stained soil was removed from site
- **Apr. 28, 2015: DTSC concurred with recommendation that no further assessment or testing is recommended**



Stained Soil

October 2015: Retaining Wall Soldier Piles

- Oct. 30, 2015: Nonhazardous stained soil found during auguring of soldier piles 64-67 (4 locations)
- Oct. 30, 2015: DTSC notified
- Nov. 2, 2015: Nonhazardous stained soil found during auguring of soldier piles 83-85 (3 locations)
- Dec. 29, 2015: Although nonhazardous stained soil did not pose a health risk and was not required to be removed, as a precaution, the stained soil was removed from site

Nonhazardous stained soil found in Seven (7) of 219 augured soldier piles

Stained Soil

CONFIRMATION SAMPLING
IRVINE UNIFIED PORTOLA HIGH SCHOOL

Figure 3 - Location of Storm Drain Easement

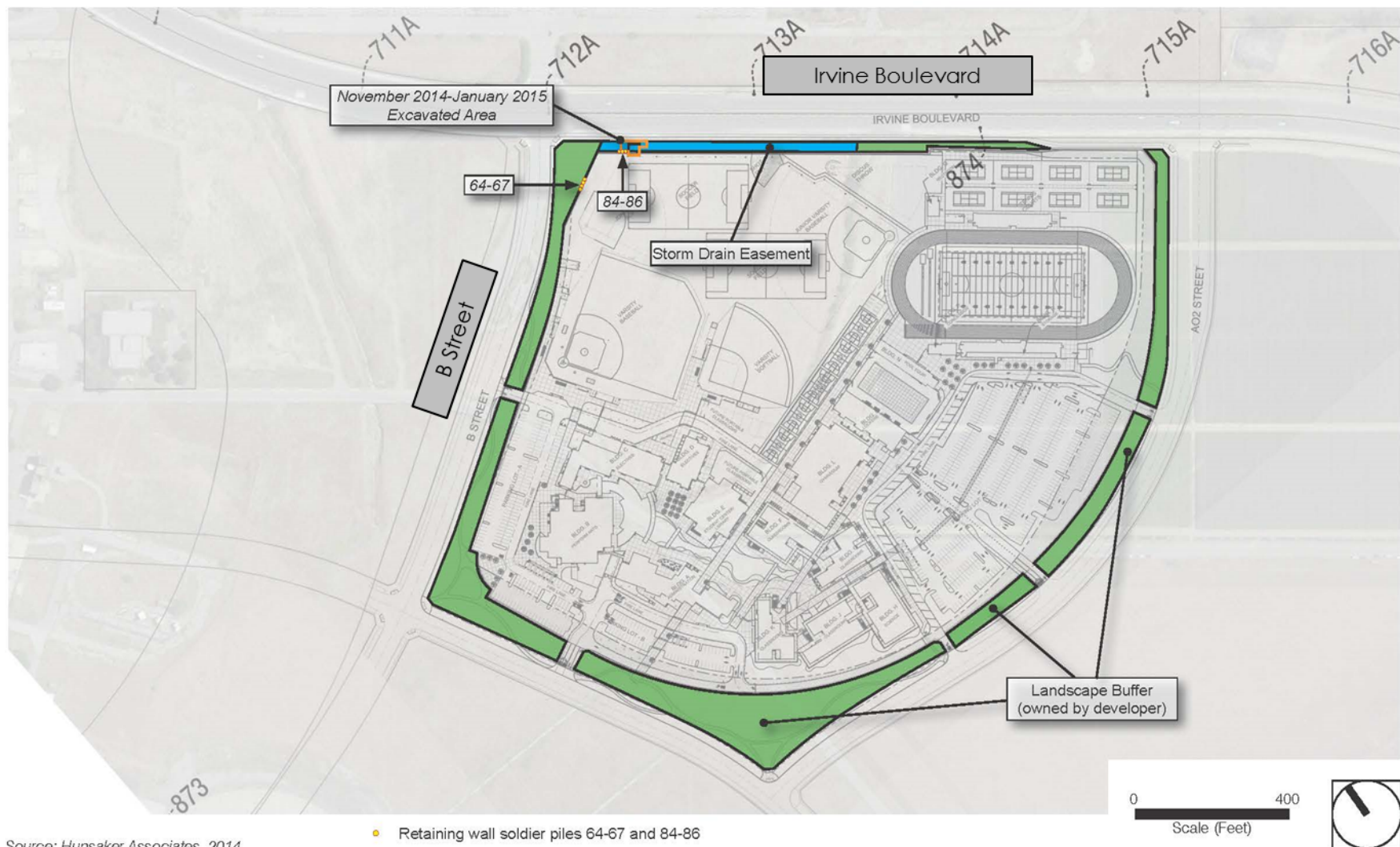



Stained Soil

Nonhazardous Stained Soil

- All stained soil was excavated and disposed of as nonhazardous soil
- Confirmation samples collected found stained soil was similar to what was found in storm drain installation
- Human health risk assessment indicated that there was not a significant risk to human health under an unrestricted residential land use scenario



DTSC Notification

DTSC Letter Dated March 2, 2016

- Authored by Barbara Lee
- Directing Irvine USD
 - Submit workplan for additional subsurface sampling
 - Proposed sampling activities should be discussed with DTSC, the public and other interested stakeholders, prior to the formal submittal of the workplan to the Department



DTSC Site Visit

Portola High School Visit - March 8, 2016

- Representatives from DTSC met with Irvine USD staff at the Portola High School site to identify potential confirmational sampling locations
- Eight (8) confirmational sampling locations were jointly identified
- Mutual Goal:
 - Identify additional confirmational sampling locations to reaffirm the environmental safety of the Portola High School site
 - Maintain construction schedule



Confirmational Sampling

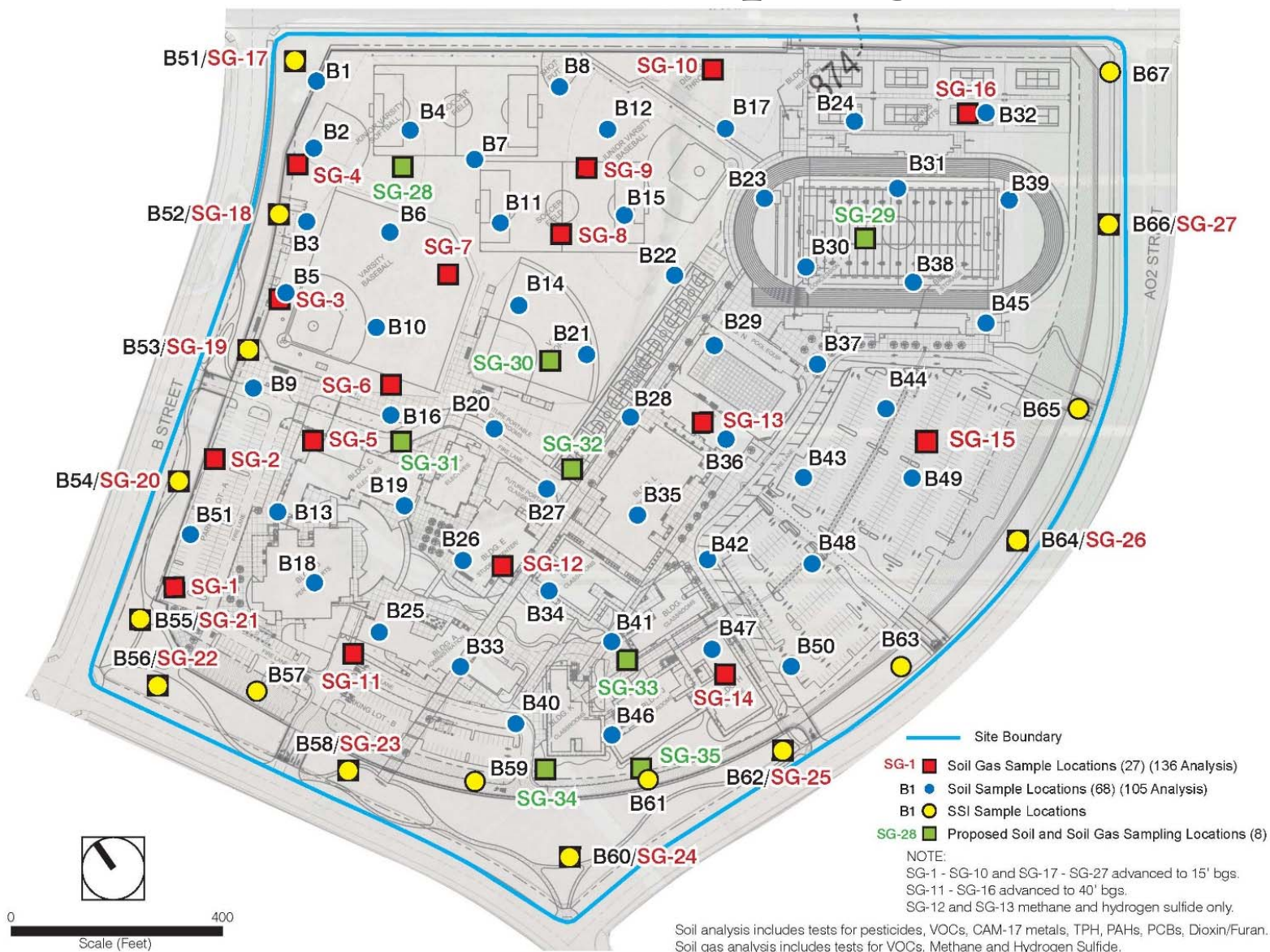



Confirmational Sampling Locations

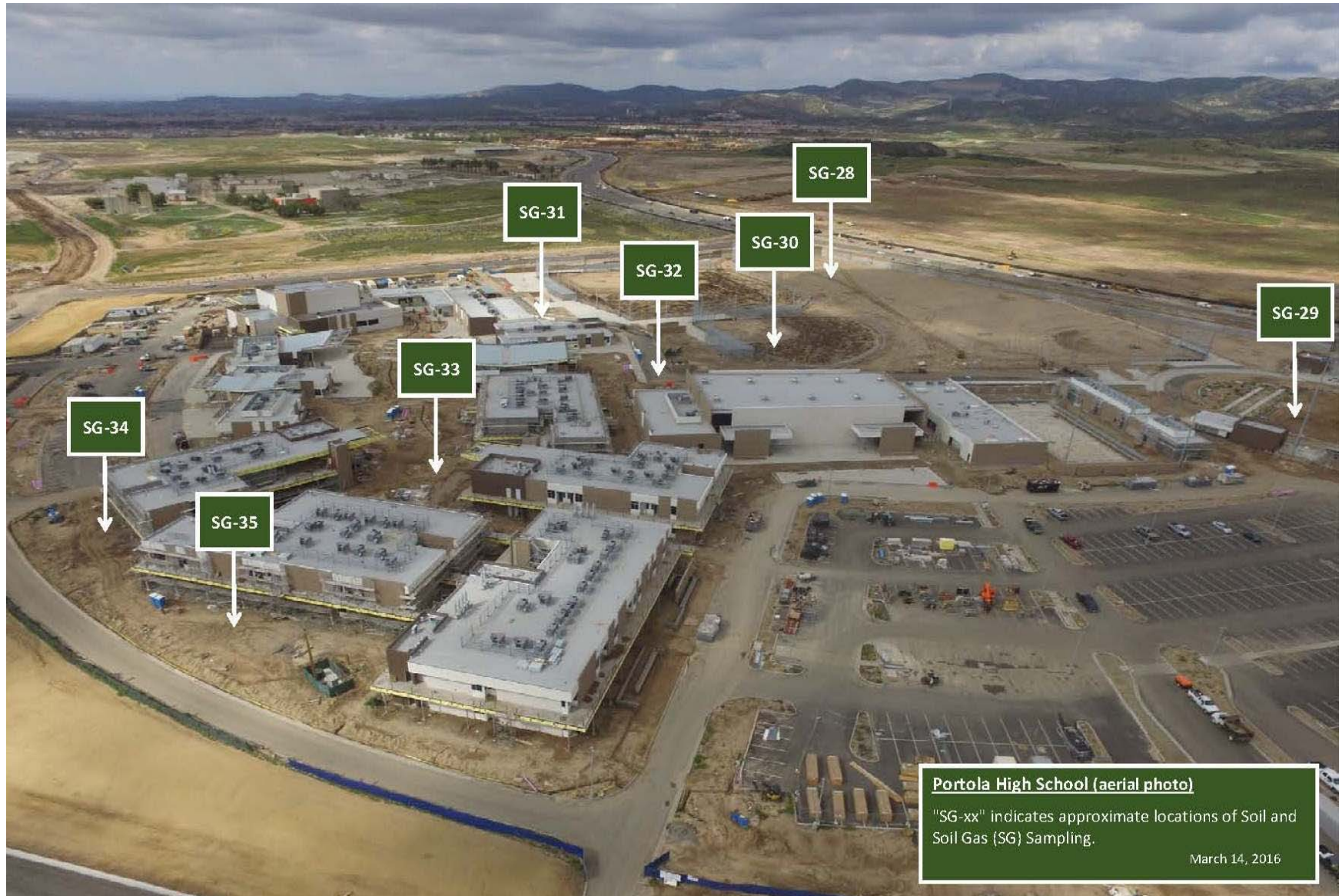



Remaining Schedule

- Mar. 11, 2016: Draft Workplan submitted to DTSC
- Mar. 22, 2016: Public Meeting
- Mar. 23, 2016: Irvine USD submits final Workplan
- Mar. 29, 2016: Sampling begins onsite
- Apr. 8, 2016: Sampling results to DTSC
- Apr. 22, 2016: IUSD submits Comprehensive Report to DTSC
- May 6, 2016: DTSC provides response
- **Aug. 26, 2016: First day of school for Portola High School Students**



Thank You

...