



IRVINE UNIFIED SCHOOL DISTRICT

ADDENDUM NO. 1

**KITCHEN EQUIPMENT & RELATED SUPPLIES
BID NO. 2017/2018-5FA**

DATE ISSUED: MARCH 14, 2018

This addendum forms a part of the contract and modifies the original bid documents. It is intended that all work affected by the following modifications shall conform to related provisions and general conditions of the contract, of the original bid documents. **Modify the following items wherever appearing in any portion of the bid documents.** Acknowledge receipt of Addendum No. 1 in the space provided on this form as well as on the bid form. Failure to do may subject bidder to disqualification.



The following revision and/or additions are hereby made:

I. Revised Bid Form (**Submit with bid**):

Correction made to the ADA Cashier Stand Cabinet dimensions (attached is the revised bid form and specifications for this unit).

II. Response to Request of Information (RFI's).
(District response in bold blue italic)

Q. Is prevailing wage required for install?

A. No. Vendor will not be responsible for installation, equipment purchased through this bid will be Owner Furnish Contractor Installed (related to construction projects) or Owner Furnished Owner Installed.

Q. Will performance or payment bonds be required?

A. No.

Q. On Page 15, Item 15: Could you please define “any required installation”? Do you want us to assemble and set in place? Or are we making final utility connections. This mainly pertains to the cooking equipment. Obviously there is a huge page grade difference for a plumber [gas connections] vs an assembler.

A. Vendor will be responsible for delivering fully assembled equipment, set-in place and final utility connections (if requested). Reference the District response for the first question.

Q. When you call out the actual school, are you planning to place the order for all the equipment listed for that school on the same P.O., for delivery on the same day? And will you be placing the orders for all the schools listed on the same day? Or different schools on different days throughout what period of time?



A. Yes, the purchase orders will be issued by the school sites identified in this bid and delivery of equipment will be required on the same day, starting with Westpark E.S. Vendor will be required to work closely with the Facilities Construction Supervisor. This order will be placed upon board approval and award of contract(s).

Remaining school sites listed on this bid, the purchase orders will be placed at a later date to be determined.

The awarded contract(s) will be effective from board approval date through June 30, 2019, as indicated in the bid documents.

Q. On Page 27, “Various Sites” is it your intention to place one P.O. for all the equipment on that page, for delivery on the same day? And will we need to deliver to the various sites or to a central warehouse? For example, you have listed 30 ea GA Systems items. Could you potentially cut 30 different PO’s for delivery on 30 different days to 30 different locations?

A. The intent of this bid (all items) is to be used District wide, equipment will be ordered upon request and will be delivered directly to the school site.

Q. Also on page 27, it says to reference attachment for complete specs. So are you referring to the spec sheets you attached? For instance on item 1 [convection oven] the spec sheet you attached does not call any accessories, like casters etc.

A. The descriptions noted under the “Various Sites” items (page 27), are identified correctly.

ALL OTHER PROVISIONS of the Bid Documents shall remain unchanged. This Addendum is hereby made a part of the Bid Documents to the same extent as those provisions contained in the original documents and all itemized listings thereof.

NOTE: The failure or omission of any bidder to receive or examine any bid document, forms, instrument, addendum, specifications, plans, or other documents shall by no means relieve any bidder from any obligation with respect to his bid or to the contract.

PLEASE SIGN AND RETURN ONE COPY OF THIS ADDENDUM WITH YOUR BID FORM.

Company Name

Signature

Print Name

Title



REVISED BID FORM

Bidder Name: _____
To: Irvine Unified School District, acting by and through the Governing Board herein, called the "District."

1. The undersigned bidder, having become familiarized with all the following documents including but not limited to the Notice Calling for Bids, Calendar of Events, Bid Form, Bid Form Pricing Sheet, Information for Bidders, Noncollusion Declaration, References, Certification of Primary Participant Regarding Debarment, Suspension & Other Related Matters, Certificate of Lobbying, Agreement, Tobacco Use Policy, Workers' Compensation Certificate, Drug-Free Workplace Certification, Criminal Records Check Certification, all insurance requirements, General Conditions, specifications, and all modifications, addenda and amendments, if any (hereinafter Bid Documents), the local conditions affecting the performance of the work and the cost of the work at the place where the work is to be done, hereby proposes and agrees to be bound by all the terms and conditions of the Bid Documents and agrees to perform, within the time stipulated, the work, including all of its component parts, and everything required to be performed, and to provide and furnish and pay for any and all of the labor, materials, supplies, tools, equipment, and all applicable taxes, utility and transportation services necessary to perform the work and complete in a good workmanlike manner all of the work required in accordance with laws, codes, regulations, ordinances and any other legal requirements governing the work, in connection with the following:

**Kitchen Equipment & Related Supplies
Bid No. 2017/2018-5FA**

All in strict conformity with the Bid Documents, including Addenda Nos. _____, _____, _____, on file at the Purchasing Dept. of the Irvine Unified School District for the sums as set forth in this Bid Form.

2. It is understood that the District reserves the right to reject any or all bids or to waive any irregularities or informalities in any bids or in the bidding process. Bidder agrees that this bid shall remain open and not be withdrawn for the period specified in the Information for Bidders.

3. The initial term of the Agreement is through June 30, 2019. Term of the Agreement may be extended upon mutual consent of District and successful bidder(s) for an additional two (2) one (1) year periods in accordance with provisions contained in the Education Code section 17596 (K-12). The maximum term of the Agreement is three (3) years.

4. It is understood and agreed that if written notice of the award of a contract is mailed, faxed, or delivered to the bidder, the bidder will execute and deliver to the **Irvine Unified School District** the Agreement and will also furnish and deliver to the **Irvine Unified School District** certificates and endorsements of insurance, the Workers' Compensation Certificate, Tobacco Use Policy, Drug-Free Work Place Certification, and the Criminal Records Check Certification, within five (5) working days of the notice of award of the contract.



5. Communication conveying notice of award of the contract, requests for additional information or other correspondence should be addressed to the bidder stated below in Section 6.

6. The name(s) of all persons interested in the bid as principals are as follows:

Name	Address	Phone/ Email
_____	_____	_____
_____	_____	_____
_____	_____	_____

7. The bidder hereby warrants that the bidder has all appropriate licenses and permits to perform the work as specified in the bid documents and that such licenses and permits will be in force and effect throughout the Agreement.

8. The bidder, whether manufacturer, supplier, distributor or retailer, hereby certifies that the products offered under this bid have been placed in regular commercial use for a period of at least three (3) years and that adequate spare parts exist in the marketplace for the items sold.

9. In submitting this bid, the bidder offers and agrees that if the bid is accepted, it will assign to the DISTRICT all rights, title and interest in and to all causes of action it may have under Section 4 of the Clayton Act (15 U.S.C. Section 15) or under the Cartwright Act (Business & Professions Code Section 16700, et seq.) arising from purchases of goods, materials, or services by the bidder for sale to the DISTRICT pursuant to the bid. Such assignment shall be made and become effective at the time the DISTRICT tenders final payment under the contract. (Public Contract Code Section 7103.5; Government Code Section 4450, 4451 and 4552).

10. The bidder hereby certifies that it is, and at all times during the performance of work hereunder shall be, in full compliance with the provisions of the Immigration Reform and Control Act of 1986 ("IRCA") in the hiring of its employees, and the bidder shall indemnify, hold harmless and defend the DISTRICT against any and all actions, proceedings, penalties or claims arising out of the bidder's failure to comply strictly with the IRCA.

11. It is understood and agreed that if requested by the DISTRICT, the bidder shall furnish a notarized financial statement, references, and other information required by the DISTRICT that is sufficiently comprehensive to permit an appraisal of bidder's ability to perform the work.

12. **Time is of the essence.**

13. The required Noncollusion Declaration is attached as required by Public Contract Code Section 7106. Bidder understands and agrees that failure to submit a completed and signed declaration will render the bidder automatically nonresponsive.

14. Failure to complete the Bid Form and Bid Form Pricing Sheet in its entirety will render a bidder nonresponsive.

15. **Bid prices are to include shipping, F.O.B. Irvine Unified School District, assembly, inside delivery, and any required installation.**



Bidder Firm Name: _____

KITCHEN EQUIPMENT & RELATED SUPPLIES**REVISED BID FORM PRICING SHEET*****Please indicate "NO BID" in the pricing column if not bidding on the item*****BRYWOOD E.S.: *Reference Specifications attachment for complete item description***

Equip. Line #	Description*	Manufacturer & Model No.	or Equal Manufacturer & Model No.	Est. Qty	Unit Cost	Extended Price	Mfg. Lead Time (Weeks)
9	<p>Dry Storage Shelving; Four (4) units of 4-tier, wire-type mobile storage shelving with NSF approved finish. Verify size & quantity with field conditions.</p> <p>Consists of:</p> <ul style="list-style-type: none"> - 4 each - Model 1830 NC Super Erecta Shelf - 8 each – Model 1842NC Super Erecta Shelf - 4 each – Model 1848NC Super Erecta Shelf - 16 each – Model 63UP Super Erecta Post - 16 each – Model 5MB Super Erecta Stem Caster, Brake (foot operated) 	Metro		1			
13	<p>Shelving, Walk-Ins; Five (5) units of 4-tier, plastic-type, mobile storage shelving with NSF approved finish. Verify size & quantity with field conditions. Consists of:</p> <ul style="list-style-type: none"> - 3 each – Model EMU184270V4580 Camshelving Elements Mobile Starter Unit - 1 each – Model EMU185470V4580 Camshelving Elements Mobile Starter Unit - 1 each – Model EMU186070V4580 Camshelving Elements Mobile Starter Unit 	Cambro		1			
17	<p>Pot Storage Shelving; Two (2) units of 4-tier, plastic-type, mobile storage shelving with NSF approved finish. Verify size and quantity with field conditions.</p> <p>Consists of:</p> <ul style="list-style-type: none"> - 2 each – Model EMU183670V4580 Camshelving Elements Mobile Starter Unit 	Cambro		1			



Bidder Firm Name: _____

KITCHEN EQUIPMENT & RELATED SUPPLIES**REVISED BID FORM PRICING SHEET*****Please indicate "NO BID" in the pricing column if not bidding on the item*****BRYWOOD E.S (cont.): *Reference Specifications attachment for complete item description***

Equip. Line #	Description*	Manufacturer & Model No.	or Equal Manufacturer & Model No.	Est. Qty	Unit Cost	Extended Price	Mfg. Lead Time (Weeks)
20	Microwave; Sonic Steamer Microwave Oven, 3200 Watts, 1.6 cu. ft. capacity, connectionless, rethermalizer, removable shelf, 8 programmable memory pads, dial timer, 5 power levels, 4 heating elements, digital display, see-thru drop down door, stainless steel cabinet & cavity, UL, NSF. Consists of: - 1 each – 208v/60/1-ph, 20.0 amps, NEMA 6-30P, Standard	Panasonic Model NE-3280		1			
40	Convection Oven, Electric; Zephair Convection Oven, electric, double deck, bakery depth, capacity (5) 18" x 26" pans per compartment, (SSI-D) solid state infinite controls with digital timer, two speed fan, vent connector, dependent glass doors, interior light, stainless steel front, sides and top, 6" stainless steel legs, ETL, CE, NSF, Energy Star. Consists of: - 2 each – 208v/60/3-ph 11.0 Kw, 31.0 AMPS, direct, ½ hp (per deck), standard - 1 each – Model SSI-D Top Oven: Solid state infinite with digital timer, standard - 1 each – Model SS-D Bottom Oven: Solid State infinite with digital timer, standard - 1 set – 4" low profile plate casters (set)	Blodgett ZEPH-200-E DBL		1			
45	ADA Cashier Stand; Speedline D3A ADA Cash Stand Cabinet, 31 1/8" L x 34 3/8" W x 34" H 31-1/8" L X 36-3/8" W X 34" H . Plate-type casters with 3" swivel non-marking wheels with brakes all, NSF approved. Consist of: - 1 each – Exterior finish: Stainless Steel	G.A. Systems Inc. D3A		1			
51	Lid Cart; Lid Storage Cart to hold (8) lids from 30-3/8" wide speedline cabinets	G.A. Systems Inc. LC30		1			



Bidder Firm Name: _____

KITCHEN EQUIPMENT & RELATED SUPPLIES**REVISED BID FORM PRICING SHEET*****Please indicate "NO BID" in the pricing column if not bidding on the item*****MEADOW PARK E.S: *Reference Specifications attachment for complete item description***

Equip. Line #	Description	Manufacturer & Model No.	or Equal Manufacturer & Model No.	Est. Qty	Unit Cost	Extended Price	Mfg. Lead Time (Weeks)
8	<p>Dry Storage Shelving; Three (3) units of 4-tier, wire-type, mobile storage shelving with NSF approved casters and finish. Verify size and quantity with field conditions.</p> <p>Consists of:</p> <ul style="list-style-type: none"> - 12 each – Model 1842NC Super Erecta Shelf - 12 each – Model 63UP Super Erecta Post - 12 each – Model 5MB Super Erecta Stem Caster, brake (foot operated) 	Metro		1			
8.1	<p>Shelving, Pot/Pan Storage; One (1) unit of 4-tier, plastic-type, mobile storage shelving with NSF approved finish. Verify size and quantity with field conditions.</p> <p>Consists of:</p> <ul style="list-style-type: none"> - 1 each - Model EMU183670V4580 Camshelving Elements Mobile Starter Unit 	Cambro		1			
15	<p>Shelving, Walk-Ins; Four (4) units of 4-tier, plastic-type, mobile storage shelving with NSF approved finish. Verify size & quantity with field conditions.</p> <p>Consists of:</p> <ul style="list-style-type: none"> - 3 each – Model EMU183670V4580 Camshelving Elements Mobile Starter Unit - 1 each – Model EMU184870V4580 Camshelving Elements Mobile Starter Unit 	Cambro		1			



Bidder Firm Name: _____

KITCHEN EQUIPMENT & RELATED SUPPLIES

REVISED BID FORM PRICING SHEET

Please indicate "NO BID" in the pricing column if not bidding on the item

MEADOW PARK E.S (cont.): *Reference Specifications attachment for complete item description*

Equip. Line #	Description	Manufacturer & Model No.	or Equal Manufacturer & Model No.	Est. Qty	Unit Cost	Extended Price	Mfg. Lead Time (Weeks)
30	<p>Microwave; Sonic Steamer Microwave Oven, 3200 Watts, 1.6 cu. Ft. capacity, connectionless, rethermalizer, removable shelf, 8 programmable memory pads, dial timer, 5 power levels, 4 heating elements, digital display, see-thru drop down door, stainless steel cabinet & cavity, UL, NSF.</p> <p>Consist of:</p> <ul style="list-style-type: none"> - 1 each – 208v/60/1-ph, 20.0 amps, NEMA 6-30P, standard 	Panasonic NE-3280		1			
44	<p>Convection Oven, Electric; Zephair Convection Oven, electric, double deck, bakery depth, capacity (5) 18" x 26" pans per compartment, (SSI-D) solid state infinite controls with digital timer, two speed fan, vent connector, dependent glass doors, interior light, stainless steel front, sides and top, 6" stainless steel legs, ETL, CE, NSF, Energy Star.</p> <p>Consists of:</p> <ul style="list-style-type: none"> - 2 each – 208v/60/3-ph 11.0 Kw, 31.0 AMPS, direct, ½ hp (per deck), standard - 1 each – Model SSI-D Top Oven: Solid state infinite with digital timer, standard - 1 each – Model SS-D Bottom Oven: Solid State infinite with digital timer, standard - 1 set – 4" low profile plate casters (set) - Note: DO NOT deduct cost of standard legs 	Blodgett ZEPH-200-E DBL		1			



Bidder Firm Name: _____

KITCHEN EQUIPMENT & RELATED SUPPLIES**REVISED BID FORM PRICING SHEET*****Please indicate "NO BID" in the pricing column if not bidding on the item*****MEADOW PARK E.S (cont.): *Reference Specifications attachment for complete item description***

Equip. Line #	Description	Manufacturer & Model No.	or Equal Manufacturer & Model No.	Est. Qty	Unit Cost	Extended Price	Mfg. Lead Time (Weeks)
49	ADA Cashier Stand; Speedline D3A ADA Cash Stand Cabinet, 31-1/8"L x 34-3/8"W x 34"H 31-1/8"L X 36-3/8"W X 34"H . Plate-type casters with 3" swivel non-marking wheels with brakes all, NSF approved. Consist of: - 1 each – Exterior finish: Stainless Steel	G.A. Systems D3A		1			
56	Lid Cart; Lid Storage Cart to hold (8) lids from 30-3/8" wide speedline cabinets.	G.A. Systems LC30		1			



Bidder Firm Name: _____

KITCHEN EQUIPMENT & RELATED SUPPLIES

REVISED BID FORM PRICING SHEET

Please indicate "NO BID" in the pricing column if not bidding on the item

SPRINGBROOK E.S: *Reference Specifications attachment for complete item description*

Equip. Line #	Description	Manufacturer & Model No.	or Equal Manufacturer & Model No.	Est. Qty	Unit Cost	Extended Price	Mfg. Lead Time (Weeks)
9	<p>Dry Storage Shelving; Five (5) units of 4-tier, wire-type, mobile storage shelving with NSF approved finish. Verify size and quantity with field conditions. Consists of:</p> <ul style="list-style-type: none"> - 16 each – Model 1836NC Super Erecta Shelf - 4 each – Model 1848NC Super Erecta Shelf - 20 each – Model 63UP Super Erecta Post - 20 each – Model 5MB Super Erecta Stem Caster, Brake (foot operated) 	Metro		1			
13	<p>Shelving, Walk-Ins; Five (5) units of 4-tier, plastic-type, mobile storage shelving with NSF approved finish. Verify size and field conditions. Consists of:</p> <ul style="list-style-type: none"> - 1 each – Model EMU183670V4580 Camshelving Elements Mobile Starter Unit - 2 each – Model EMU185470V4580 Camshelving Elements Mobile Starter Unit - 2 each – Model EMU186070V4580 Camshelving Elements Mobile Starter Unit 	Cambro		1			



Bidder Firm Name: _____

KITCHEN EQUIPMENT & RELATED SUPPLIES**REVISED BID FORM PRICING SHEET*****Please indicate "NO BID" in the pricing column if not bidding on the item*****SPRINGBROOK E.S (cont.): *Reference Specifications attachment for complete item description***

Equip. Line #	Description	Manufacturer & Model No.	or Equal Manufacturer & Model No.	Est. Qty	Unit Cost	Extended Price	Mfg. Lead Time (Weeks)
30	<p>Microwave; Sonic Steamer Microwave Oven, 3200 Watts, 1.6 cu. ft. capacity, connectionless, rethermalizer, removable shelf, 8 programmable memory pads, dial timer, 5 power levels, 4 heating elements, digital display, see-thru drop down door, stainless steel cabinet & cavity, UL, NSF.</p> <p>Consists of:</p> <ul style="list-style-type: none"> - 1 each – 208v/60/1-ph, 20.0 amps, NEMA 6-30P, Standard 	Panasonic Model NE-3280		1			
43	<p>Convection Oven, Double-Deck, Electric; Zephaire Convection Oven, electric, double-deck, bakery depth, capacity (5) 18"x 26" pans per compartment, (SSI-D) solid state infinite controls with digital timer, two speed fan, vent connector, dependent glass doors, interior light, stainless steel front, sides and top, 6" stainless steel legs, ETL, CE, NSF, Energy Star.</p> <p>Consists of:</p> <ul style="list-style-type: none"> - 2 each – 208v/60/1-ph, 11.0 Kw, 51.0 amps, direct, ½ hp (per deck) - 1 each – Model SSI-D Top Oven: Solid State infinite with digital timer, standard. - 1 each – Model SSI-D Bottom Oven: Solid State infinite with digital timer, standard. - 1 set – 4" low profile plate casters (set) 	Blodgett Oven Model ZEPH-200-E-DBL		1			



Bidder Firm Name: _____

KITCHEN EQUIPMENT & RELATED SUPPLIES**REVISED BID FORM PRICING SHEET*****Please indicate "NO BID" in the pricing column if not bidding on the item*****SPRINGBROOK E.S (cont.): *Reference Specifications attachment for complete item description***

Equip. Line #	Description	Manufacturer & Model No.	or Equal Manufacturer & Model No.	Est. Qty	Unit Cost	Extended Price	Mfg. Lead Time (Weeks)
48	<p>ADA Cashier Stand; CUSTOM – Speedline D3A ADA Cash Stand Cabinet, 31-1/8"L x 28-3/8"W x 34"H 36-3/8" Wide X 28-3/8" Deep X 34"H. Plate-type casters with 3" swivel non-marking wheels with brakes all, NSF approved. Consists of:</p> <ul style="list-style-type: none"> - 1 each – Exterior Finish: Stainless Steel <p>Note: Unit to be manufactured with 28-3/8" overall cabinet depth (front to back), Maximum.</p>	G.A. Systems Model D3A CUSTOM		1			
55	Lid Cart; Lid Storage Cart to hold (8) lids from 30-3/8" wide speedline cabinets.	G.A. Systems Model LC30		1			



Bidder Firm Name: _____

KITCHEN EQUIPMENT & RELATED SUPPLIES
REVISED BID FORM PRICING SHEET

Please indicate “NO BID” in the pricing column if not bidding on the item

WESTPARK E.S: *Reference Specifications attachment for complete item description*

Equip. Line #	Description	Manufacturer & Model No.	or Equal Manufacturer & Model No.	Est. Qty	Unit Cost	Extended Price	Mfg. Lead Time (Weeks)
9	<p>Dry Storage Shelving; Three (3) units of 4-tier, wire-type, storage shelving with NSF approved finish. Verify size and quantity with field conditions. Consists of:</p> <ul style="list-style-type: none"> - 8 each – Model 1842NC Super Erecta Shelf - 4 each – Model 1860NC Super Erecta Shelf - 16 each – Model 63UP Super Erecta Post - 16 each – Model 5MB Super Erecta Stem Caster, brake (foot operated) 	Metro		1			
13	<p>Shelving, Walk-Ins; Five (5) units of 4-tier, plastic type, mobile storage shelving with NSF approved finish. Verify size and quantity with field conditions. Consists of:</p> <ul style="list-style-type: none"> - 1 each – Model EMU183670V4580 Camshelving Elements Mobile Starter Unit - 3 each – Model EMU185470V4580 Camshelving Elements Mobile Starter Unit - 1 each – Model EMU186070V4580 Camshelving Elements Mobile Starter Unit 	Cambro		1			
23	<p>Pot Storage Shelving; One (1) unit of 4-tier, plastic-type, mobile storage shelving with NSF approved finish. Verify size and quantity with field conditions. Consists of:</p> <ul style="list-style-type: none"> - 1 each – Model ESU243672V4580 Camshelving Elements Starter Unit 	Cambro		1			



Bidder Firm Name: _____

KITCHEN EQUIPMENT & RELATED SUPPLIES
REVISED BID FORM PRICING SHEET

Please indicate "NO BID" in the pricing column if not bidding on the item

WESTPARK E.S (cont.): *Reference Specifications attachment for complete item description*

Equip. Line #	Description	Manufacturer & Model No.	or Equal Manufacturer & Model No.	Est. Qty	Unit Cost	Extended Price	Mfg. Lead Time (Weeks)
30	<p>Microwave; Sonic Steamer Microwave Oven, 3200 Watts, 1.6 cu. ft. capacity, connectionless, rethermalizer, removable shelf, 8 programmable memory pads, dial timer, 5 power levels, 4 heating elements, digital display, see-thru drop down door, stainless steel cabinet & cavity, UL, NSF.</p> <p>Consists of:</p> <ul style="list-style-type: none"> - 1 each – 208v/60/1-ph, 20.0 amps, NEMA 6-30P, Standard 	Panasonic Model NE-3280		1			
43	<p>Convection Oven, Double-Deck, Electric; Zephair Convection Oven, electric, double-deck, bakery depth, capacity (5) 18"x 26" pans per compartment, (SSI-D) solid state infinite controls with digital timer, two speed fan, vent connector, dependent glass doors, interior light, stainless steel front, sides and top, 6" stainless steel legs, ETL, CE, NSF, Energy Star. Consists of:</p> <ul style="list-style-type: none"> - 2 each – 208v/60/1-ph, 11.0 Kw, 51.0 amps, direct, ½ hp (per deck) - 1 each – Model SSI-D Top Oven: Solid State infinite with digital timer, standard. - 1 each – Model SSI-D Bottom Oven: Solid State infinite with digital timer, standard. - 1 set – 4" low profile plate casters (set) 	Blodgett Oven Model ZEPH-200-E-DBL		1			



Bidder Firm Name: _____

KITCHEN EQUIPMENT & RELATED SUPPLIES
REVISED BID FORM PRICING SHEET

Please indicate "NO BID" in the pricing column if not bidding on the item

WESTPARK E.S (cont.): *Reference Specifications attachment for complete item description*

Equip. Line #	Description	Manufacturer & Model No.	or Equal Manufacturer & Model No.	Est. Qty	Unit Cost	Extended Price	Mfg. Lead Time (Weeks)
48	ADA Cashier Stand; Speedline D3A ADA Cash Stand Cabinet, 31-1/8"L x 34-3/8"W x 34"H 31-1/8"L X 36-3/8"W X 34"H . Plate-type casters with 3" swivel non-marking wheels with brakes all, NSF approved. Consists of: - 1 each – Exterior Finish: Stainless Steel	G.A. Systems Model D3A		1			
55	Lid Cart; Lid Storage Cart to hold (8) lids from 30-3/8" wide speedline cabinets.	G.A. Systems Model LC30		1			



Bidder Firm Name: _____

KITCHEN EQUIPMENT & RELATED SUPPLIES

REVISED BID FORM PRICING SHEET

Please indicate "NO BID" in the pricing column if not bidding on the item

Various Sites: *Reference Specifications attachment for complete item description*

Bid. Line #	Description	Manufacturer & Model No.	or Equal Manufacturer & Model No.	Est. Qty	Unit Cost	Extended Price	Mfg. Lead Time (Weeks)
1	Double Deck, Full-Size Gas Convection Oven, 115,000 BTU	Montague Vectaire 2-115A		3			
2	Speedline Cashier Stand Cabinet	G.A. Systems D3		5			
3	Speedline Cashier Stand Cabinet	G.A. Systems D319		5			
4	Speedline Cashier Stand Cabinet	G.A. Systems ED3		5			
5	Cart Lid Storage Unit	G.A. Systems LC 30		5			
6	Freezer Cabinet	G.A. Systems F3		10			
7	Commercial Microwave Oven (Sonic Steamer), 3200 Watt	Panasonic NE-3280		6			
8	Two-Speed Table Top Can Opener	Edlund 270		5			

NON-SPECIFIED ITEMS

CATALOG PERCENTAGE DISCOUNT: Percentage Discount off list price for Non-Specified and Misc. Items not identified on bid form pricing sheet

Please indicate "NO BID" in the percentage column if not bidding on the item

9	Other Blodgett: Non-Specified Items	_____ % Catalog Discount
10	Other Cambro: Non-Specified Items	_____ % Catalog Discount
11	Other Edlund: Non-Specified Items	_____ % Catalog Discount
12	Other G.A. Systems: Non-Specified Items	_____ % Catalog Discount
13	Other Metro: Non-Specified Items	_____ % Catalog Discount
14	Other Montague Vectaire: Non-Specified Items	_____ % Catalog Discount
16	Submitting Vendor Catalog If Not Specified Above	_____ % Catalog Discount



The undersigned hereby declares that all of the representatives of this bid are made under penalty of perjury under the laws of the State of California.

Individual Name: _____
Signed by: _____
Print Name: _____
Date: _____
Business Address: _____
Telephone: _____

Partnership Name: _____
Signed by: _____
Print Name: _____
Date: _____
Business Address: _____
Telephone: _____
Other Partner(s): _____

Corporation Name: _____
(a _____ Corporation¹)
Business Address: _____
Telephone _____
Signed by: _____, President Date: _____
Print Name: _____, President Date: _____
Signed by: _____, Secretary Date: _____
Print Name: _____, Secretary Date: _____

¹A corporation awarded the contract shall furnish evidence of its corporate existence and evidence that the officer signing the Agreement and bonds is duly authorized to do so.



Joint Venturer Name: _____
 Signed by: _____
 Print Name: _____
 Date: _____
 Business Address: _____
 Telephone: _____

Other Parties to Joint Venturer *If an individual* Name: _____
 Signed by: _____
 Print Name: _____
 Date: _____
 Doing Business as: _____
 Business Address: _____
 Telephone: _____

If a Partnership Name: _____
 Signed by: _____
 Print Name: _____
 Date: _____
 Business Address: _____
 Telephone: _____

If a Corporation Name: _____
 (a _____ Corporation)
 Signed by: _____
 Print Name: _____
 Title: _____
 Date: _____
 Business Address: _____
 Telephone: _____



Specializing in Cafeteria Serving Lines

G.A. SYSTEMS, Inc.

Speedline ADA Cashier Stand Cabinet



Model D3A shown.

Project: _____
 Item #: _____
 Model #: _____

Speedline Cashier Stand Cabinets allow for ease of placement of cash registers and their attendees. Exterior options include high pressure laminate, stainless steel, powder coated, graphics and more.

SPECIFICATIONS

Top is 16 gauge 304 stainless steel #4 finish bound with (4) 10/32 stainless steel screws flush at each end. No exposed screws on the front or back of cabinet. Front and back edges turned down 102 degrees for sleek aesthetics. Corners at precisely 90 degrees for flush alignment to other cabinets. One locking pin to adjoin other G.A. Systems units.

Body of cabinet is 20 gauge galvanized trimmed with 20 gauge stainless steel back and end panels. Tubular 1-1/2" square stainless steel tubing frames the cabinet's structure to join the front, back and end panels. Top frame is 1" square cold rolled tubing, bottom frame constructed from 1" square stainless steel tubing.

Front, back and ends trimmed with 22 gauge stainless steel #4 finish trim to accept interchangeable color panels. All NSF approved high pressure laminates are available as well as stainless steel or powder coated finish.

There is a 3.75" clearance from the bottom of the cabinet to the floor.

Plate type 3" swivel non-marking casters with brakes.

Consider dimensions +2" on each side for door and pathway clearance.

ACCESSORIES

- Tray Slide (stainless steel or solid surface material)
- Condiment Inserts



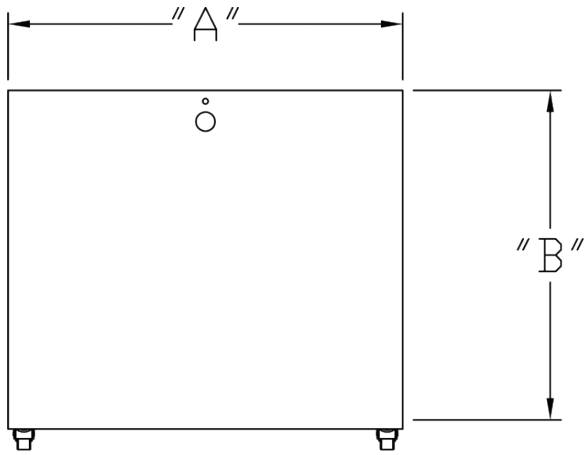

TOP VIEW

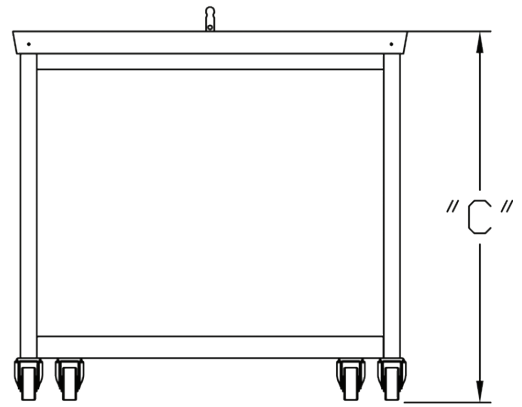

END VIEW

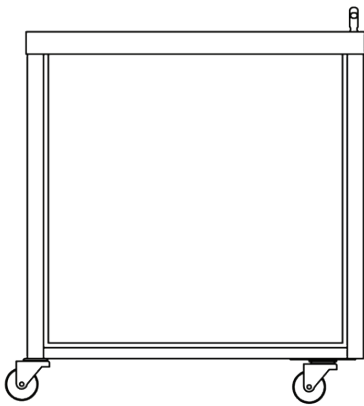

BACK VIEW

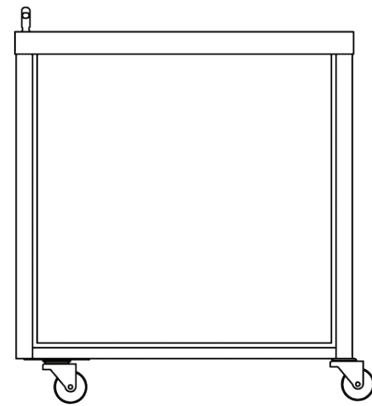

FRONT VIEW

MODEL	A	B	C
D3A	36-3/8"	31-1/8"	34"

*custom sizes available